

L.G.A. : INNER WEST  
PARISH : PETERSHAM  
COUNTY : CUMBERLAND

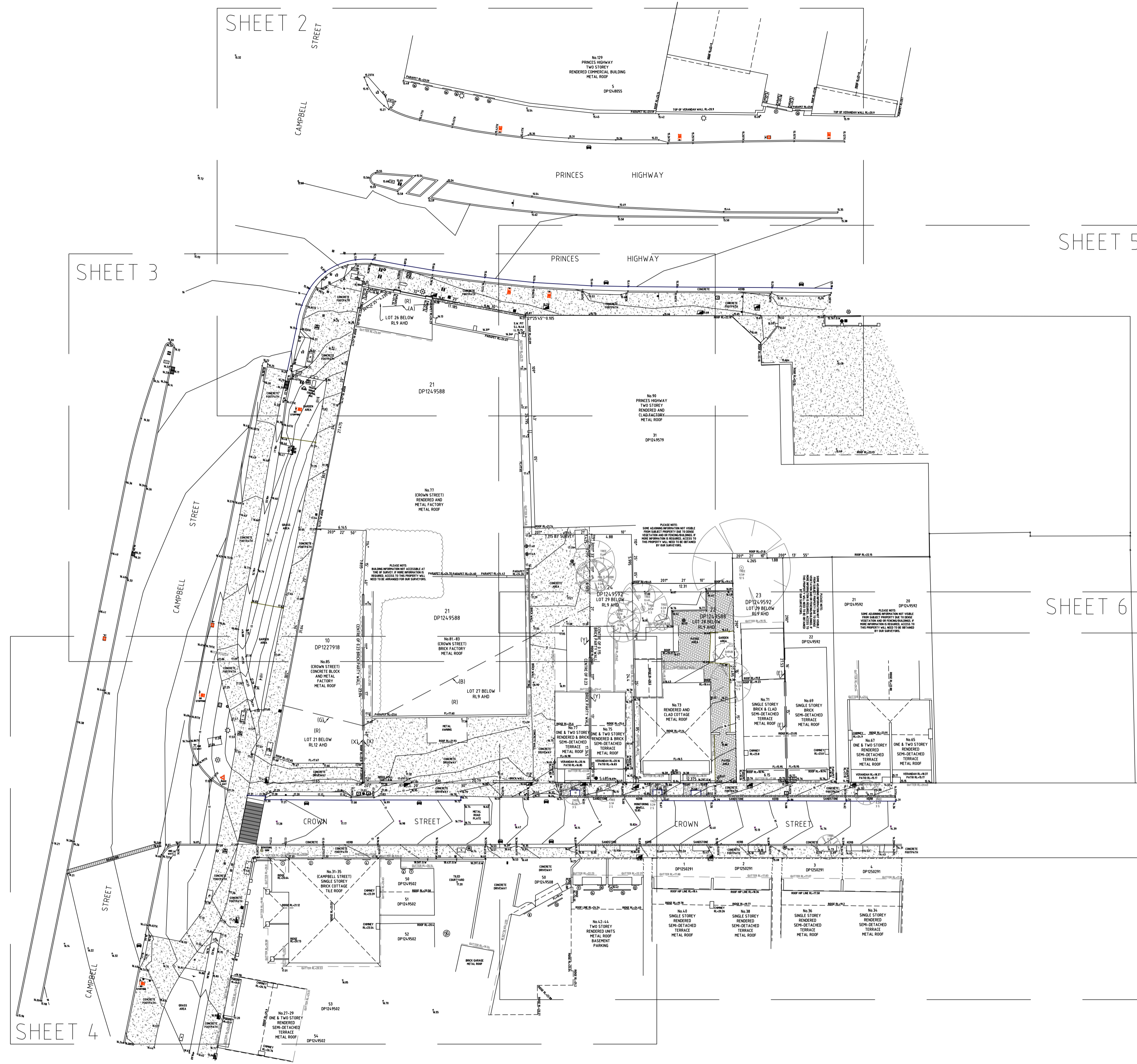
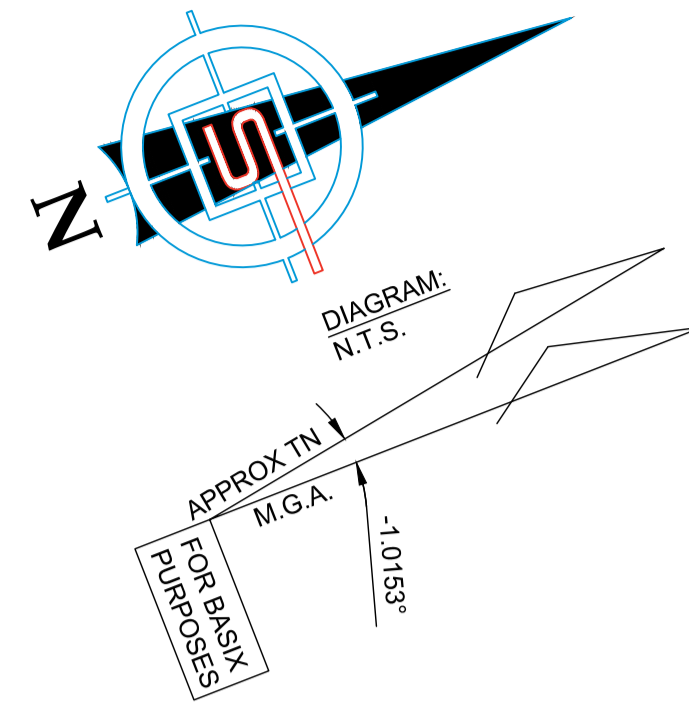
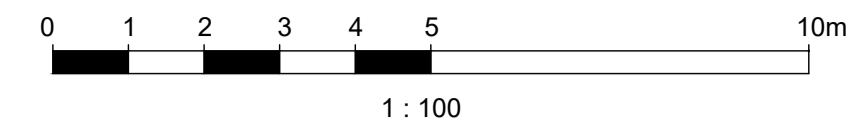

LOT 10 IN DP1227918 THE LAND ABOVE DESCRIBED IS LIMITED IN STRATUM IN THE MANNER DESCRIBED IN THE TITLE DIAGRAM  
LOT 21 IN DP1249588 THE LAND ABOVE DESCRIBED IS LIMITED IN STRATUM IN THE MANNER DESCRIBED IN DP1249588

LOT 21 IN DP1249588 IS LIMITED TITLE. LIMITATION PURSUANT TO SECTION 281(4) OF THE REAL PROPERTY ACT, 1900. THE BOUNDARIES OF THE LAND COMPRISED HEREIN HAVE NOT BEEN INVESTIGATED BY THE REGISTRAR GENERAL. AS REGARDS THE PART FORMERLY IN BK 3767 NO 720

LOT 22 IN DP1249588 THE LAND ABOVE DESCRIBED IS LIMITED IN STRATUM IN THE MANNER DESCRIBED IN DP1249588

LOT 23 IN DP1249592 THE LAND ABOVE DESCRIBED IS LIMITED IN STRATUM IN THE MANNER DESCRIBED IN DP1249592

(E)-CROSS EASEMENTS FOR SUPPORT 0.23 & 0.115 WIDE VIDE DEALING No.H823559 AS SHOWN IN DP204072

(X)-CROSS EASEMENTS FOR SUPPORT 0.23 WIDE VIDE BOOK 2308 No.58 AS SHOWN IN DP710629

(Y)-CROSS EASEMENTS FOR SUPPORT 0.23 AND 0.115 WIDE AS SHOWN IN DP710629

Rev.	Amendments	Date

**PLAN SHOWING DETAIL AND LEVELS OVER 71-85 CROWN STREET ST PETERS FOR DESIGN PURPOSES AND TO SUPPORT A DEVELOPMENT APPLICATION**

JOB No. 1627	YOUR REF. PAUL APOSTOLES
DRAWING No. 1627CO_EX.dwg	CLIENT: NASHCAP
SCALE: 1:300 (A1)	CHECKED M.S. DATE: 10.08.21
DATUM: A.H.D.	DRAWN M.S. DATE: 08.08.21
SHEET: 1 OF 1	DATE: 04.08.21

**WARNING:**

- SURVPLAN OWNS THE RIGHTS TO THIS SURVEY AND RELATED DOCUMENTS. THE INFORMATION PROVIDED IN THIS DOCUMENT IS FOR THE CLIENT NAMED WITHIN. USE OF THIS PLAN BY ANY OTHER PERSON/S IS NOT PERMITTED UNLESS WRITTEN CONSENT IS PROVIDED BY SURVPLAN.
- INFORMATION SHOWN HAS BEEN SURVEYED FOR DEVELOPMENT APPLICATION AND IS ACCURATE FOR PLANNING PURPOSES.
- SERVICES SHOWN HEREON ARE THOSE THAT WERE VISIBLE AT THE TIME OF SURVEY AND HAVE BEEN LOCATED BY FIELD SURVEY. FURTHER SERVICES MAY BE PRESENT. PRIOR TO ANY CONSTRUCTION OR EXCAVATION ON SITE THE RELEVANT AUTHORITIES SHOULD BE CONTACTED FOR POSSIBLE LOCATION OF FURTHER UNDERGROUND SERVICES AND DETAILED LOCATIONS OF ALL SERVICES. **DIAL BEFORE YOU DIG!**
- THIS SURVEY SHOULD NOT BE USED TO SETOUT BOUNDARY FENCING OR BUILDING WORKS NEAR OR ON THE BOUNDARIES. A SETOUT PLACING ACCURATE MAKES SHOULD BE CARRIED OUT PRIOR TO ANY BUILDING WORKS.
- THE CONTOUR INTERVAL IS 0.2m, UNLESS SHOWN OTHERWISE. THE CONTOURS HAVE BEEN PLOTTED FROM INTERPOLATION METHODS.



*Vag*

**VAUGHAN WADY**  
REGISTERED SURVEYOR #8684  
Surveyor Registered under the Surveying and Spatial Information Act 2002

**ORIGIN OF LEVELS:**  
SSM 207951 RL=15.956 (AHD) FOUND NEAR THE INTERSECTION OF CAMPBELL STREET & PRINCES HIGHWAY.  
ACCURACY OF ORIGIN: ± 0.01m

AREA LOT 20 VIDE DP 1249588: 4.5 m <sup>2</sup> BY CALC: 4.5 m <sup>2</sup>	AREA LOT 10 VIDE DP 1227918: 271.1 m <sup>2</sup> BY CALC: 271.2 m <sup>2</sup>
AREA LOT 21 VIDE DP 1249588: 1502 m <sup>2</sup> BY CALC: 1504.1 m <sup>2</sup>	AREA LOT 22 VIDE DP 1249588: 297.2 m <sup>2</sup> BY CALC: 301 m <sup>2</sup>
AREA LOT 23 VIDE DP 1249592: 168.8 BY CALC: X.XX	AREA LOT 24 VIDE DP 1249592: 158.2 m <sup>2</sup> BY CALC: 161.3 m <sup>2</sup>

WINDOW	SILL RL	HEIGHT	WIDTH	GLASS TYPE
1	18.53	1.2	0.6	CLEAR
2	18.53	1.65	0.76	CLEAR
3	18.4	1.68	0.74	CLEAR
4	18.19	1.7	0.9	CLEAR
5	18.15	1.51	0.9	CLEAR
6	18.42	0.95	0.47	CLEAR
7	18.42	0.95	0.47	CLEAR
8	17.18	2.2	0.98	DOOR
9	17.43	1.2	0.89	CLEAR
10	16.42	2.2	0.98	DOOR
11	16.42	2.2	0.98	DOOR
12	17.43	1.2	0.89	CLEAR
13	19.48	2.2	2	DOORS
14	19.41	2.2	2	DOORS
15	19.41	2.2	2	DOORS
16	18.64	2.15	1.03	CLEAR
17	15.3	6.98	2.43	CLEAR
18	18.2	4.09	0.6	CLEAR

**LEGEND**

TELSTRA PILLAR	TELSTRA MARKER POST	TELSTRA PIT	POWER POLE	ELECTRICAL PILLAR	POWER LIGHT POLE	LIGHT POLE	GAS METER	GAS DIRECTION MARKER	WATER MAIN	HYDRANT	RECYCLED WATER	WATER METER	STOP VALVE	WATER TAP	SEWER MANHOLE	SEWER VENT	SEWER LAMP POST	STORMWATER PIT	STORMWATER GRATE	SURFACE INLET PIT	STORMWATER PIPE INCLUDING PIPE SIZE	HEADWALL	CLOTHES LINE	OVERHEAD ELECTRICITY LINE	OVERHEAD TELECOM LINE	SEWER LINE
----------------	---------------------	-------------	------------	-------------------	------------------	------------	-----------	----------------------	------------	---------	----------------	-------------	------------	-----------	---------------	------------	-----------------	----------------	------------------	-------------------	-------------------------------------	----------	--------------	---------------------------	-----------------------	------------

STREET SIGN  
 PRAM CROSSING  
 VEHICLE CROSSING  
 TREE:  
 Ø DIAMETER  
 S SPREAD

L.G.A. : INNER WEST  
PARISH : PETERSHAM  
COUNTY : CUMBERLAND

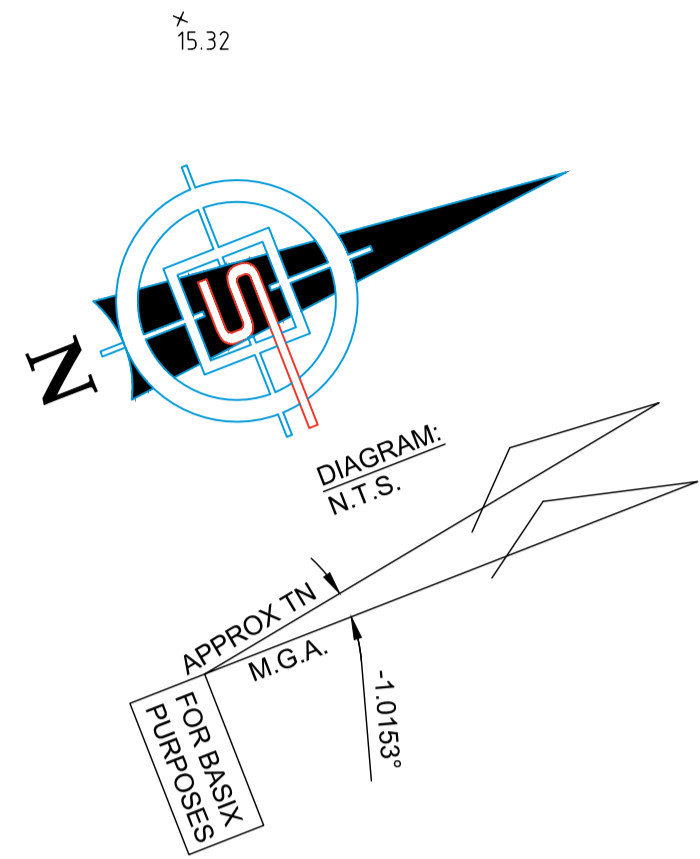
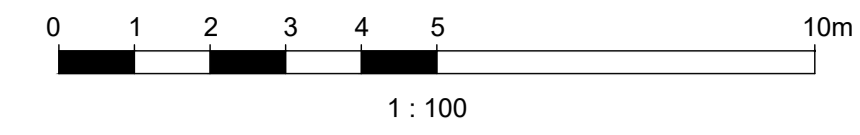

CAMPBELL STREET

No.129  
PRINCES HIGHWAY  
TWO STOREY  
RENDERED COMMERCIAL BUILDING  
METAL ROOF

5  
DP1248055

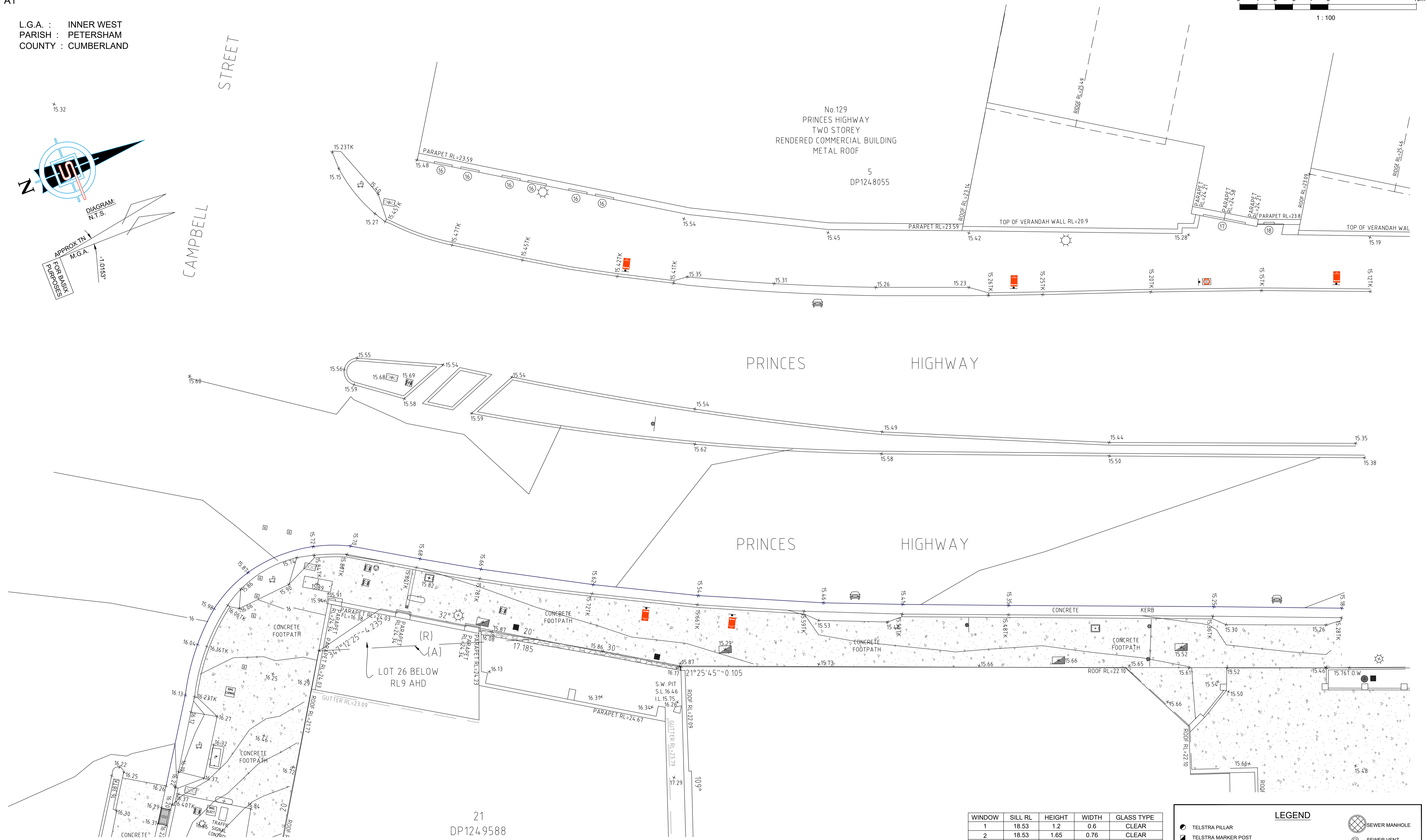

FOR EASEMENT AND RESTRICTION NOTES PLEASE REFER TO SHEET 1

 ABN 83 914 613 296 PO BOX 242 HELENSBURGH NSW 2508 PH 0420 944 413 Email: mat@survplan.com.au	Rev.	Amendments	Date
	JOB No.	1627	YOUR REF:
	DRAWING No.	1627CO_EX.dwg	CLIENT:
	SCALE:	1:100 (A1)	DRAWN:
DATUM:	A.H.D.	CHECKED:	M.S.
SHEET:	2 OF 6	DATE:	04.08.21
		DATE:	08.08.21
		DATE:	10.08.21

**WARNING:**

- SURVPLAN OWNS THE RIGHTS TO THIS SURVEY AND RELATED DOCUMENTS. THE INFORMATION PROVIDED IN THIS DOCUMENT IS FOR THE CLIENT NAMED WITHIN. USE OF THIS PLAN BY ANY OTHER PERSON'S IS NOT PERMITTED UNLESS WRITTEN CONSENT IS PROVIDED BY SURVPLAN.
- INFORMATION SHOWN HAS BEEN SURVEYED FOR DEVELOPMENT APPLICATION AND IS ACCURATE FOR PLANNING PURPOSES.
- SERVICES SHOWN HEREON ARE THOSE THAT WERE VISIBLE AT THE TIME OF SURVEY AND HAVE BEEN LOCATED BY FIELD SURVEY. FURTHER SERVICES MAY BE PRESENT. PRIOR TO ANY CONSTRUCTION OR EXCAVATION ON SITE THE RELEVANT AUTHORITIES SHOULD BE CONTACTED FOR POSSIBLE LOCATION OF FURTHER UNDERGROUND SERVICES AND DETAILED LOCATIONS OF ALL SERVICES. **DIAL BEFORE YOU DIG!**

5. THIS SURVEY SHOULD NOT BE USED TO SETOUT BOUNDARY FENCING OR BUILDING WORKS NEAR OR ON THE BOUNDARIES. A SETOUT PLACING ACCURATE MAKES SHOULD BE CARRIED OUT PRIOR TO ANY BUILDING WORKS.

6. THE CONTOUR INTERVAL IS 0.2m, UNLESS SHOWN OTHERWISE. THE CONTOURS HAVE BEEN PLOTTED FROM INTERPOLATION METHODS.



**VAUGHAN WADY**  
REGISTERED SURVEYOR #8684  
Surveyor Registered under the Surveying and Spatial Information Act 2002

**ORIGIN OF LEVELS:**  
SSM 207951 RL=15.956 (AHD) FOUND NEAR THE INTERSECTION OF CAMPBELL STREET & PRINCES HIGHWAY.  
ACCURACY OF ORIGIN: ±0.001m

AREA LOT 20 VIDE DP 1249588: 4.5 m <sup>2</sup> BY CALC: 4.5 m <sup>2</sup>	AREA LOT 10 VIDE DP 1227918: 271.1 m <sup>2</sup> BY CALC: 271.2 m <sup>2</sup>
AREA LOT 21 VIDE DP 1249588: 1502 m <sup>2</sup> BY CALC: 1504.1 m <sup>2</sup>	AREA LOT 22 VIDE DP 1249588: 297.2 m <sup>2</sup> BY CALC: 301 m <sup>2</sup>
AREA LOT 23 VIDE DP 1249592: 168.8 m <sup>2</sup> BY CALC: X.XX	AREA LOT 24 VIDE DP 1249592: 158.2 m <sup>2</sup> BY CALC: 161.3 m <sup>2</sup>

WINDOW	SILL RL	HEIGHT	WIDTH	GLASS TYPE
1	18.53	1.2	0.6	CLEAR
2	18.53	1.65	0.76	CLEAR
3	18.4	1.68	0.74	CLEAR
4	18.19	1.7	0.9	CLEAR
5	18.15	1.51	0.9	CLEAR
6	18.42	0.95	0.47	CLEAR
7	18.42	0.95	0.47	CLEAR
8	17.18	2.2	0.98	DOOR
9	17.43	1.2	0.89	CLEAR
10	16.42	2.2	0.98	DOOR
11	16.42	2.2	0.98	DOOR
12	17.43	1.2	0.89	CLEAR
13	19.48	2.2	2	DOORS
14	19.41	2.2	2	DOORS
15	19.41	2.2	2	DOORS
16	18.64	2.15	1.03	CLEAR
17	15.3	6.98	2.43	CLEAR
18	18.2	4.09	0.6	CLEAR

**LEGEND**

	TELSTRA PILLAR		SEWER MANHOLE
	TELSTRA MARKER POST		SEWER VENT
	TELSTRA PIT		SEWER LAMPHOLE
	POWER POLE		STORMWATER PIT
	ELECTRICAL PILLAR		STORMWATER GRATE
	POWER LIGHT POLE		SURFACE INLET PIT
	LIGHT POLE		STORMWATER PIPE INCLUDING PIPE SIZE
	GAS METER		HEADWALL
	GAS DIRECTION MARKER		CLOTHES LINE
	WATER MAIN		OVERHEAD ELECTRICITY LINE
	HYDRANT		OVERHEAD TELECOM LINE
	RECYCLED WATER		SEWER LINE
	WATER METER		
	STOP VALVE		
	WATER TAP		

L.G.A. : INNER WEST  
PARISH : PETERSHAM  
COUNTY : CUMBERLAND

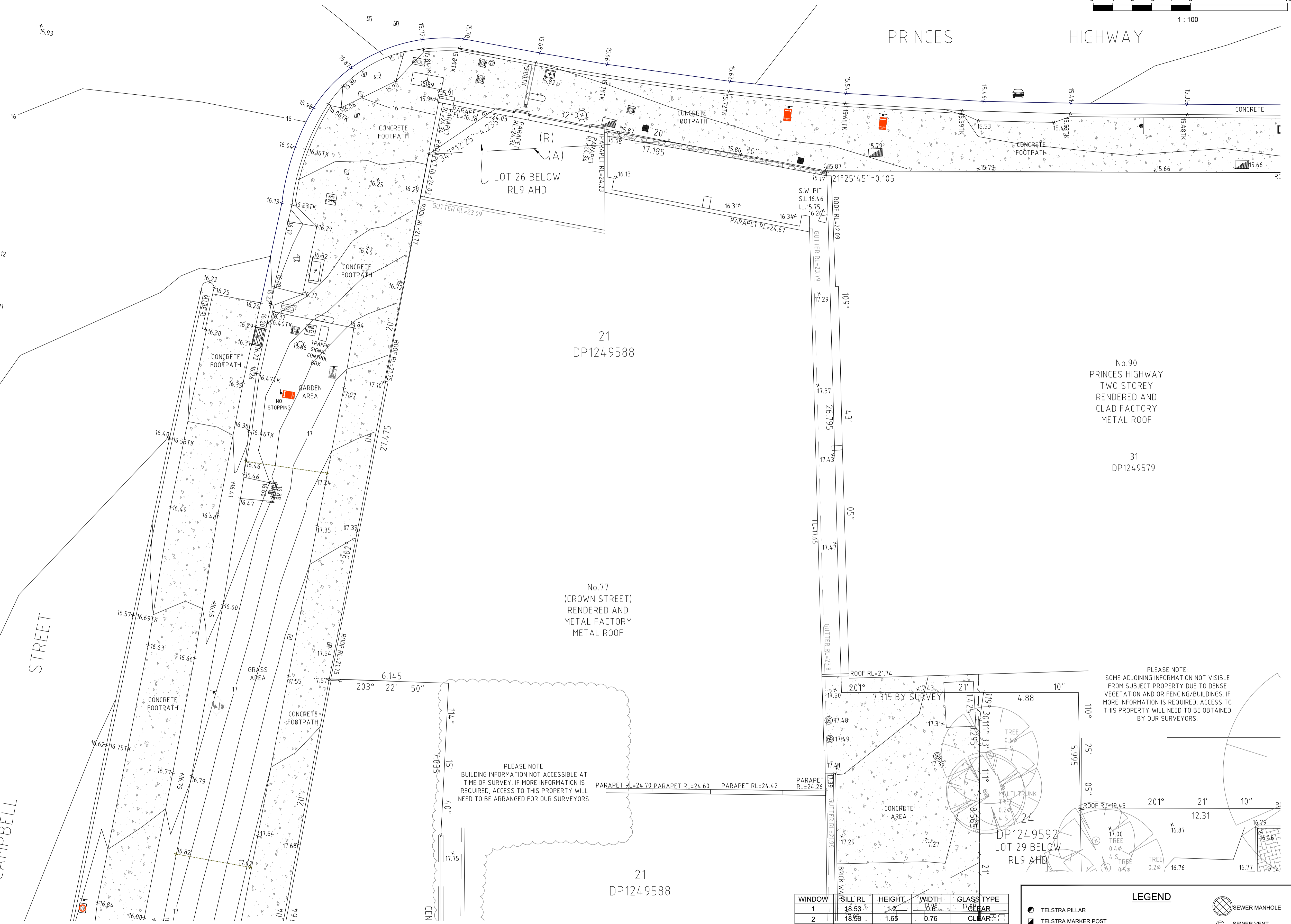
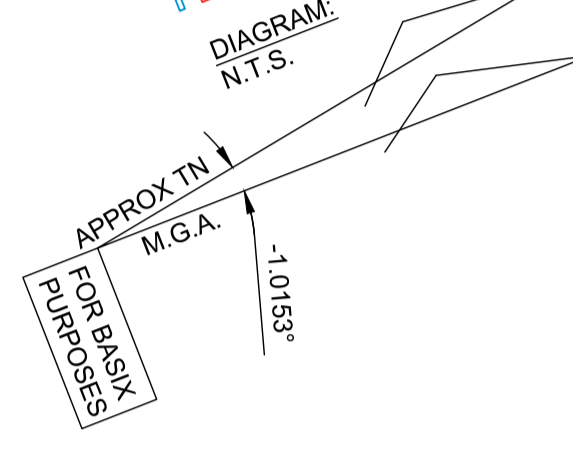
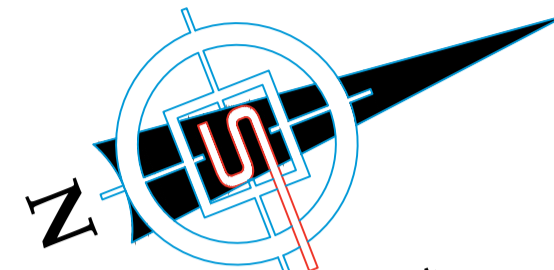
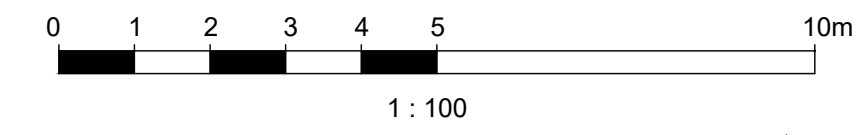

No 90  
PRINCES HIGHWAY  
TWO STOREY  
RENDERED AND  
CLAD FACTORY  
METAL ROOF

31  
DP1249579

21  
DP1249588

No 77  
(CROWN STREET)  
RENDERED AND  
METAL FACTORY  
METAL ROOF

PLEASE NOTE  
SOME ADJOINING INFORMATION NOT VISIBLE  
FROM SUBJECT PROPERTY DUE TO DENSE  
VEGETATION AND OR FENCING/BUILDINGS. IF  
MORE INFORMATION IS REQUIRED, ACCESS TO  
THIS PROPERTY WILL NEED TO BE OBTAINED  
BY OUR SURVEYORS.

PLEASE NOTE:  
BUILDING INFORMATION NOT ACCESSIBLE AT  
TIME OF SURVEY. IF MORE INFORMATION IS  
REQUIRED, ACCESS TO THIS PROPERTY WILL  
NEED TO BE ARRANGED FOR OUR SURVEYORS.

FOR EASEMENT AND RESTRICTION NOTES PLEASE REFER TO SHEET 1



Rev.	Amendments	Date

JOB No.	1627	YOUR REF:	PAUL APOSTOLES
DRAWING No.	1627CO_EX.dwg	CLIENT:	NASHCAP
SCALE:	1:100 (A1)	SURVEYED	M.S. DATE: 04.08.21
DATUM/A.H.D.	M.S. DATE: 04.08.21	DRAWN	M.S. DATE: 06.08.21
CHECKED	M.S. DATE: 10.08.21	SHEET:	3 OF 6

**WARNING:**

- SURVPLAN OWNS THE RIGHTS TO THIS SURVEY AND RELATED DOCUMENTS. THE INFORMATION PROVIDED IN THIS DOCUMENT IS FOR THE CLIENT NAMED WITHIN. USE OF THIS PLAN BY ANY OTHER PERSON/S IS NOT PERMITTED UNLESS WRITTEN CONSENT IS PROVIDED BY SURVPLAN.
- INFORMATION SHOWN HAS BEEN SURVEYED FOR DEVELOPMENT APPLICATION AND IS ACCURATE FOR PLANNING PURPOSES.
- SERVICES SHOWN HEREON ARE THOSE THAT WERE VISIBLE AT THE TIME OF SURVEY AND HAVE BEEN LOCATED BY FIELD SURVEY. FURTHER SERVICES MAY BE PRESENT. PRIOR TO ANY CONSTRUCTION OR EXCAVATION ON SITE THE RELEVANT AUTHORITIES SHOULD BE CONTACTED FOR POSSIBLE LOCATION OF FURTHER UNDERGROUND SERVICES AND DETAILED LOCATIONS OF ALL SERVICES. **DIAL BEFORE YOU DIG!**

5. THIS SURVEY SHOULD NOT BE USED TO SETOUT BOUNDARY FENCING OR BUILDING WORKS NEAR OR ON THE BOUNDARIES. A SETOUT PLACING ACCURATE MAKES SHOULD BE CARRIED OUT PRIOR TO ANY BUILDING WORKS.

6. THE CONTOUR INTERVAL IS 0.2m, UNLESS SHOWN OTHERWISE. THE CONTOURS HAVE BEEN PLOTTED FROM INTERPOLATION METHODS.

*Vag*

**VAUGHAN WADY**  
REGISTERED SURVEYOR #8684  
Surveyor Registered under the  
Surveying and Spatial Information Act 2002

**ORIGIN OF LEVELS:**  
SSM 207951 RL=15.956 (AHD) FOUND  
NEAR THE INTERSECTION OF CAMPBELL  
STREET & PRINCES HIGHWAY.  
ACCURACY OF ORIGIN: ± 0.01m



AREA LOT 20 VIDE DP 1249588: 4.5 m <sup>2</sup> BY CALC: 4.5 m <sup>2</sup>	AREA LOT 10 VIDE DP 1227918: 271.1 m <sup>2</sup> BY CALC: 271.2 m <sup>2</sup>
AREA LOT 21 VIDE DP 1249588: 1502 m <sup>2</sup> BY CALC: 1504.1 m <sup>2</sup>	AREA LOT 22 VIDE DP 1249588: 297.2 m <sup>2</sup> BY CALC: 301 m <sup>2</sup>
AREA LOT 23 VIDE DP 1249592: 168.8 BY CALC: X.XX	AREA LOT 24 VIDE DP 1249592: 158.2 m <sup>2</sup> BY CALC: 161.3 m <sup>2</sup>

WINDOW	SILL RL	HEIGHT	WIDTH	GLASS TYPE
1	18.53	1.2	0.6	CLEAR
2	18.53	1.65	0.76	CLEAR
3	18.4	1.68	0.74	CLEAR
4	18.19	1.7	0.9	CLEAR
5	18.15	1.51	0.9	CLEAR
6	18.42	0.95	0.47	CLEAR
7	18.42	0.95	0.47	CLEAR
8	17.18	2.2	0.98	DOOR
9	17.43	1.2	0.89	CLEAR
10	16.42	2.2	0.98	DOOR
11	16.42	2.2	0.98	DOOR
12	17.43	1.2	0.89	CLEAR
13	19.48	2.2	2	DOORS
14	19.41	2.2	2	DOORS
15	19.41	2.2	2	DOORS
16	18.64	2.15	1.03	CLEAR
17	15.3	6.98	2.43	CLEAR
18	18.2	4.09	0.6	CLEAR

**LEGEND**

	TELSTRA PILLAR		SEWER MANHOLE
	TELSTRA MARKER POST		SEWER VENT
	TELSTRA PIT		SEWER LAMPHOLE
	POWER POLE		STORMWATER PIT
	ELECTRICAL PILLAR		STORMWATER GRATE
	POWER LIGHT POLE		SURFACE INLET PIT
	LIGHT POLE		STORMWATER PIPE INCLUDING PIPE SIZE
	GAS METER		HEADWALL
	GAS DIRECTION MARKER		CLOTHES LINE
	WATER MAIN		OVERHEAD ELECTRICITY LINE
	HYDRANT		OVERHEAD TELECOM LINE
	RECYCLED WATER		SEWER LINE
	WATER METER		
	WATER TAP		

L.G.A. : INNER WEST  
 PARISH : PETERSHAM  
 COUNTY : CUMBERLAND

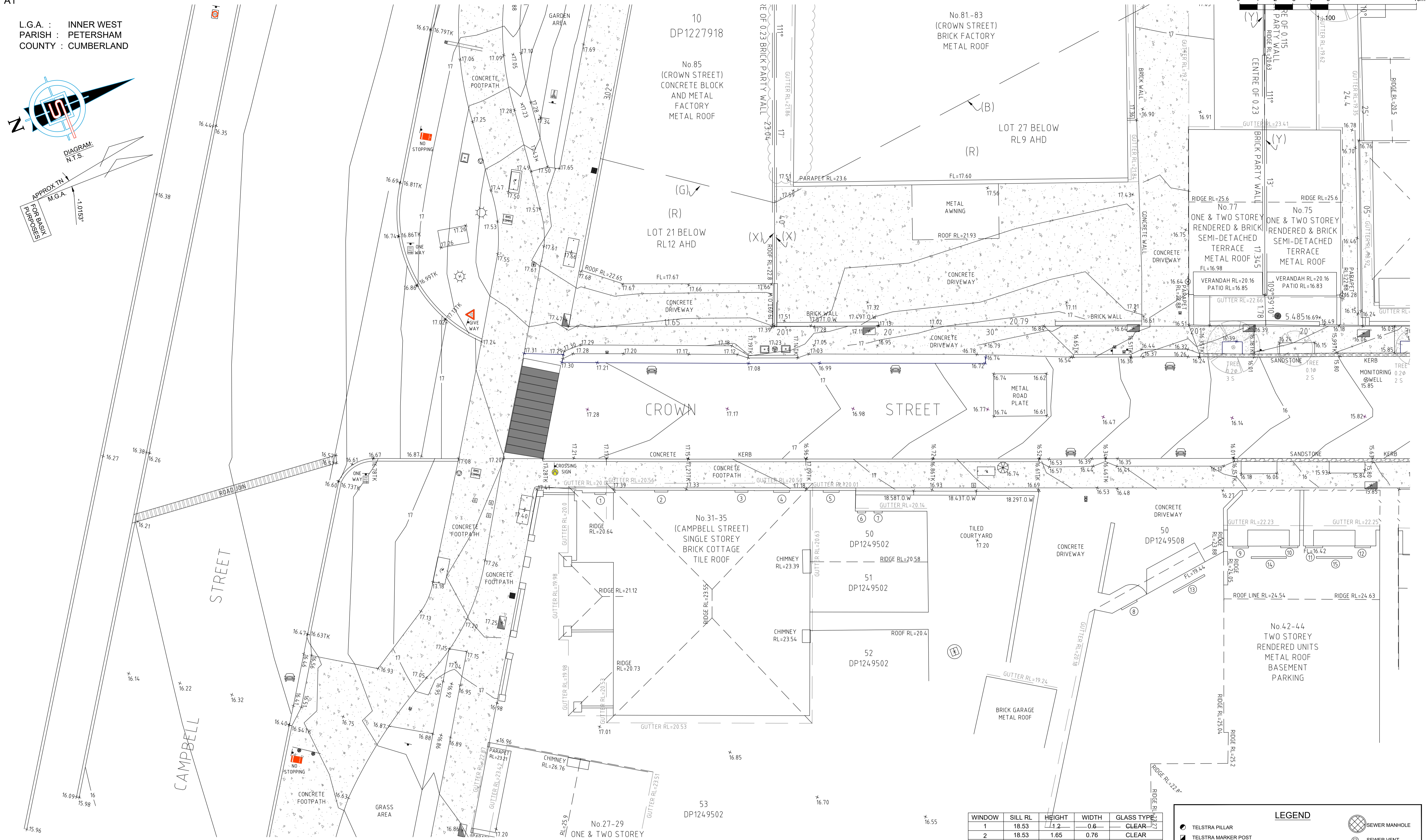
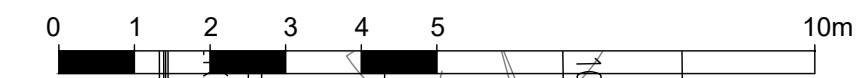
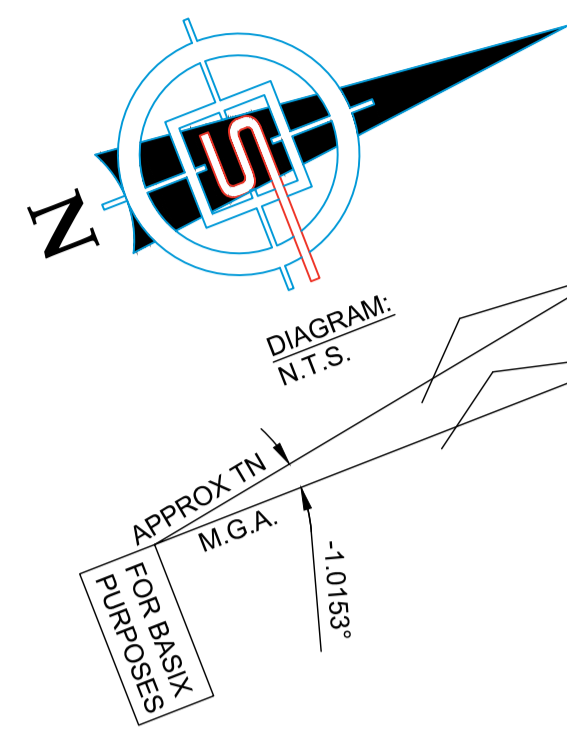

FOR EASEMENT AND RESTRICTION NOTES PLEASE REFER TO SHEET 1

Rev.	Amendments	Date

**WARNING:**

- SURVPLAN OWNS THE RIGHTS TO THIS SURVEY AND RELATED DOCUMENTS. THE INFORMATION PROVIDED IN THIS DOCUMENT IS FOR THE CLIENT NAMED WITHIN. USE OF THIS PLAN BY ANY OTHER PERSON'S IS NOT PERMITTED UNLESS WRITTEN CONSENT IS PROVIDED BY SURVPLAN.
- INFORMATION SHOWN HAS BEEN SURVEYED FOR DEVELOPMENT APPLICATION AND IS ACCURATE FOR PLANNING PURPOSES.
- SERVICES SHOWN HEREON ARE THOSE THAT WERE VISIBLE AT THE TIME OF SURVEY AND HAVE BEEN LOCATED BY FIELD SURVEY. FURTHER SERVICES MAY BE PRESENT. PRIOR TO ANY CONSTRUCTION OR EXCAVATION ON SITE THE RELEVANT AUTHORITIES SHOULD BE CONTACTED FOR POSSIBLE LOCATION OF FURTHER UNDERGROUND SERVICES AND DETAILED LOCATIONS OF ALL SERVICES. **DIAL BEFORE YOU DIG!**

JOB No.	1627	YOUR REF:	PAUL APOSTOLES
DRAWING No.	1627CO_EX.dwg	CLIENT:	NASHCAP
SCALE:	1:100 (A1)	SURVEYED:	
DATUM/A.H.D.		M.S. DATE:	
SHEET:	4 OF 6	CHECKED:	
		M.S. DATE:	
		DATE:	
		DATE:	

**3. THIS SURVEY SHOULD NOT BE USED TO SETOUT BOUNDARY FENCING OR BUILDING WORKS NEAR OR ON THE BOUNDARIES. A SETOUT PLACING ACCURATE MAKES SHOULD BE CARRIED OUT PRIOR TO ANY BUILDING WORKS.**

**4. THE CONTOUR INTERVAL IS 0.2m, UNLESS SHOWN OTHERWISE. THE CONTOURS HAVE BEEN PLOTTED FROM INTERPOLATION METHODS.**

**ORIGIN OF LEVELS:**  
 SSM 207951 RL=15.956 (AHD) FOUND NEAR THE INTERSECTION OF CAMPBELL STREET & PRINCES HIGHWAY.  
 ACCURACY OF ORIGIN: ±0.001m

**VAUGHAN WADY**  
 REGISTERED SURVEYOR #8684  
 Surveyor Registered under the Surveying and Spatial Information Act 2002

**ORIGIN OF LEVELS:**  
 SSM 207951 RL=15.956 (AHD) FOUND NEAR THE INTERSECTION OF CAMPBELL STREET & PRINCES HIGHWAY.  
 ACCURACY OF ORIGIN: ±0.001m

AREA LOT 20 VIDE DP 1249588: 4.5 m <sup>2</sup> BY CALC: 4.5 m <sup>2</sup>	AREA LOT 10 VIDE DP 1227918: 271.1 m <sup>2</sup> BY CALC: 271.2 m <sup>2</sup>
AREA LOT 21 VIDE DP 1249588: 1502 m <sup>2</sup> BY CALC: 1504.1 m <sup>2</sup>	AREA LOT 22 VIDE DP 1249588: 297.2 m <sup>2</sup> BY CALC: 301 m <sup>2</sup>
AREA LOT 23 VIDE DP 1249592: 168.8 m <sup>2</sup> BY CALC: X.XX	AREA LOT 24 VIDE DP 1249592: 158.2 m <sup>2</sup> BY CALC: 161.3 m <sup>2</sup>

WINDOW	SILL RL	HEIGHT	WIDTH	GLASS TYPE
1	18.53	1.2	0.6	CLEAR
2	18.53	1.65	0.76	CLEAR
3	18.4	1.68	0.74	CLEAR
4	18.19	1.7	0.9	CLEAR
5	18.15	1.51	0.9	CLEAR
6	18.42	0.95	0.47	CLEAR
7	18.42	0.95	0.47	CLEAR
8	17.18	2.2	0.98	DOOR
9	17.43	1.2	0.89	CLEAR
10	16.42	2.2	0.98	DOOR
11	16.42	2.2	0.98	DOOR
12	17.43	1.2	0.89	CLEAR
13	19.48	2.2	2	DOORS
14	19.41	2.2	2	DOORS
15	19.41	2.2	2	DOORS
16	18.64	2.15	1.03	CLEAR
17	15.3	6.98	2.43	CLEAR
18	18.2	4.09	0.6	CLEAR

**LEGEND**

	TELSTRA MARKER POST		SEWER MANHOLE
	TELSTRA PIT		SEWER VENT
	POWER POLE		SEWER LAMP HOLE
	ELECTRICAL PILLAR		STORMWATER PIT
	POWER LIGHT POLE		STORMWATER GRATE
	LIGHT POLE		SURFACE INLET PIT
	GAS METER		STORMWATER PIPE INCLUDING PIPE SIZE
	GAS DIRECTION MARKER		HEADWALL
	WATER MAIN		CLOTHES LINE
	HYDRANT		OVERHEAD ELECTRICITY LINE
	RECYCLED WATER		OVERHEAD TELECOM LINE
	WATER METER		SEWER LINE
	STOP VALVE		
	WATER TAP		



L.G.A. : INNER WEST  
PARISH : PETERSHAM  
COUNTY : CUMBERLAND

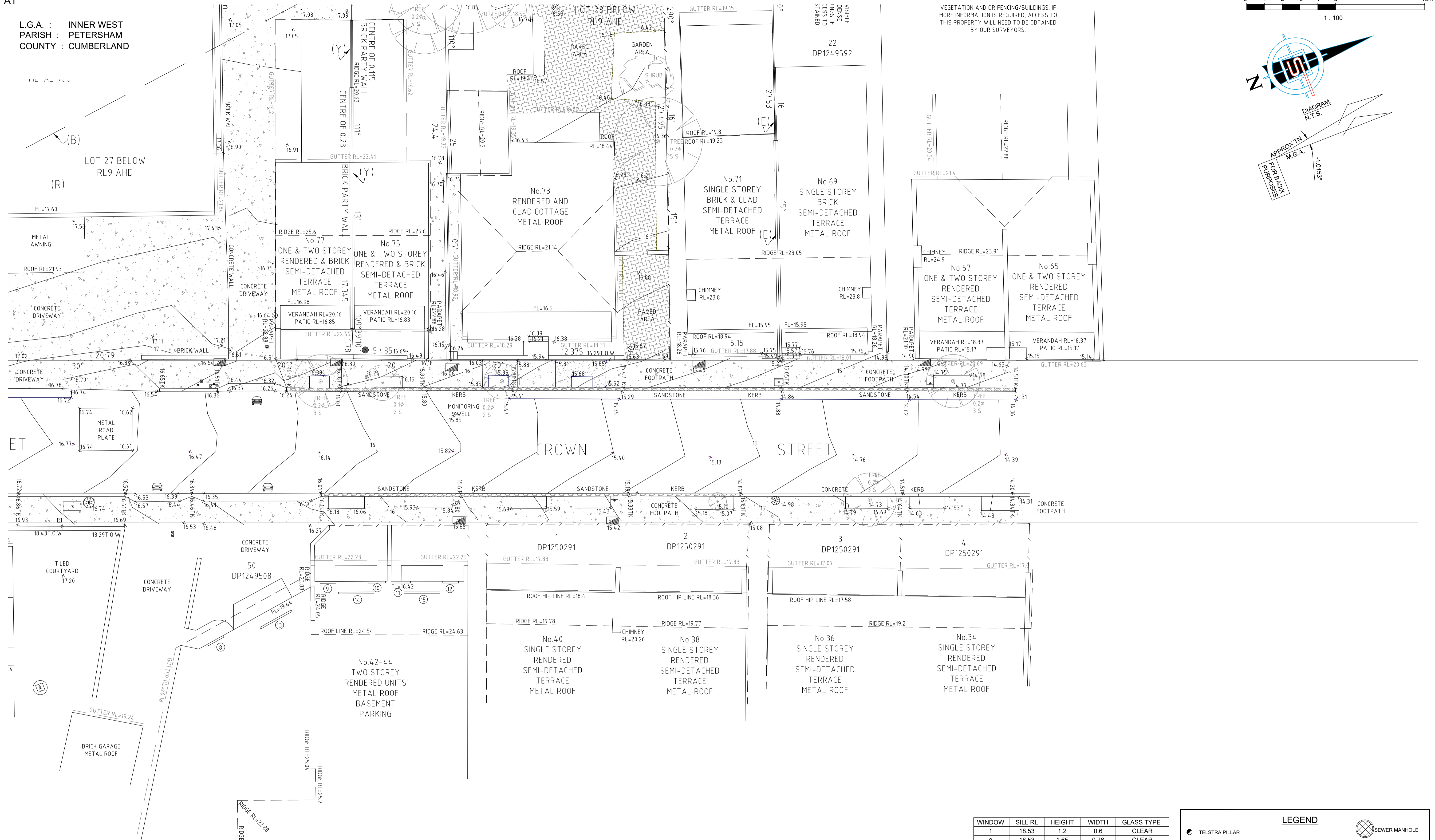
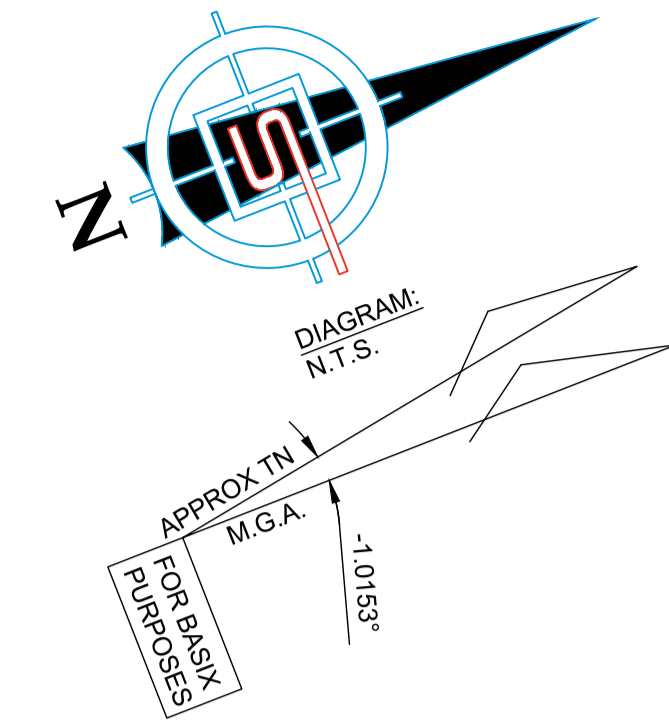
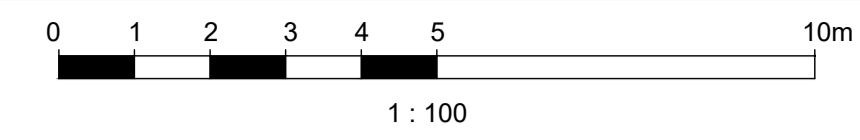

FOR EASEMENT AND RESTRICTION NOTES PLEASE REFER TO SHEET 1

**SURVPLAN**  
SURVEYING & PLANNING  
ASB 83 914 613 256  
PO BOX 242 HELENSBURGH NSW 2508  
PH 04 20 944 413 Email: mal@survplan.com.au

PLAN SHOWING DETAIL AND LEVELS  
OVER 71-85 CROWN STREET  
ST PETERS  
FOR DESIGN PURPOSES  
AND TO SUPPORT A  
DEVELOPMENT APPLICATION

Rev.	Amendments	Date

JOB No. 1627  
 DRAWING No. 1627CO\_EX.dwg  
 SCALE: 1:100 (A1)  
 DATUM: A.H.D.  
 SHEET: 6 OF 6

YOUR REF: PAUL APOSTOLES  
 CLIENT: NASHCAP  
 DRAWN M.S. DATE: 04.08.21  
 CHECKED M.S. DATE: 08.08.21  
 DATE: 10.08.21

**WARNING:**

- SURVPLAN OWNS THE RIGHTS TO THIS SURVEY AND RELATED DOCUMENTS. THE INFORMATION PROVIDED IN THIS DOCUMENT IS FOR THE CLIENT NAMED WITHIN. USE OF THIS PLAN BY ANY OTHER PERSON/S IS NOT PERMITTED UNLESS WRITTEN CONSENT IS PROVIDED BY SURVPLAN.
- INFORMATION SHOWN HAS BEEN SURVEYED FOR DEVELOPMENT APPLICATION AND IS ACCURATE FOR PLANNING PURPOSES.
- SERVICES SHOWN HEREON ARE THOSE THAT WERE VISIBLE AT THE TIME OF SURVEY AND HAVE BEEN LOCATED BY FIELD SURVEY. FURTHER SERVICES MAY BE PRESENT. PRIOR TO ANY CONSTRUCTION OR EXCAVATION ON SITE THE RELEVANT AUTHORITIES SHOULD BE CONTACTED FOR POSSIBLE LOCATION OF FURTHER UNDERGROUND SERVICES AND DETAILED LOCATIONS OF ALL SERVICES. **DIAL BEFORE YOU DIG!**

THIS SURVEY SHOULD NOT BE USED TO SETOUT BOUNDARY FENCING OR BUILDING WORKS NEAR OR ON THE BOUNDARIES. A SETOUT PLACING ACCURATE MAKES SHOULD BE CARRIED OUT PRIOR TO ANY BUILDING WORKS.

THE CONTOUR INTERVAL IS 0.2m. UNLESS SHOWN OTHERWISE. THE CONTOURS HAVE BEEN PLOTTED FROM INTERPOLATION METHODS.

**DIAL 1100 BEFORE YOU DIG**  
www.1100.com.au

**VAUGHAN WADY**  
REGISTERED SURVEYOR #8684  
Surveyor Registered under the  
Surveying and Spatial Information Act 2002

**ORIGIN OF LEVELS:**  
SSM 207951 RL=15.956 (AHD) FOUND NEAR THE INTERSECTION OF CAMPBELL STREET & PRINCES HIGHWAY.  
ACCURACY OF ORIGIN: ± 0.01m

AREA LOT 20 VIDE DP 1249588: 4.5 m <sup>2</sup> BY CALC: 4.5 m <sup>2</sup>	AREA LOT 10 VIDE DP 1227918: 271.1 m <sup>2</sup> BY CALC: 271.2 m <sup>2</sup>
AREA LOT 21 VIDE DP 1249588: 1502 m <sup>2</sup> BY CALC: 1504.1 m <sup>2</sup>	AREA LOT 22 VIDE DP 1249588: 297.2 m <sup>2</sup> BY CALC: 301 m <sup>2</sup>
AREA LOT 23 VIDE DP 1249592: 168.8 BY CALC: X.XX	AREA LOT 24 VIDE DP 1249592: 158.2 m <sup>2</sup> BY CALC: 161.3 m <sup>2</sup>

WINDOW	SILL RL	HEIGHT	WIDTH	GLASS TYPE
1	18.53	1.2	0.6	CLEAR
2	18.53	1.65	0.76	CLEAR
3	18.4	1.68	0.74	CLEAR
4	18.19	1.7	0.9	CLEAR
5	18.15	1.51	0.9	CLEAR
6	18.42	0.95	0.47	CLEAR
7	18.42	0.95	0.47	CLEAR
8	17.18	2.2	0.98	DOOR
9	17.43	1.2	0.89	CLEAR
10	16.42	2.2	0.98	DOOR
11	16.42	2.2	0.98	DOOR
12	17.43	1.2	0.89	CLEAR
13	19.48	2.2	2	DOORS
14	19.41	2.2	2	DOORS
15	19.41	2.2	2	DOORS
16	18.64	2.15	1.03	CLEAR
17	15.3	6.98	2.43	CLEAR
18	18.2	4.09	0.6	CLEAR

**LEGEND**

TELSTRA PILLAR	TELSTRA MARKER POST	TELSTRA PIT	POWER POLE	ELECTRICAL PILLAR	POWER LIGHT POLE	LIGHT POLE	GAS METER	GAS DIRECTION MARKER	WATER MAIN	HYDRANT	RECYCLED WATER	WATER METER	STOP VALVE	WATER TAP	SEWER MANHOLE	SEWER VENT	SEWER LAMPHOLE	STORMWATER PIT	STORMWATER GRATE	SURFACE INLET PIT	STORMWATER PIPE INCLUDING PIPE SIZE	HEADWALL	CLOTHES LINE	OVERHEAD ELECTRICITY LINE	OVERHEAD TELECOM LINE	SEWER LINE
----------------	---------------------	-------------	------------	-------------------	------------------	------------	-----------	----------------------	------------	---------	----------------	-------------	------------	-----------	---------------	------------	----------------	----------------	------------------	-------------------	-------------------------------------	----------	--------------	---------------------------	-----------------------	------------

STREET SIGN  
 PRAM CROSSING  
 VEHICLE CROSSING  
 TREE: Ø DIAMETER S SPREAD  
 0.7225