

29 August 2024

## Upcoming Traffic Works – Centennial Street, Marrickville

Dear Residents,

Inner West Council is investing \$53,000 to improve drainage on Centennial Street, Marrickville (primarily in front of No. 9 to No. 11A) to better manage stormwater in the area and upgrade the aging stormwater infrastructure.

The works include:

- Construction of 3 new kerb inlet pits.
- Installation of 6.5m length of new concrete stormwater pipe.
- Reconstruct 80sqm concrete footpath.
- Reconstruct 18m concrete kerb & gutter.
- Reconstruct 16sqm of existing Tree Pit.

The General Arrangement plan is available on Council's website at <https://www.innerwest.nsw.gov.au/develop/council-run-works-and-projects/park-building-and-streetscape-projects>

### Timing of work

The works will commence the week of 30 September 2024 and take approximately two weeks to complete (weather permitting).

### Reducing construction impacts

Traffic control will be employed to manage traffic and pedestrian flow around the site. Access to properties will be maintained; however, please note that some car parking spaces near the works will be closed to the public during construction. Please avoid parking next to or near the active work zones.

### Enquiries

Council's contractor: Civotek P/L  
Ibrahim Hawat, 0416 661 160

Council officer: Nick Poulos, Project Manager, 02 9392 5526  
nick.poulos@innerwest.nsw.gov.au

We appreciate your patience and co-operation while we complete this important work.

Yours faithfully,

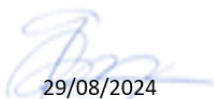

29/08/2024

**Predrag Gudelj | Coordinator Roads and Stormwater Projects**  
**Inner West Council**

# INNER WEST

## INNER WEST COUNCIL CENTENNIAL STREET, MARRICKVILLE NEAR NO.9 & NO.11 CENTENNIAL STREET PROPOSED STORMWATER UPGRADE

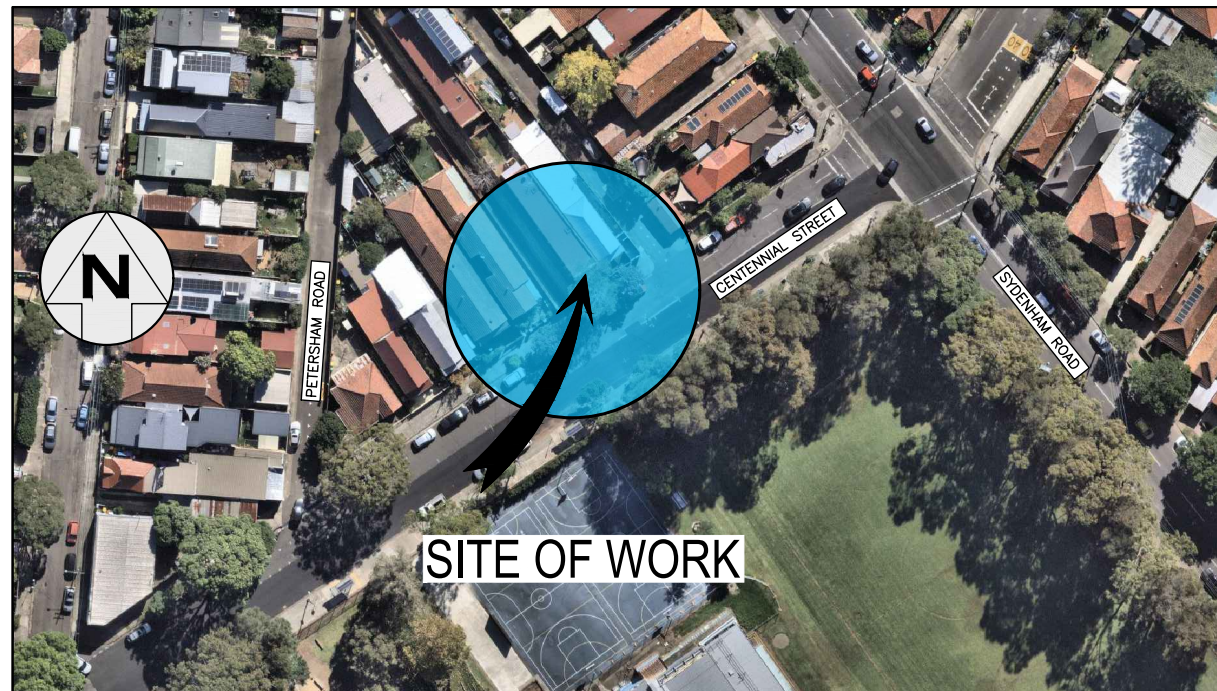

LOCALITY SKETCH  
N.T.S.

IMAGE COURTESY OF NEARMAP

**PROJECT #: 303025**  
**PLAN #: 10233**

**ISSUE FOR  
CONSTRUCTION**

**! WARNING !**  
**BEWARE OF UNDERGROUND SERVICES**  
THE LOCATION OF UNDERGROUND SERVICES HAVE BEEN INTERPOLATED FROM AERIAL PHOTOGRAMMETRIC DATA OR KNOWN POSITIONS OF VALVES, MANHOLES ETC. OR INFORMATION SUPPLIED BY SERVICE AUTHORITIES. NO RESPONSIBILITY IS TAKEN FOR THE ACCURACY OF THE INTERPOLATED INFORMATION SUPPLIED. ENSURE ALL SERVICES ARE ACCURATELY LOCATED PRIOR TO COMMENCEMENT OF WORK.



UTILITIES, IF SHOWN, ARE DIAGRAMMATIC ONLY. CONTRACTORS ARE RESPONSIBLE TO LOCATE AND AVOID DAMAGE TO THEM AS SPECIFIED BY EACH UTILITIES EXCAVATION GUIDELINES.

DRAWING INDEX	
SHEET #	SHEET TITLE
1	COVER SHEET
2	NOTES & SCHEDULES
3	DEMOLITION PLAN
4	CIVIL & DRAINAGE PLAN
5	DRAINAGE LONGSECTIONS
6	TYPICAL DETAILS 01
7	TYPICAL DETAILS 02
8	TYPICAL DETAILS 03
9	UTILITIES

IMPORTANT		
IN CASE OF EMERGENCY, CONTACT THE FOLLOWING SERVICE AUTHORITIES; IF THEIR SERVICES ARE INVOLVED/AFFECTED		
AUTHORITY	CONTACT NO.	SERVICE TYPE
AARNET PTY LTD	1 300 275 662	FIBRE OPTIC ASSETS
AUSGRID	02 4951 0899	LOW VOLTAGE LINE
JEMENA GAS SOUTH	1300 880 906	PRIMARY & DISTRIBUTION
NBN CO.	1800 626 329	BURIED FIBRE OPTIC CABLES
NEXTGEN	1800 032 532	BURIED FIBRE OPTIC CABLES
OPTUS	1800 505 777	BURIED FIBRE OPTIC CABLES
SYDNEYWATER	13 20 92	WATER & SEWER LINES
TELSTRA	1800 653 935	BURIED CABLES
VERIZON	02 9434 5000	BURIED CABLES

CHECKED & APPROVED 	SURVEYED BY ADAM DILLON 22-11-2022	<b>INNER WEST</b> 2-14 FISHER STREET, PETERSHAM NSW 2049 Ph. 02 9392 5000 Post: PO Box 14 PETERSHAM council@innerwest.nsw.gov.au Web: https://www.innerwest.nsw.gov.au	DOCUMENT REFERENCE	SURV. GEN. R.M.S. A.G.L. / SHELL PIPELINES SYDNEY WATER TELSTRA / OPTUS AUSGRID NOTICE OF ENTRY KERB & GUTTER NOTICES DATE	COORDINATE SYSTEM GDA2020 SCALES (ORIGINAL A1) N.A.	PROJECT NO. 303025	SHEET NO. 1 of 9
	APPROVED FOR CONSTRUCTION 		DESIGNED BY SANJOY 12-07-2023	SERVICES AFFECTED	CENTENNIAL STREET, MARRICKVILLE NEAR NO.9 & NO.11 CENTENNIAL STREET PROPOSED STORMWATER UPGRADE COVER SHEET	PLAN NO. 10233	SHEET REV #

\\rec-fil001\innerwest.nsw.gov.au\assets and Environment\GIS\GIS\CD\24\512\SU\303025-MAR-11\CentennialSt-P148\p148\p148\p148\10233\1.DESIGN\12. FinalDesign\1002\Draw\303025-10233-Plan.dwg



## GENERAL NOTES

- DURING CONSTRUCTION THE WORK IS TO BE SIGNPOSTED AND MARKED TO THE REQUIREMENTS OF AS1742.2-2009 "TRAFFIC CONTROL DEVICES FOR GENERAL USE" AND AS1742.3-2009 "TRAFFIC CONTROL FOR WORKS ON ROADS". ALL TRAFFIC CONTROL PLANS (TCP'S) MUST BE PREPARED BY A CERTIFIED RMS ACCREDITED PERSON AND COMPLY WITH RMS "TRAFFIC CONTROL AT WORKS SITES" MANUAL AND WORK COVER NSW REGULATIONS.
- ALL WORK IS TO BE CARRIED OUT IN ACCORDANCE WITH COUNCIL'S TECHNICAL SPECIFICATION, AUS-SPEC No. 2, AND TO BEST-PRACTICE STANDARDS TO THE SATISFACTION OF COUNCIL'S MANAGER CAPITAL PROGRAMS.
- INSPECTIONS ARE REQUIRED AT THE FOLLOWING STAGES AND AS OTHERWISE DIRECTED BY THE MANAGER CAPITAL PROGRAMS
  - DRAINAGE:**
    - TRENCHES EXCAVATED PRIOR TO LAYING BEDDING MATERIAL
    - BEDDING AND PIPES LAID, PIPES JOINTED PRIOR TO BACKFILLING
    - PIPES BACKFILLED WITH APPROVED SAND OR GRAVEL BACKFILLING COMPACTED.
  - CONCRETE WORKS:**
    - EXCAVATION COMPLETED, FORMWORK AND REINFORCEMENT SET
    - CONCRETE POURED AND CURED
  - ROAD PAVEMENT:**
    - SUBGRADE TRIMMED AND CONSOLIDATED PRIOR TO FIRST PAVEMENT COURSE.
    - EACH PAVEMENT LAYER SPREAD AND COMPACTED
    - PAVEMENT COMPLETED PRIOR TO SEALING.
- DRAINAGE:
  - ALL PIPES LOCATED UNDER ROAD PAVEMENT SHALL BE BACK FILLED WITH GRANULAR MATERIAL TO SUBGRADE LEVEL.
  - MINIMUM INTERNAL SIZE OF PITS SHALL BE 600mm x 600mm WITH GRATED COVER OR CONCRETE LID AS DIRECTED.
  - PITS OF GREATER DEPTH THAN 600mm SHALL HAVE MINIMUM INTERNAL SIZE OF 900mm x 600mm.
  - PITS OF GREATER DEPTH THAN 1m SHALL BE PROVIDED WITH STEP IRONS
  - PIPES SHALL BE JOINTED IN ACCORDANCE WITH MANUFACTURER'S
- EXISTING SURFACE FITTINGS OF SERVICES SHALL BE ADJUSTED AS NECESSARY TO THE REQUIREMENTS OF THE RELEVANT AUTHORITY.
- ALL PATHWAYS, KERB & GUTTER AND ROAD PAVEMENT WHERE AFFECTED BY CONSTRUCTION WORKS SHALL BE RECONSTRUCTED TO COUNCIL'S STANDARD SPECIFICATIONS, AND TO AUS-SPEC No. 2 SPECIFICATIONS.
- SUBSOIL DRAINAGE SHALL BE PROVIDED WHERE REQUIRED BY COUNCIL'S ENGINEER AND AS SHOWN ON PLAN.
- SUITABLE VEHICULAR ACCESS SHALL BE MAINTAINED TO EACH LOT OR ALTERNATIVE ARRANGEMENTS MADE WITH THE OWNERS.
- ALL ROOF WATER CONNECTIONS SHALL BE RECONNECTED TO THE NEW KERB OR TO COUNCIL'S STORM WATER SYSTEM.
- THE CONTRACTOR SHALL BE RESPONSIBLE FOR LOCATING AND ADJUSTING UTILITY SERVICES TO ADJACENT PROPERTIES AS NECESSARY. LOCATION OF ALL SERVICES SHOWN ON THIS PLAN ARE APPROXIMATE ONLY AND ARE TO BE CONFIRMED ON SITE PRIOR TO COMMENCEMENT OF WORKS. INDIVIDUAL SERVICE CONNECTIONS TO PROPERTIES ARE NOT SHOWN ON THIS PLAN.
- CONTRACTOR TO NOTIFY ALL RESIDENTS 7 DAYS PRIOR TO COMMENCEMENT OF WORKS.
- ACCESS TO PREMISES IS TO BE MAINTAINED AT ALL TIMES.
- RESTORATION OF ALL AREAS AFFECTED BY WORKS WITHIN THE JOB SITE IS TO BE CARRIED OUT TO SPECIFICATION AND SATISFACTION OF COUNCIL.
- TREES AFFECTED BY THE WORKS ARE TO BE REMOVED OR PROTECTED AS DIRECTED BY COUNCIL.
- ALL GRATES ON DRAINAGE PITS TO BE AN APPROVED HEAVY DUTY AND BICYCLE SAFE GRATE.
- SURFACE FITTINGS OF ALL SERVICES AFFECTED BY ROADWORKS ARE TO BE ADJUSTED TO SUIT NEW FINISHED SURFACE LEVELS.
- CONTRACTOR IS TO LOCATE AND DETERMINE DEPTH OF ALL SERVICES PRIOR TO COMMENCEMENT OF CONSTRUCTION.
- CONTRACTOR TO LOCATE AND DETERMINE DEPTH OF ALL EXISTING PROPERTY SEWER CONNECTIONS WITH A REPRESENTATIVE FROM SYDNEY WATER, PRIOR TO COMMENCEMENT OF CONSTRUCTION.

## PITS AND PIPELINES

- COMPRESSIVE STRENGTH OF CONCRETE F'c AT 28 DAYS TO BE 25 MPa
- 100 DIA. SUBSOIL DRAINAGE PIPE 3000 LG. WRAPPED IN FABRIC SOCK TO BE PROVIDED IN PIPE TRENCHES ADJACENT TO INLET PIPES.
- PROVIDE STEP IRONS, APPROVED BY COUNCIL, DOWN THE SIDE OF ALL PITS DEEPER THAN 1.0m. THE STEP IRONS SHALL BE STAGGERED TO GIVE A 300mm SPACING VERTICALLY AND 220mm SPACING HORIZONTALLY.
- PROVIDE FALL IN GRADE OF SURFACE LEVELS FROM BUILDINGS TO NEAREST SURFACE INLET PIT.
- TOP OF BENCHING TO BE 1/2 OF OUTLET PIPE DIAMETER
- ALL PIT FLOORS TO BE BENCHING TO PROVIDE MINIMUM 30mm FALL FROM INLET PIPE TO OUTLET PIPE

**NOTE**  
ALL DIMENSIONS ARE IN MILLIMETERS UNLESS OTHERWISE SHOWN

**NOTE**  
ALL SIGNS AND LINES TO REMAIN UNLESS OTHERWISE NOTED.

**NOTE**  
CONTRACTOR TO LOCATE ALL HOUSE SERVICES, SUCH AS STORMWATER OUTLET, GAS, WATER, TELEPHONE, ETC. PRIOR TO CONSTRUCTION AND SERVICES TO BE LOWERED AS REQUIRED

**NOTE**  
WATER, SEWER, TELSTRA & ELECTRICITY SERVICES IN THE VICINITY OF WORKS, CONTRACTOR TO CONTACT SYDNEY WATER, TELSTRA & ENERGY AUSTRALIA PRIOR TO EXCAVATION

**NOTE**  
CONTRACTOR TO REINSTATE ALL KERB & GUTTER, ROAD PAVEMENT AND FOOTPATHS AFFECTED BY WORKS TO INNER WEST COUNCIL STANDARD AND TO THE SATISFACTION OF THE PROJECT MANAGER

**NOTE**  
SURFACE FITTINGS OF UNDERGROUND SERVICES ARE TO FINISH FLUSH WITH THE NEW SURFACES

## EROSION AND SEDIMENT CONTROL

### 1. GENERAL MEASURES

- STOCKPILES SHALL BE CONFINED TO ONE CENTRAL AREA WHERE POSSIBLE.
- EROSION CONTROL MEASURES TO BE IN PLACE PRIOR TO COMMENCEMENT OF ANY CONSTRUCTION WORK. MEASURES ARE APPLIED TO PROTECT ADJOINING PROPERTIES FROM EROSION AND SILT DAMAGE.
- EROSION CONTROL MEASURES NOT TO BE REMOVED UNTIL CONSTRUCTION IS COMPLETED AND SITE HAS BEEN REHABILITATED.
- REHABILITATION INCLUDES COMPLETION OF ALL CONSTRUCTION WORK AND LANDSCAPING, SEEDING OR TURFING OF ALL BATTERS AND FILL AREAS.
- PIPED DRAINAGE NETWORKS SHOULD BE INSTALLED AND CONNECTED AS EARLY AS POSSIBLE.
- ALL AREAS NOT SUBJECT TO CONSTRUCTION WORKS SHALL BE RETAINED FREE FROM DISTURBANCE OR DAMAGE DURING THE CURRENCY OF THE CONTRACT. SHOULD THESE AREAS BECOME DISTURBED OR DAMAGED, THEY SHALL BE RE-INSTATED BY THE CONTRACTOR AT NO COST TO THE PRINCIPAL.
- ALL AREAS NOT SUBJECT TO CONSTRUCTION WORKS SHALL BE RETAINED FREE FROM DISTURBANCE OR DAMAGE DURING THE CURRENCY OF THE CONTRACT. SHOULD THESE AREAS BECOME DISTURBED OR DAMAGED, THEY SHALL BE RE-INSTATED BY THE CONTRACTOR AT NO COST TO THE PRINCIPAL.

### 2. STABILISATION OF DISTURBED AREAS.

- STABILISATION OF DISTURBED AREAS SHALL BE IN ACCORDANCE WITH COUNCIL'S SPECIFICATION FOR GRASSING AND/OR SPECIFICATION FOR LANDSCAPE WORKS. THE FOLLOWING SHALL BE APPLIED FOR THE CONTROL OF EROSION AND SEDIMENTATION:-
  - STABILISATION OF DENUDE AREAS SHALL COMMENCE AS SOON AS POSSIBLE AFTER THE AREAS HAVE BEEN DISTURBED.
  - ALL STABILISATION MEASURES SHALL BE UNDERTAKEN PRIOR TO THE END OF THE MAINTENANCE PERIOD.

### 3. MAINTENANCE

- ALL SEDIMENT AND EROSION CONTROL DEVICES SHALL BE MAINTAINED IN A SATISFACTORY WORKING ORDER THROUGHOUT THE CONTRACT, MAINTENANCE AND DEFECTS LIABILITY PERIODS OR UNTIL SUCH EARLIER TIME AS THE AREA HAS BEEN STABILISED AND THE SUPERINTENDENT DIRECTS THAT THE DEVICE BE REMOVED.
- THE CONTRACTOR SHALL INSPECT ALL DEVICES AFTER EACH STORM FOR STRUCTURAL DAMAGE OR CLOGGING BY SILT AND OTHER DEBRIS AND MAKE PROMPT REPAIRS OR REPLACEMENT.

### 4. SEDIMENT CONTROL DEVICES (S.C.D.)

- THESE SHALL BE CONSTRUCTED AT INLETS TO STORMWATER SYSTEMS TO TRAP THE SEDIMENT IN RUNOFF. SECTIONS 11.3.02/03/04/06 OF THE N.S.W. DEPARTMENT OF HOUSING CONSTRUCTION SPECIFICATION, 1989 EDITION, SHALL APPLY.

## UNDERGROUND UTILITY SERVICES

- THE LOCATION OF UNDERGROUND UTILITY SERVICES SHOWN ON THIS PLAN ARE INDICATIVE ONLY. COUNCIL CANNOT GUARANTEE THEIR ACCURACY.
- PRIOR TO CONSTRUCTION, IT IS THE RESPONSIBILITY OF THE CONTRACTOR TO CARRY OUT THEIR OWN SERVICES SEARCH BY CONTACTING 'DIAL BEFORE YOU DIG' (PH: 1100 OR WWW.1100.COM.AU). THE CONTRACTOR MUST CHECK THE LOCATION AND DEPTH OF ALL SERVICES PRIOR TO THE COMMENCEMENT OF WORKS.
- ALL SERVICES AFFECTED BY NEW WORK TO BE ADJUSTED AS REQUIRED TO SUIT NEW SURFACE LEVELS. (TO THE REQUIREMENTS OF THE RELEVANT SERVICE AUTHORITY).
- NO SERVICE SURFACE FITTINGS ARE TO BE COVERED.
- ALL PERMITS REQUIRED MUST BE OBTAINED FROM THE RELEVANT SERVICE AUTHORITY PRIOR TO COMMENCEMENT OF WORKS.
- ANY DAMAGE TO SERVICES SHALL BE RECTIFIED BY THE CONTRACTOR OR THE RELEVANT AUTHORITY AT NO COST TO COUNCIL.

## PROTECTING SURVEY INFRASTRUCTURE

SURVEY MARKS SHALL BE PRESERVED AT ALL TIMES. WHERE PRESERVATION IS NOT POSSIBLE, THE PROJECT MANAGER SHALL BE NOTIFIED & CONSENT RECEIVED PRIOR TO THEIR REMOVAL. THE CONTRACTOR SHALL BE RESPONSIBLE FOR COMPLIANCE WITH THE SURVEYOR GENERAL'S DIRECTION NO.11 'PRESERVATION OF SURVEY INFRASTRUCTURE' AVAILABLE FROM LAND REGISTRY SERVICES NSW WEBSITE.

## CONCRETE

- ALL WORKMANSHIP AND MATERIALS SHALL BE IN ACCORDANCE WITH AS 3600 CURRENT EDITION WITH AMENDMENTS EXCEPT WHERE VARYED BY THE CONTRACT DOCUMENTS.
- CONCRETE QUALITY.

ELEMENT	SLUMP	MAX AGGREGATE SIZE	CEMENT TYPE	CEMENT GRADE
ALL	80mm	20mm	GP	25MPa

NO ADMIXTURES SHALL BE USED WITHOUT THE APPROVAL OF THE ENGINEER.

- CLEAR CONCRETE COVER TO REINFORCEMENT SHALL BE AS FOLLOWS UNLESS OTHERWISE SHOWN-

ELEMENT	SURFACE OF MEMBER IN INTERIOR ENVIRONMENT	SURFACE OF MEMBER IN ABOVE GROUND EXTERIOR ENVIRONMENT	SURFACE OF MEMBER IN CONTACT WITH GROUND (1)	SURFACE OF MEMBER IN WATER
ALL	35	45	55	75

- NOTE:**
- COVER MAY BE REDUCED BY 10mm IF THE SURFACE IS PROTECTED BY A DAMP-PROOF MEMBRANE.
  - SLABS EXPOSED TO CORROSIVE VAPOURS, CORROSIVE GROUND WATER, SEA WATER, OR SPRAY ARE TO HAVE REINFORCEMENT COVER AS NOTED ON THE DRAWINGS.

- SIZES OF CONCRETE ELEMENTS DO NOT INCLUDE THICKNESS OF APPLIED FINISHES.
- CONSTRUCTION JOINTS WHERE NOT SHOWN SHALL BE LOCATED TO THE APPROVAL OF THE ENGINEER.
- BEAM DEPTHS ARE WRITTEN FIRST AND INCLUDE SLAB THICKNESS IF ANY.

## LANDSCAPING PLANTING SCHEDULE

PLANT NAME	SPACING	QTY	POT SIZE	COMMENTS
GAZANIA TOMENTOSA	1/m <sup>2</sup>	24	140mm DIA	REFER SHEET 6

## SURVEY LEGEND

SYMBOLS	
[Symbol]	STATE SURVEY MARK
[Symbol]	PERMANENT SURVEY MARK
[Symbol]	SURVEY STATION
[Symbol]	DRILL HOLE & WING
[Symbol]	DRILLED HOLE
[Symbol]	SURVEY NAIL
[Symbol]	SIGN
[Symbol]	SILENT COP
[Symbol]	COLUMN
[Symbol]	BOLLARD
[Symbol]	HYDRANT
[Symbol]	POWER POLE
[Symbol]	LIGHT POLE
[Symbol]	ELECTRICITY & LIGHT POLE
[Symbol]	ELECTRICITY PILLAR
[Symbol]	PHONE BOOTH
[Symbol]	MAIL BOX
[Symbol]	TELECOMM. SERVICE COVER
[Symbol]	TELECOMMUNICATION PILLAR
[Symbol]	RUBBISH BIN
[Symbol]	MANHOLE (STORMWATER/SEWER)
[Symbol]	MANHOLE (TRIANGULAR/SQUARE)
[Symbol]	WATER STOP VALVE
[Symbol]	WATER METER
[Symbol]	GAS VALVE
[Symbol]	OPTUS PIT / RMS PIT
[Symbol]	PARKING METER
[Symbol]	UNKNOWN SERVICE COVER
[Symbol]	SEWER LAMP HOLE
[Symbol]	TRAFFIC LIGHT BOX
[Symbol]	TRAFFIC LIGHTS
[Symbol]	TREES / SHRUB

EXISTING SERVICES	
[Symbol]	DRAINAGE LINE
[Symbol]	ELECTRICITY
[Symbol]	GAS
[Symbol]	OIL PIPELINE
[Symbol]	SEWER
[Symbol]	TELECOM
[Symbol]	WATER
[Symbol]	OPTUS FIBER
[Symbol]	SUBSOIL
[Symbol]	NBN
[Symbol]	OPTUS
[Symbol]	OVERHEAD ELEC.
[Symbol]	O'HD ELEC & TEL
[Symbol]	UNKNOWN

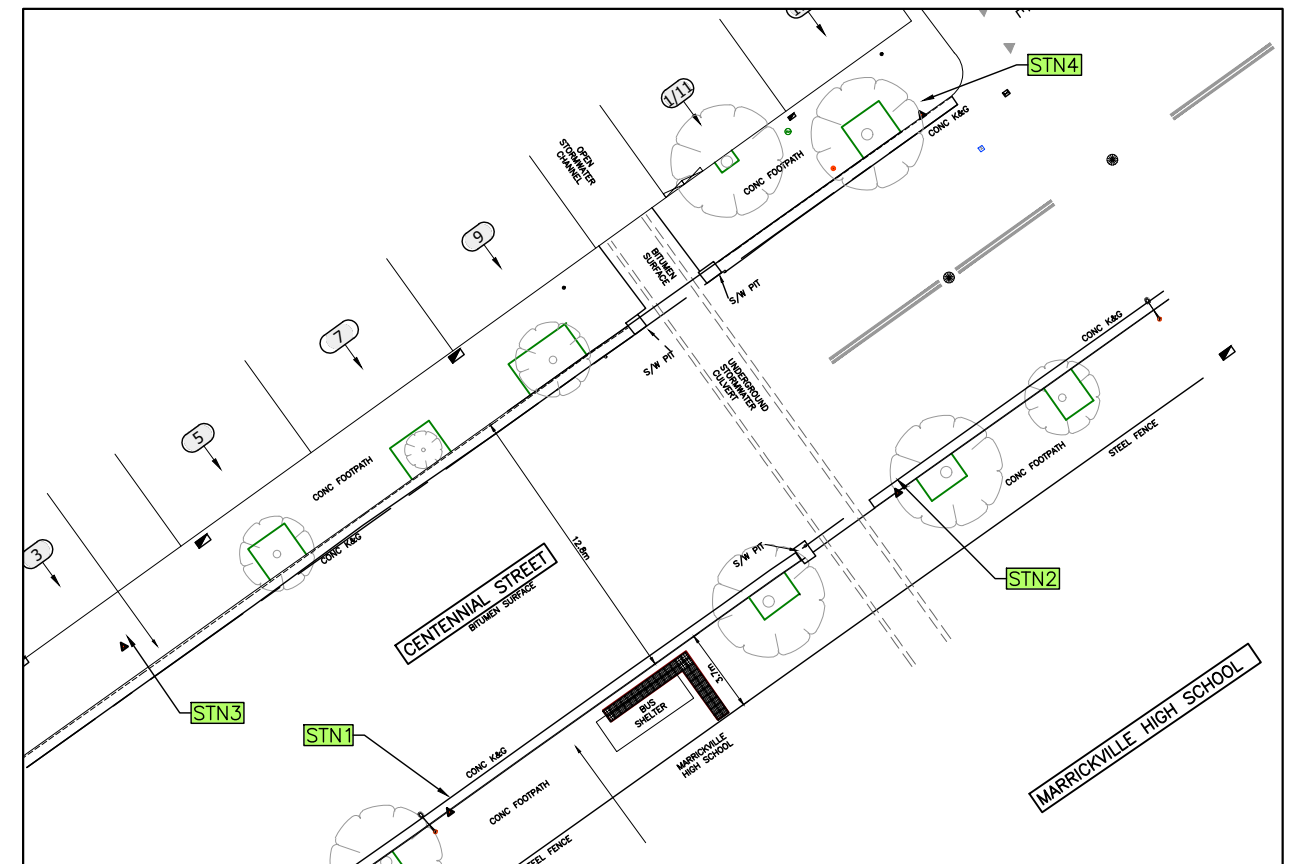

## SURVEY STATION PLAN

NOT TO SCALE

ISSUE FOR CONSTRUCTION

CHECKED & APPROVED 	SURVEYED BY ADAM DILLON 22-11-2022	<b>INNER WEST</b> 2-14 FISHER STREET, PETERSHAM NSW 2049 Ph. 02 9392 5000 Post: PO Box 14 PETERSHAM council@innerwest.nsw.gov.au Web: https://www.innerwest.nsw.gov.au	SURV. GEN. R.M.S. A.G.L. / SHELL PIPELINES SYDNEY WATER TELSTRA / OPTUS AUSGRD NOTICE OF ENTRY KERB & GUTTER	COORDINATE SYSTEM GDA2020	PROJECT NO. 303025	SHEET NO. 2 of 9
APPROVED FOR CONSTRUCTION 	DESIGNED BY SANJOY 12-07-2023		NOTICES	DATE	SCALES (ORIGINAL A1) N.A.	PLAN NO. 10233
<b>CENTENNIAL STREET, MARRICKVILLE</b>					<b>NEAR NO.9 &amp; NO.11 CENTENNIAL STREET</b>	
<b>PROPOSED STORMWATER UPGRADE</b>					<b>NOTES &amp; SCHEDULES</b>	

**SETOUT POINTS**

POINT #	EASTING	NORTHING
1	329506.325	6246849.424
2	329494.480	6246840.971
3	329492.159	6246839.315
4	329488.984	6246837.048
5	329482.070	6246846.756
6	329486.560	6246849.533
7	329487.370	6246850.534
8	329488.866	6246851.166
9	329490.249	6246852.145
10	329491.229	6246853.270
11	329492.495	6246853.724
12	329499.419	6246859.111

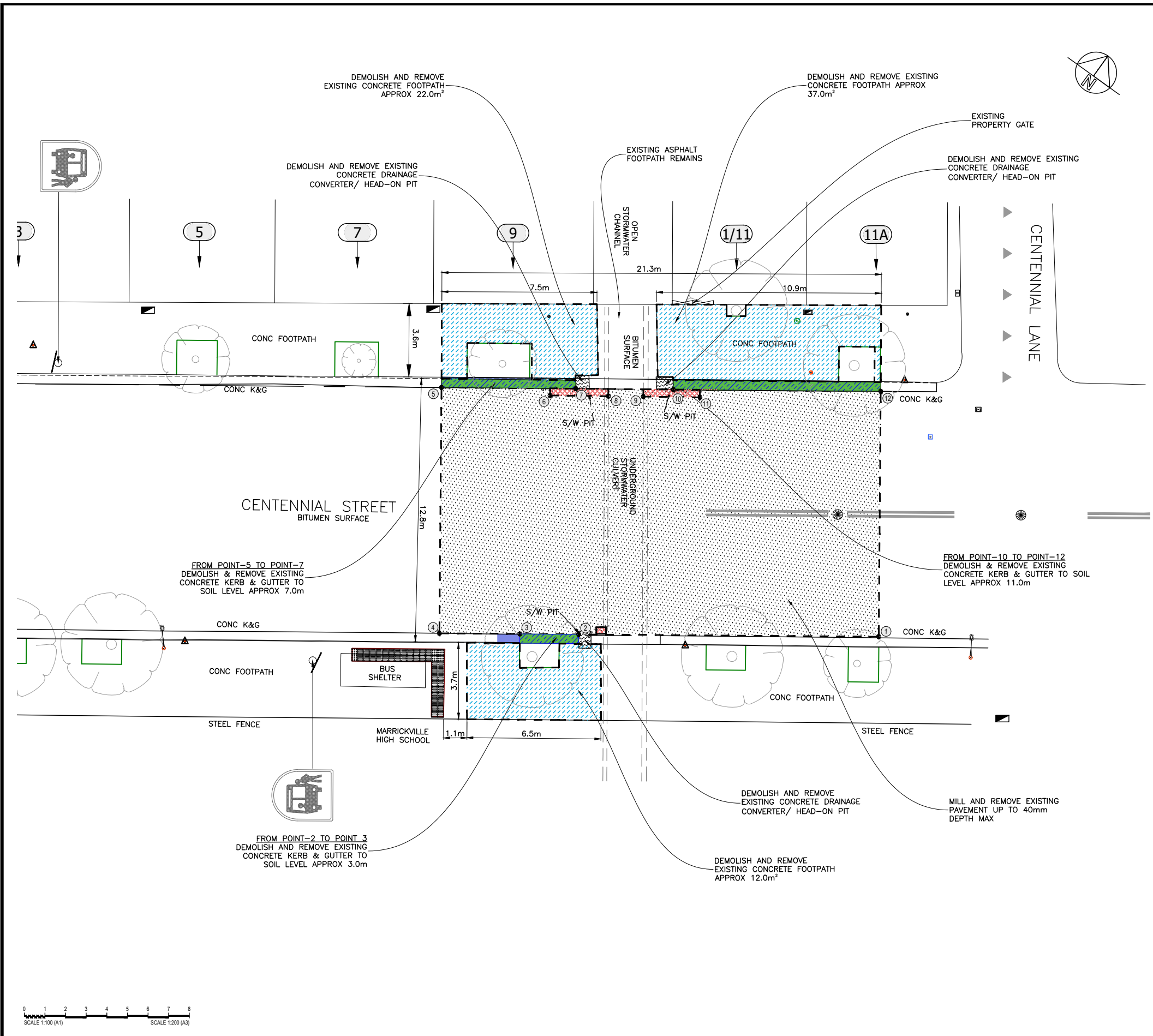

**DEMOLITION LEGEND**

	DENOTES 80m² EXISTING CONCRETE FOOTPATH REMOVAL
	DENOTES DISMANTLE AND REMOVE 21.0m EXISTING CONCRETE KERB & GUTTER FOR NEW CONCRETE KERB & GUTTER CONSTRUCTION
	DENOTES 255m² EXISTING ASPHALT ROAD PAVEMENT REMOVAL APPROX. 40mm DEPTH MAX
	DENOTES 3 No. EXISTING PIT REMOVAL
	DENOTES TRENCHING & REMOVAL OF EXISTING ROAD PAVEMENT UP TO DEPTH OF PROPOSED STORMWATER PIPE APPROX 3.0m²

ISSUE FOR CONSTRUCTION

CHECKED & APPROVED  APPROVED FOR CONSTRUCTION 	SURVEYED BY ADAM DILLON 22-11-2022	<b>INNER WEST</b> 2-14 FISHER STREET, PETERSHAM NSW 2049 Ph. 02 9392 5000 Post: PO Box 14 PETERSHAM council@innerwest.nsw.gov.au Web: https://www.innerwest.nsw.gov.au		SURV. GEN. R.M.S. A.G.L. / SHELL PIPELINES SYDNEY WATER TELSTRA / OPTUS AUSGRID NOTICE OF ENTRY KERB & GUTTER NOTICES DATE	COORDINATE SYSTEM GDA2020 SCALES (ORIGINAL A1) 1:100	CENTENNIAL STREET, MARRICKVILLE NEAR NO.9 & NO.11 CENTENNIAL STREET PROPOSED STORMWATER UPGRADE DEMOLITION PLAN	PROJECT NO. 303025	SHEET NO. 3 of 9
	DESIGNED BY SANJOY 12-07-2023			DRAWN BY SANJOY 14-07-2023	REV. DATE DESCRIPTION APPROV.		PLAN NO. 10233	SHEET REV #

\\file001\innerwest.nsw.gov.au\assets\Environment\GIS\CD\24\512\SU\303025-MAR-11\CentennialSt-Pit&PipeUpgrade(10233).L1.DESIGN\12\_FinalDesign(100%)\Docs\303025-10233-Plan.dwg



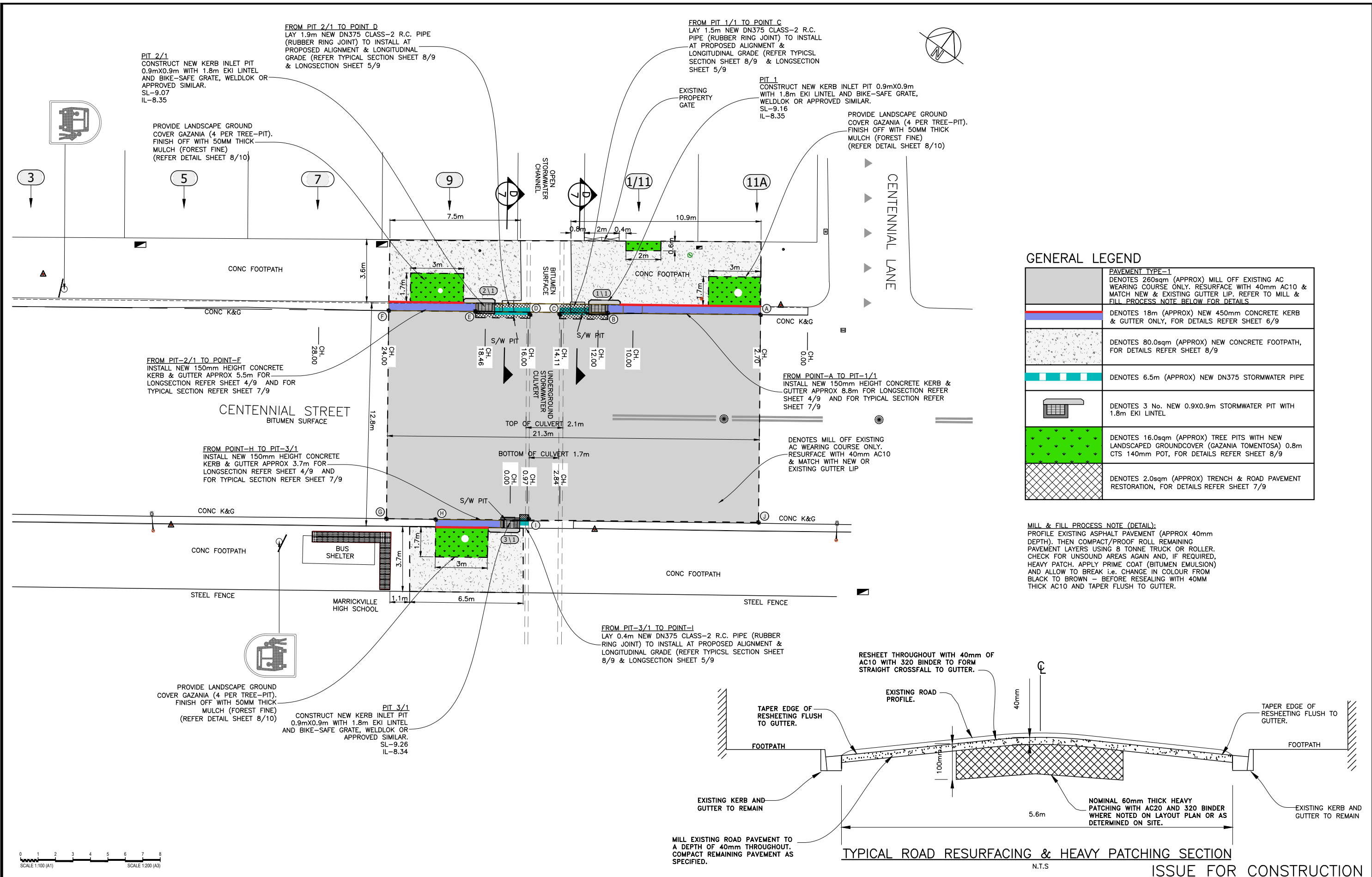

**GENERAL LEGEND**

	<b>PAVEMENT TYPE-1</b> DENOTES 260sqm (APPROX) MILL OFF EXISTING AC WEARING COURSE ONLY. RESURFACE WITH 40mm AC10 & MATCH NEW & EXISTING GUTTER LIP. REFER TO MILL & FILL PROCESS NOTE BELOW FOR DETAILS
	DENOTES 18m (APPROX) NEW 450mm CONCRETE KERB & GUTTER ONLY, FOR DETAILS REFER SHEET 6/9
	DENOTES 80.0sqm (APPROX) NEW CONCRETE FOOTPATH, FOR DETAILS REFER SHEET 8/9
	DENOTES 6.5m (APPROX) NEW DN375 STORMWATER PIPE
	DENOTES 3 No. NEW 0.9X0.9m STORMWATER PIT WITH 1.8m EKI LINTEL
	DENOTES 16.0sqm (APPROX) TREE PITS WITH NEW LANDSCAPED GROUND COVER (GAZANIA TOMENTOSA) 0.8m CTS 140mm POT, FOR DETAILS REFER SHEET 8/9
	DENOTES 2.0sqm (APPROX) TRENCH & ROAD PAVEMENT RESTORATION, FOR DETAILS REFER SHEET 7/9

**MILL & FILL PROCESS NOTE (DETAIL):**  
 PROFILE EXISTING ASPHALT PAVEMENT (APPROX 40mm DEPTH). THEN COMPACT/PROOF ROLL REMAINING PAVEMENT LAYERS USING 8 TONNE TRUCK OR ROLLER. CHECK FOR UNSOUND AREAS AGAIN AND, IF REQUIRED, HEAVY PATCH. APPLY PRIME COAT (BITUMEN EMULSION) AND ALLOW TO BREAK i.e. CHANGE IN COLOUR FROM BLACK TO BROWN - BEFORE RESEALING WITH 40MM THICK AC10 AND TAPER FLUSH TO GUTTER.

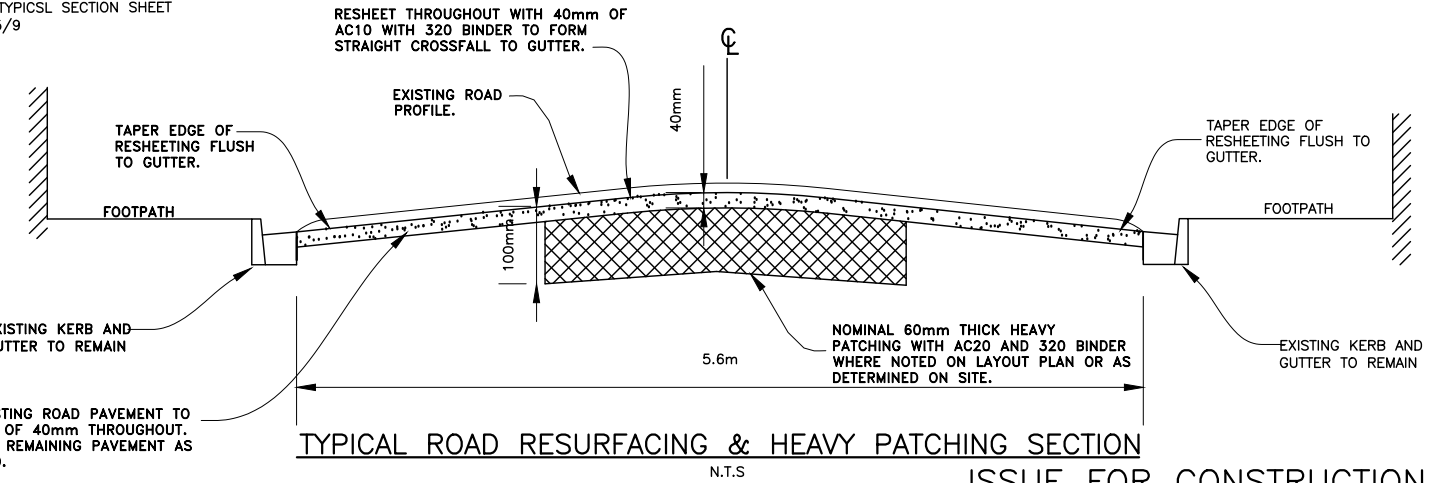

CHECKED & APPROVED  APPROVED FOR CONSTRUCTION 	SURVEYED BY ADAM DILLON 22-11-2022	 2-14 FISHER STREET, PETERSHAM NSW 2049 Ph. 02 9392 5000 Post: PO Box 14 PETERSHAM council@innerwest.nsw.gov.au Web: https://www.innerwest.nsw.gov.au	 SURV. GEN. R.M.S. A.G.L. / SHELL PIPELINES SYDNEY WATER TELSTRA / OPTUS AUSGRD NOTICE OF ENTRY KERB & GUTTER NOTICES DATE	COORDINATE SYSTEM GDA2020 SCALES (ORIGINAL A1) 1:100	CENTENNIAL STREET, MARRICKVILLE NEAR NO.9 & NO.11 CENTENNIAL STREET PROPOSED STORMWATER UPGRADE CIVIL & DRAINAGE PLAN	PROJECT NO. 303025	SHEET NO. 4 of 9
	DESIGNED BY SANJOY 12-07-2023					DRAWN BY SANJOY 14-07-2023	PLAN NO. 10233

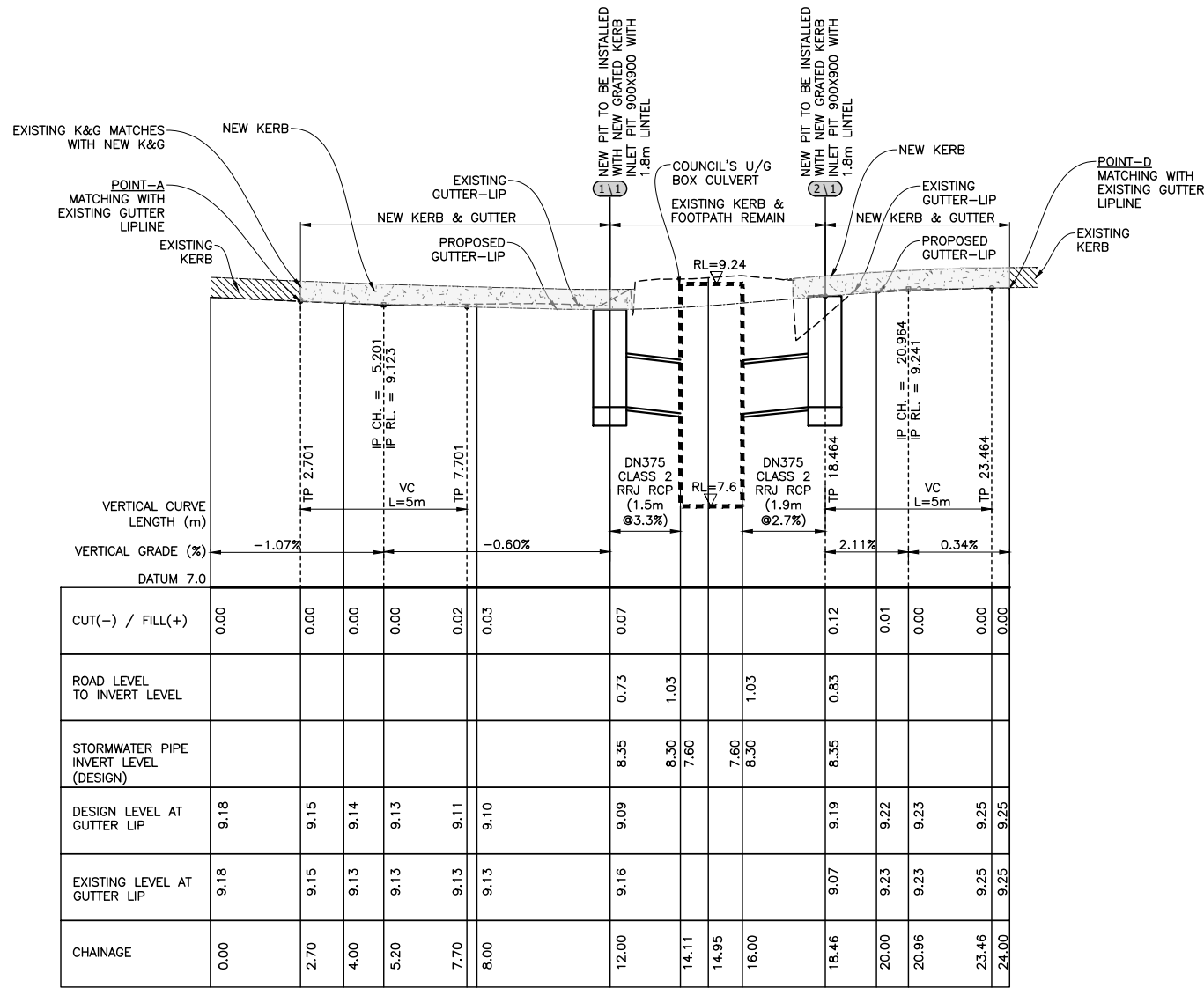

**LONGSECTION DRAINAGE LINE 1&2**  
 SCALES: HORIZONTAL 1:100 VERTICAL 1:25

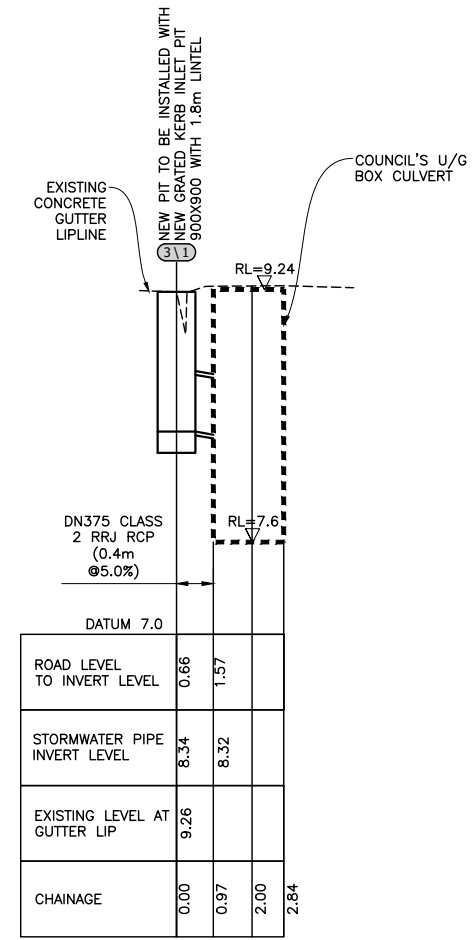

**LONGSECTION DRAINAGE LINE 3**  
 SCALES: HORIZONTAL 1:100 VERTICAL 1:25

CUT(-) / FILL(+)	ROAD LEVEL TO INVERT LEVEL	STORMWATER PIPE INVERT LEVEL (DESIGN)	DESIGN LEVEL AT GUTTER LIP	EXISTING LEVEL AT GUTTER LIP	CHAINAGE
0.00			9.18	9.18	0.00
0.00			9.15	9.15	2.70
0.00			9.14	9.13	4.00
0.00			9.13	9.13	5.20
0.02			9.11	9.13	7.70
0.03			9.10	9.13	8.00
0.07	0.73	8.35	9.09	9.16	12.00
	1.03	8.30			14.11
	1.03	7.60			14.95
	0.83	7.60			16.00
0.12	0.83	8.35	9.19	9.07	18.46
0.01			9.22	9.23	20.00
0.00			9.23	9.23	20.96
0.00			9.25	9.25	23.46
0.00			9.25	9.25	24.00

ROAD LEVEL TO INVERT LEVEL	STORMWATER PIPE INVERT LEVEL	EXISTING LEVEL AT GUTTER LIP	CHAINAGE
0.66	8.34	9.26	0.00
1.57	8.32		0.97
			2.00
			2.84

**DRAINAGE PIT SCHEDULE**

PIT No.	PIT TYPE	INTERNAL DIMENSIONS (mm)	FINISHED SURFACE RL (m)	PIT INVERT RL (m)	INLET DIAMETER (mm)	INLET INVERT RL (m)	OUTLET DIAMETER (mm)	OUTLET INVERT RL (m)	EASTING (m)	NORTHING (m)
111	NEW CONCRETE KERB INLET PIT WITH 1.8m EKI LINTEL, STEP IRONS	900X900	9.09	8.35	N.A.	N.A.	375	8.30	329491.742	6246853.874
211	NEW CONCRETE KERB INLET PIT WITH 1.8m EKI LINTEL, STEP IRONS	900X900	9.19	8.35	N.A.	N.A.	375	8.30	329485.786	6246849.641
311	NEW CONCRETE KERB INLET PIT WITH 1.8m EKI LINTEL, STEP IRONS	900X900	9.26	8.34	N.A.	N.A.	375	8.32	329494.882	6246840.982

**DRAINAGE PIPE SCHEDULE**

PIPE ID	PIPE SIZE	LENGTH	GRADE	MIN. COVER	MAX. COVER
1	DN375 CLASS 2 RRJ RCP	1.5	3.3%	0.33	0.57
2	DN375 CLASS 2 RRJ RCP	1.9	2.7%	0.43	0.57
3	DN375 CLASS 2 RRJ RCP	0.4	5.0%	0.52	0.56

\* ASSUMED LEVEL FOR SERVICES  
 THESE ARE ASSUMED LEVELS AS  
 OBTAINED FROM GPR SERVICE LOCATOR

**ISSUE FOR CONSTRUCTION**

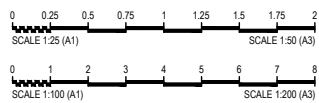

CHECKED & APPROVED  SURVEYED BY ADAM DILLON 22-11-2022 DESIGNED BY SANJOY 12-07-2023 APPROVED FOR CONSTRUCTION  DRAWN BY SANJOY 14-07-2023	<b>INNER WEST</b> 2-14 FISHER STREET, PETERSHAM NSW 2049 Ph. 02 9392 5000 Post: PO Box 14 PETERSHAM council@innerwest.nsw.gov.au Web: https://www.innerwest.nsw.gov.au	SURV. GEN. R.M.S. A.G.L. / SHELL PIPELINES SYDNEY WATER TELSTRA / OPTUS AUSGRID NOTICE OF ENTRY KERB & GUTTER NOTICES DATE	COORDINATE SYSTEM GDA2020 SCALES (ORIGINAL A1) (H) 1:100 (V) 1:25	PROJECT NO. <b>303025</b> SHEET NO. <b>5 of 9</b> PLAN NO. <b>10233</b> SHEET REV #
		CENTENNIAL STREET, MARRICKVILLE NEAR NO.9 & NO.11 CENTENNIAL STREET PROPOSED STORMWATER UPGRADE DRAINAGE LONGSECTIONS		

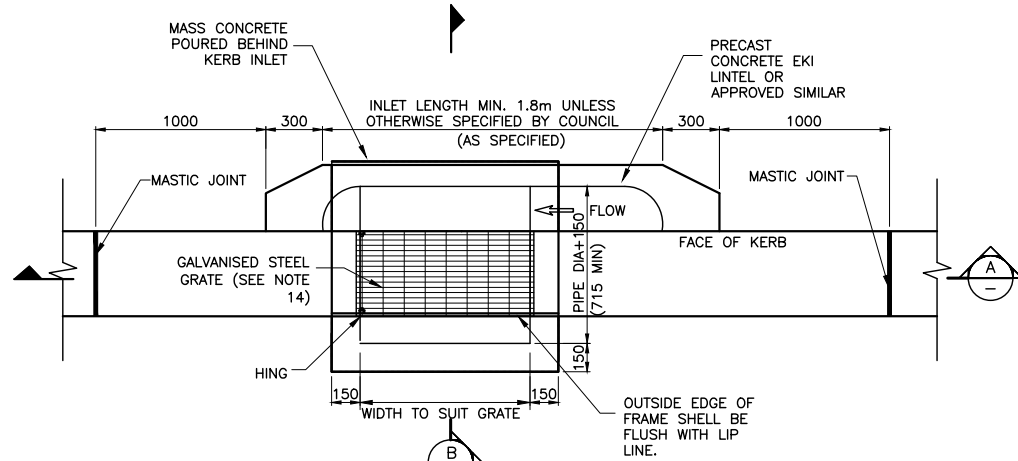

PLAN (PIT 1,2,3)  
SCALE 1:20

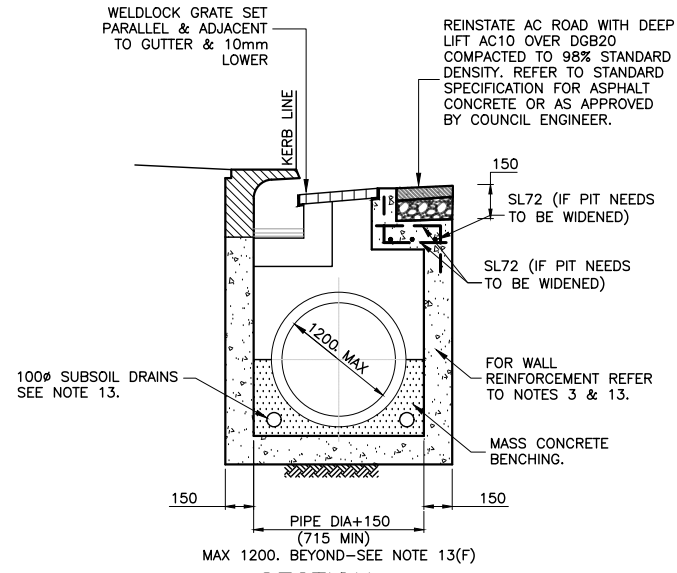

SECTION B  
NOT TO SCALE

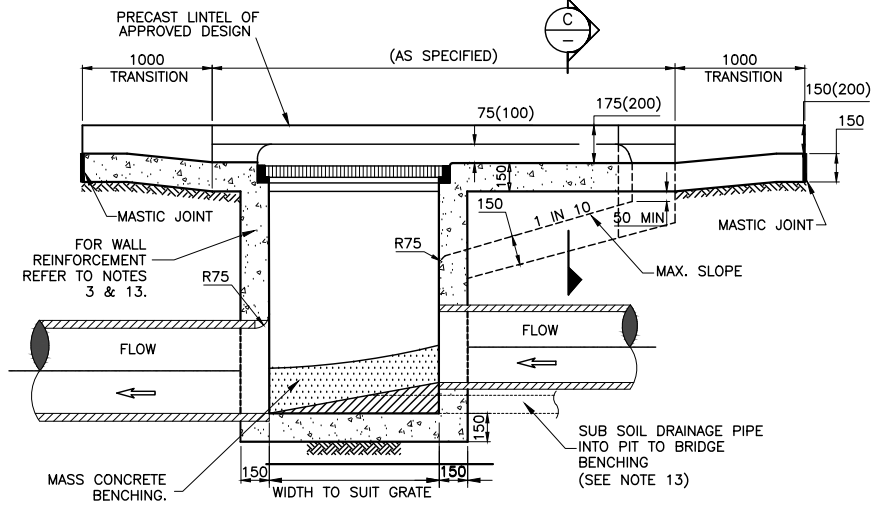

SECTION A  
SCALE 1:20

NOTE: PLAN BASED ON 150 KERB (FIGURES IN BRACKETS - 200 KERB)

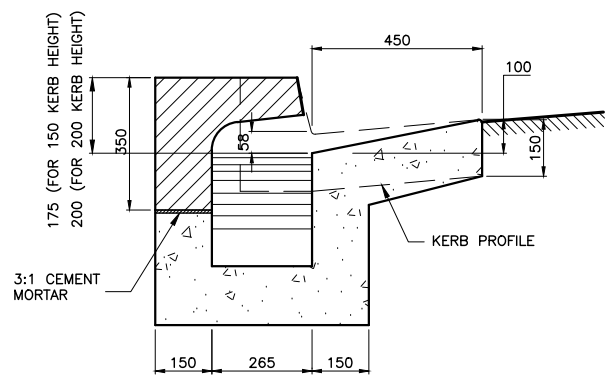

SECTION C  
SCALE 1:10

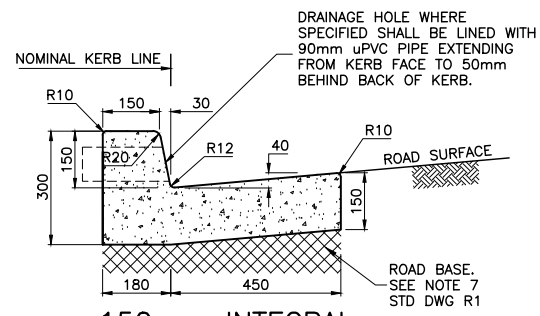

150mm INTEGRAL KERB & GUTTER  
SCALE 1:10

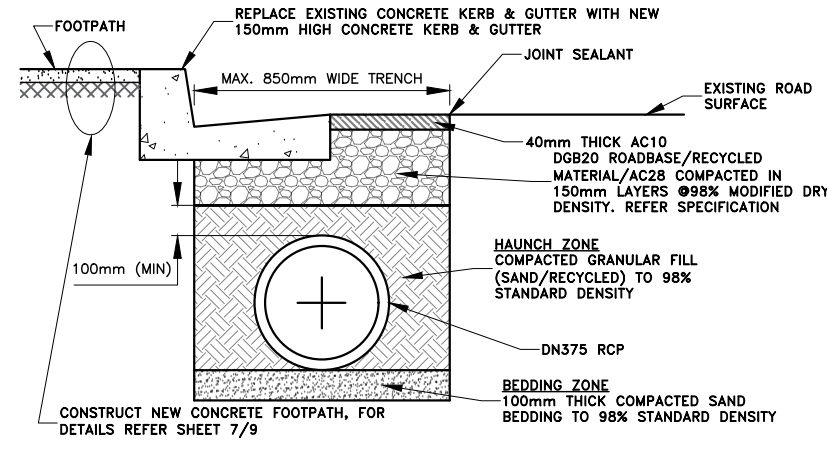

TYPICAL PIPE INSTALLATION AND FLEXIBLE ROAD PAVEMENT  
SCALE: 1:20

SECTION D

**DRAINAGE NOTES 1:**

1. **CONCRETE STRENGTH**
  - A) KERB, KERB & GUTTER, FOOTPATH, CYCLEWAY, VEHICLE CROSSING, PRAM RAMP, EDGE STRIP: 25MPA @ 28 DAYS
  - B) DISH CROSSING, ROAD PLATFORM/HUMP, ROAD SLAB: 40MPA @ 28 DAYS
  - C) PIT: 25MPA @ 28 DAYS
  - D) FOR TRAFFICKED AREAS WHERE FACILITY MUST BE OPEN TO TRAFFIC WITHIN 12 HOURS (EG VEHICLE CROSSING, ROAD SLAB, DISH CROSSING, ROAD PLATFORM/HUMP): 40 MPA WITH ACCELERATOR SUCH AS 2% CACL (REFER TO SP40HC).
2. **CONCRETE FINISH**
  - A) KERB, GUTTER, LAYBACK, DISH CROSSING, PIT (OUTER EXPOSED) - STEEL TROWEL
  - B) VEHICLE CROSSINGS, FOOTPATH, CYCLEWAY, ROAD SLABS, PRAM RAMP, ROAD HUMPS/RAMPS - BROOM/BRUSH.
  - C) PIT (INTERNAL): WOOD FLOAT.
  - D) ALL GAPS AND SPACES IN THE CONCRETE SHELL BE RENDERED SMOOTH. A.G. GAPS AROUND ALL PIPES, UNDER GRATES/LIDS AND LINTELS AND BETWEEN CONCRETE POURS.
3. **REINFORCEMENT**
  - A) TO AS 4671
  - B) MINIMUM COVER: 50MM
4. **EXCAVATION**
  - A) AT ALL JOINS TO EXISTING CONCRETE/ASPHALT - THE JOIN SHALL BE SAW CUT BEFORE EXCAVATION.
  - B) ALL EXCAVATED MATERIAL SHALL BE REMOVED FROM THE SITE AND DISPOSED OF AT A LICENSED WASTE DISPOSAL FACILITY.
5. **ROAD BASE**
  - A) COMPACTION: 95% STANDARD.
  - B) RECYCLED DGB SPECIFICATION: FOR SUPPLY OF RECYCLED MATERIAL FOR PAVEMENTS, EARTHWORKS, AND DRAINAGE REFER TO SPECIFICATION FOR SUPPLY OF RECYCLED MATERIAL FOR PAVEMENTS, EARTHWORKS AND DRAINAGE BY IPWEA (NSW) (LATEST EDITION).
6. **RESTORATION OF ADJOINING ROAD PAVEMENT AND EXCAVATION BACKFILL**
  - A) SEE STANDARD PLAN D7.
7. **UTILITIES SERVICES & SURVEY MARKS**
  - A) ALL UNDERGROUND UTILITY SERVICES SHALL BE CHECKED FOR LEVEL AND LOCATION PRIOR TO COMMENCEMENT OF WORKS, BY THE CONTRACTOR.
  - B) ALL SERVICE COVERS AFFECTED BY THE WORKS SHALL BE ADJUSTED AS REQUIRED AND TO SUIT THE LEVELS OF THE NEW WORK. NO SERVICE FITTINGS SHALL BE COVERED.
  - C) PROPERTY STORMWATER PIPES: WHERE AFFECTED, SHALL BE REPLACED WITH 90MM UPVC OR TO SUIT EXISTING AND INVERT SHALL MATCH THE GUTTER LEVEL.
  - D) STATE SURVEY MARKS (SSMS) - SHALL NOT BE DISTURBED UNLESS APPROVED BY THE COUNCIL ENGINEER.
  - E) AT ALL LIGHT/POWER POLES, THE CONCRETE SHALL BE ENDED 150MM CLEAR OF THE POLE AND THE GAP FILLED WITH 30MM OF 10MM COLDMIX/ASPHALTIC CONCRETE.
8. **NATURE STRIP RESTORATION**
  - A) MATCH EXISTING TURF.
  - B) IF NEW TURF IS SPECIFIED - USE SOFT LEAF BUFFALO 'SHADEMASTER', LAID ON 100MM THICK PREPARED TOPSOIL, AS SPECIFIED BY THE COUNCIL ENGINEER.
9. **EXISTING SIGNAGE**
  - A) SUCH SIGNAGE SHALL BE REINSTATED UNLESS THE COUNCIL ENGINEER ADVISES OTHERWISE.
  - B) SIGNS REPLACED OR NEW, WITHIN THE NEW CONCRETE SHALL BE INSTALLED WITH A V-LOCK.
  - C) HERITAGE STREET NAME SIGNS EMBEDDED IN FOOTPATH PAVING AND KERBS - CAUTION SHALL BE EXERCISED TO NOT DAMAGE THESE SIGNS AND THE CONTRACTOR SHALL LIAISE WITH THE COUNCIL ENGINEER TO DETERMINE WHAT ACTION TO IMPLEMENT WHERE DISTURBANCE OF THE SIGN IS ESSENTIAL.
10. **ASPHALTIC CONCRETE**
  - A) SHALL CONFORM TO RMS SPECIFICATION R116 - 'ASPHALT (DENSE AND OPEN GRADED)'.
11. **RESIDENT NOTIFICATION**
  - A) ALL RESIDENTS AFFECTED BY THE WORKS SHALL BE NOTIFIED AT LEAST 2 WORKING DAYS BEFORE THE RELEVANT WORK COMMENCES AND ANY REASONABLE REQUESTS ACCOMMODATED.
12. **SAFETY/SIGNAGE/ACCESS**
  - A) DURING CONSTRUCTION, ADEQUATE WARNING SIGNS AND BARRICADING SHALL BE PROVIDED TO ENSURE THAT THE WORK SITE MEETS THE REQUIREMENTS OF AS 1742.2 & 1743.3, AND TO PROVIDE ADEQUATE PROTECTION TO PEDESTRIANS & MOTORISTS.
  - B) ADEQUATE AND SAFE ACCESS FOR PEDESTRIANS SHALL BE PROVIDED AT ALL TIMES.
  - C) AT DRIVEWAYS - PREVENTION OF ACCESS SHALL BE KEPT TO AN ABSOLUTE MINIMUM AND ARRANGEMENTS SHALL BE MADE WITH THE RESIDENT/BUSINESS, BY THE CONTRACTOR, FOR A SUITABLE DAY/TIME FOR THIS WORK. USE OF HIGHER STRENGTH CONCRETE, WITH SHORTER CURING TIME MAY BE NECESSARY.
13. **PIT DETAILS**
  - A) PROVIDE STEP IRONS WHERE PIT IS DEEPER THAN 1.0M - REFER TO STANDARD PLAN D6.
  - B) TOP OF BENCHING SHALL BE HALF OF OUTLET PIPE DIAMETER.
  - C) 100MM DIA CORRUGATED SUBSOIL PIPE, 3M LONG, WRAPPED IN FILTER FABRIC, SHALL BE PROVIDED AT THE INVERT LEVEL ON BOTH SIDES OF EVERY INLET PIPE.
  - D) WHERE POSSIBLE, LOCATE LINTELS CENTRALLY IN SAG POINTS.
  - E) APPROVED PRECAST CONCRETE PITS (PART OR TOTAL) MAY BE USED IN ACCORDANCE WITH THE MANUFACTURERS INSTRUCTIONS.
  - F) WHERE THE EXTENDED CHAMBER WIDTH EXCEEDS 1.2M, PIT REINFORCEMENT SHALL BE DESIGNED BY A PROFESSIONAL ENGINEER.
  - G) FOR PIT DEPTHS LESS THAN 1.5M, NO REINFORCEMENT IS REQUIRED. FOR PIT DEPTHS BETWEEN 1.5M AND 3.0M, PROVIDE SL72 AT 50MM COVER TO INSIDE FACE WALLS AND BASE. PROVIDE 400MM LAP AT CORNERS. FOR PIT DEPTHS GREATER THAN 3.0, DESIGN IS REQUIRED BY A PROFESSIONAL ENGINEER.
  - H) FOR JUNCTION AND SURCHARGE PITS, THE MINIMUM INTERNAL DIMENSIONS SHALL BE:
    - (i) DEPTH LESS THAN 1800MM - 900x900MM UNLESS OTHERWISE APPROVED BY COUNCIL.
    - (ii) DEPTH GREATER THAN 1800MM - REFER TO STANDARD PLAN D3.
14. **STORMWATER PIT GRATES**
  - A) SHALL BE WELDLOCK HINGED HOT DIPPED GALVANISED GG78-50 (OR APPROVED EQUIVALENT), SET PARALLEL TO GUTTER, AND WITH LOCKING CLIP. FOR INDUSTRIAL ROADS AND WHERE DIRECTED BY THE COUNCIL ENGINEER, USE WELDLOCK HINGED HOT DIPPED GALVANISED GG78-42A (OR APPROVED EQUIVALENT).
  - B) THE GRATE WHEN OPEN SHALL CLEAR THE LINTEL/KERB.
15. **DIMENSIONS**
  - A) ALL DIMENSIONS ARE IN MILLIMETERS UNLESS SHOWN OTHERWISE.
16. **GENERAL**
  - A) ALL WORKS SHALL BE CARRIED OUT TO COUNCIL'S SPECIFICATION, TO BEST PRACTICE STANDARDS, AND TO THE SATISFACTION OF COUNCIL'S SUPERVISING ENGINEER.
  - B) THE WORK SITE SHALL BE KEPT IN A CLEAN, TIDY, AND SAFE CONDITION AT ALL TIMES AND TO THE SATISFACTION OF COUNCIL'S ENGINEER.
17. **DOCUMENT PRIORITY**
  - A) THIS PLAN SUPERSEDES ANY STATEMENTS ON OTHER DOCUMENTS, EG SPECIFICATIONS, OTHER PLANS, ETC, UNLESS ADVISED BY THE COUNCIL ENGINEER.
18. **INSPECTIONS**

INSPECTIONS BY THE COUNCIL SUPERVISING ENGINEER SHALL BE REQUIRED AT THE FOLLOWING STAGES AND AS OTHERWISE DIRECTED BY THE COUNCIL ENGINEER:-

  - A) EXCAVATION COMPLETED.
  - B) PITS FORMED
  - C) BASE AND WALLS OF PITS POURED.
  - D) LINTELS AND GRATES PLACES AND FORMWORK IN PLACE.
  - E) TOTALLY COMPLETED.

ISSUE FOR CONSTRUCTION

CHECKED & APPROVED  SURVEYED BY ADAM DILLON 22-11-2022 DESIGNED BY SANJOY 12-07-2023 DRAWN BY SANJOY 14-07-2023	 2-14 FISHER STREET, PETERSHAM NSW 2049 Ph. 02 9392 5000 Post: PO Box 14 PETERSHAM council@innerwest.nsw.gov.au Web: https://www.innerwest.nsw.gov.au		SURV. GEN.	COORDINATE SYSTEM	CENTENNIAL STREET, MARRICKVILLE NEAR NO.9 & NO.11 CENTENNIAL STREET PROPOSED STORMWATER UPGRADE TYPICAL DETAILS 01	PROJECT NO.	SHEET NO.
			R.M.S. A.G.L. / SHELL PIPELINES SYDNEY WATER TELSTRA / OPTUS AUSGRD NOTICE OF ENTRY KERB & GUTTER	GDA2020 SCALES (ORIGINAL A1) AS SHOWN		303025	6 of 9
			NOTICES	DATE		PLAN NO.	SHEET REV #
						10233	



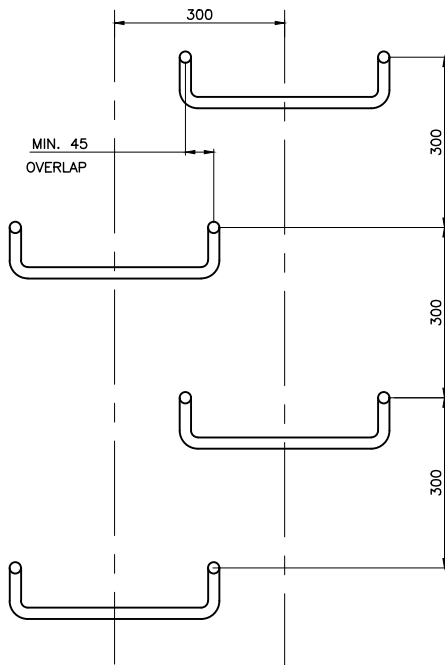

**STEP IRON PLACEMENT DIAGRAM**  
NOT TO SCALE

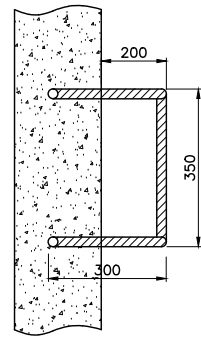

**TOP VIEW**  
NOT TO SCALE

**DRAINAGE NOTES 2:**

- PITS DEEPER THAN 1.0m SHALL BE FITTED WITH STEP IRONS.
- STEP IRONS SHOULD ONLY BE USED WHERE THE VERTICAL WALL HEIGHT DOES NOT EXCEED 6m.
- STEP IRONS SHALL BE LOCATED:
  - DIRECTLY ON A WALL WITHOUT PIPE OPENINGS.
  - DESIRABLY ON ONE OF THE LONG SIDES OF THE PIT.
  - DIRECTLY BELOW THE OPENING OF THE COVER.
- STEP IRONS SHALL BE OF MATERIAL GIVING EQUIVALENT PERFORMANCE TO 24mm DIAMETER SOLID LOW-CARBON STEEL AND SHALL HAVE A TREAD DEPTH OF NOT LESS THAN 24mm.
- ALL BENDS TO BE FORMED AROUND 12mmØ PIN.
- STEP IRONS SHALL HAVE SHARP EDGES ROUNDED AND HOT DIP GALVANISED AFTER FABRICATION.
- MATERIAL FOR STEP IRONS SHALL BE STRUCTURAL GRADE 250 TO AS3679
- ALL DIMENSIONS ARE IN MILLIMETRES UNLESS OTHERWISE SHOWN.

**DRAINAGE NOTES 6:**

- CONCRETE STRENGTH**
  - KERB, KERB & GUTTER, FOOTPATH, CYCLEWAY, VEHICLE CROSSING, PRAM RAMP, EDGE STRIP: 25MPA @ 28 DAYS
  - DISH CROSSING, ROAD PLATFORM/HUMP, ROAD SLAB: 40MPA @ 28 DAYS
  - PIT: 25MPA @ 28 DAYS
  - FOR TRAFFICKED AREAS WHERE FACILITY MUST BE OPEN TO TRAFFIC WITHIN 12 HOURS (EG VEHICLE CROSSING, ROAD SLAB, DISH CROSSING, ROAD PLATFORM/HUMP: 40 MPA WITH ACCELERATOR SUCH AS 2% CACL (REFER TO SP40HC).
- CONCRETE FINISH**
  - KERB, GUTTER, LAYBACK, DISH CROSSING, PIT (OUTER EXPOSED) – STEEL TROWEL
  - VEHICLE CROSSINGS, FOOTPATH, CYCLEWAY, ROAD SLABS, PRAM RAMP, ROAD HUMPS/RAMPS – BROOM/BRUSH.
  - PIT (INTERNAL): WOOD FLOAT.
- STORMWATER OUTLETS**
  - UPVC
    - MINIMUM 90mm DIAMETER
    - SEWER GRADE
    - MINIMUM GRADE 1%
  - RHS
    - MINIMUM 200x45x3mm
    - STEEL TO AS4671
    - HOT DIPPED GALVANISED INSIDE AND OUT TO AS4680
    - MINIMUM GRADE 1%
- EXCAVATION**
  - AT ALL JOINS TO EXISTING CONCRETE/ASPHALT – THE JOIN SHALL BE SAW CUT BEFORE EXCAVATION.
  - ALL EXCAVATED MATERIAL SHALL BE REMOVED FROM THE SITE AND DISPOSED OF AT A LICENSED WASTE DISPOSAL FACILITY.
- UTILITIES, SERVICES & SURVEY MARKS**
  - ALL UNDERGROUND UTILITY SERVICES SHALL BE CHECKED FOR LEVEL AND LOCATION PRIOR TO COMMENCEMENT OF WORKS, BY THE CONTRACTOR.
  - ALL SERVICE COVERS AFFECTED BY THE WORKS SHALL BE ADJUSTED AS REQUIRED AND TO SUIT THE LEVELS OF THE NEW WORK. NO SERVICE FITTINGS SHALL BE COVERED.
  - PROPERTY STORMWATER PIPES: WHERE AFFECTED, SHALL BE REPLACED WITH 90MM UPVC OR TO SUIT EXISTING AND INVERT SHALL MATCH THE GUTTER LEVEL.
  - STATE SURVEY MARKS (SSM'S) – SHALL NOT BE DISTURBED UNLESS APPROVED BY THE COUNCIL ENGINEER.
  - AT ALL LIGHT/POWER POLES, THE CONCRETE SHALL BE ENDED 150MM CLEAR OF THE POLE AND THE GAP FILLED WITH 30MM OF 10MM COLDMIX/ASPHALTIC CONCRETE.
- NATURE STRIP RESTORATION**
  - MATCH EXISTING TURF.
  - IF NEW TURF IS SPECIFIED – USE SOFT LEAF BUFFALO 'SHADEMASTER', LAID ON 100MM THICK PREPARED TOPSOIL, AS SPECIFIED BY THE COUNCIL ENGINEER.
- EXISTING SIGNAGE**
  - SUCH SIGNAGE SHALL BE REINSTATED UNLESS THE COUNCIL ENGINEER ADVISES OTHERWISE.
  - SIGNS REPLACED OR NEW, WITHIN THE NEW CONCRETE SHALL BE INSTALLED WITH A V-LOCK.
  - HERITAGE STREET NAME SIGNS EMBEDDED IN FOOTPATH PAVING AND KERBS – CAUTION SHALL BE EXERCISED TO NOT DAMAGE THESE SIGNS AND THE CONTRACTOR SHALL LIAISE WITH THE COUNCIL ENGINEER TO DETERMINE WHAT ACTION TO IMPLEMENT WHERE DISTURBANCE OF THE SIGN IS ESSENTIAL.
- ASPHALTIC CONCRETE**
  - SHALL CONFORM TO RMS SPECIFICATION R116 – 'ASPHALT (DENSE AND OPEN GRADED)'.
- RESIDENT NOTIFICATION**
  - ALL RESIDENTS AFFECTED BY THE WORKS SHALL BE NOTIFIED AT LEAST 2 WORKING DAYS BEFORE THE RELEVANT WORK COMMENCES AND ANY REASONABLE REQUESTS ACCOMMODATED.
- SAFETY/SIGNAGE/ACCESS**
  - DURING CONSTRUCTION, ADEQUATE WARNING SIGNS AND BARRICADING SHALL BE PROVIDED TO ENSURE THAT THE WORK SITE MEETS THE REQUIREMENTS OF AS 1742.2 & 1743.3, AND TO PROVIDE ADEQUATE PROTECTION TO PEDESTRIANS & MOTORISTS.
  - ADEQUATE AND SAFE ACCESS FOR PEDESTRIANS SHALL BE PROVIDED AT ALL TIMES.
  - AT DRIVEWAYS – PREVENTION OF ACCESS SHALL BE KEPT TO AN ABSOLUTE MINIMUM AND ARRANGEMENTS SHALL BE MADE WITH THE RESIDENT/BUSINESS, BY THE CONTRACTOR, FOR A SUITABLE DAY/TIME FOR THIS WORK. USE OF HIGHER STRENGTH CONCRETE, WITH SHORTER CURING TIME MAY BE NECESSARY.
- DIMENSIONS**
  - ALL DIMENSIONS ARE IN MILLIMETERS UNLESS SHOWN OTHERWISE.
- GENERAL**
  - ALL WORKS SHALL BE CARRIED OUT TO COUNCIL'S SPECIFICATION, TO BEST PRACTICE STANDARDS, AND TO THE SATISFACTION OF COUNCIL'S SUPERVISING ENGINEER.
  - THE WORK SITE SHALL BE KEPT IN A CLEAN, TIDY, AND SAFE CONDITION AT ALL TIMES AND TO THE SATISFACTION OF COUNCIL'S ENGINEER.
- DOCUMENT PRIORITY**
  - THIS PLAN SUPERSEDES ANY STATEMENTS ON OTHER DOCUMENTS, EG SPECIFICATIONS, OTHER PLANS, ETC, UNLESS ADVISED BY THE COUNCIL ENGINEER.
- INSPECTIONS**

INSPECTIONS BY THE COUNCIL SUPERVISING ENGINEER SHALL BE REQUIRED AT THE FOLLOWING STAGES AND AS OTHERWISE DIRECTED BY THE COUNCIL ENGINEER:-

  - EXCAVATION COMPLETED.
  - PITS FORMED
  - TOTALLY COMPLETED.

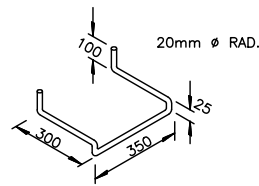

**3D VIEW**  
NOT TO SCALE

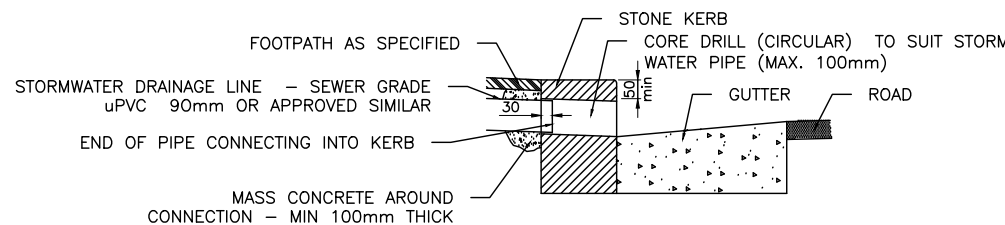

**STORMWATER OUTLET IN SANDSTONE KERB**

SCALE 1:20

NOTE: FOR RHS STORMWATER OUTLETS – SEE NOTE 3 AND USE PIPE ADAPTER FOR KERB CONNECTION

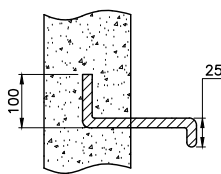

**SIDE ELEVATION**  
NOT TO SCALE

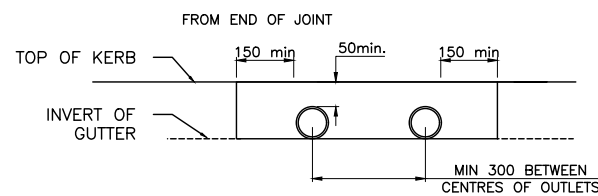

**STORMWATER OUTLET ELEVATION**

SCALE 1:20

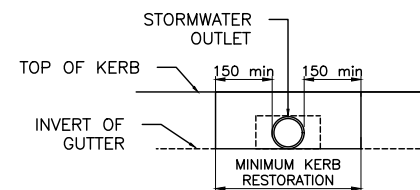

**KERB RESTORATION DIAGRAM**

SCALE 1:20

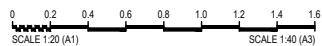

ISSUE FOR CONSTRUCTION

CHECKED & APPROVED  APPROVED FOR CONSTRUCTION 	SURVEYED BY ADAM DILLON 22-11-2022	<b>INNER WEST</b> 2-14 FISHER STREET, PETERSHAM NSW 2049 Ph. 02 9392 5000 Post: PO Box 14 PETERSHAM council@innerwest.nsw.gov.au Web: https://www.innerwest.nsw.gov.au		SURV. GEN. R.M.S. A.G.L. / SHELL PIPELINES SYDNEY WATER TELSTRA / OPTUS AUSGRID NOTICE OF ENTRY KERB & GUTTER NOTICES DATE	COORDINATE SYSTEM GDA2020	SCALES (ORIGINAL A1) AS SHOWN	REV. DATE DESCRIPTION APPROV.	PROJECT NO. 303025	SHEET NO. 7 of 9
	DESIGNED BY SANJOY 12-07-2023			DRAWN BY SANJOY 14-07-2023	CENTENNIAL STREET, MARRICKVILLE NEAR NO.9 & NO.11 CENTENNIAL STREET PROPOSED STORMWATER UPGRADE TYPICAL DETAILS 02			PLAN NO. 10233	SHEET REV #



**FOOTPATH NOTES 4:**

1. **ASPHALT**
  - A) ALL AC TO RMS QA SPECIFICATIONS R116, AS 2734 INCLUDING TABLE 3.3 AND AS 2758.5, BUT ANY REQUIREMENTS/SPECIFICS ON THIS PLAN TAKE PRIORITY.
  - B) BITUMEN CLASS: 320
  - C) MAY USE RAP IN MIX - 10% BY VOLUME.
2. **KERB RAMPS**
  - A) SEE STANDARD PLAN F4.
3. **ROAD BASE**
  - A) COMPACTION: 95% STANDARD.
  - B) RECYCLED DGB SPECIFICATION: FOR SUPPLY OF RECYCLED MATERIAL FOR PAVEMENTS, EARTHWORKS, AND DRAINAGE REFER TO SPECIFICATION FOR SUPPLY OF RECYCLED MATERIAL FOR PAVEMENTS, EARTHWORKS AND DRAINAGE' BY IPWEA (NSW) (LATEST EDITION).
4. **EXCAVATION**
  - A) AT ALL JOINTS TO EXISTING CONCRETE/ASPHALT - THE JOINT SHALL BE SAW CUT BEFORE EXCAVATION.
  - B) ALL EXCAVATED MATERIAL SHALL BE REMOVED FROM THE SITE AND DISPOSED OF AT A LICENSED WASTE DISPOSAL FACILITY.
5. **UTILITIES, SERVICES & SURVEY MARKS**
  - A) ALL UNDERGROUND UTILITY SERVICES SHALL BE CHECKED FOR LEVEL AND LOCATION PRIOR TO COMMENCEMENT OF WORKS, BY THE CONTRACTOR.
  - B) ALL SERVICE COVERS AFFECTED BY THE WORKS SHALL BE ADJUSTED AS REQUIRED AND TO SUIT THE LEVELS OF THE NEW WORK. NO SERVICE FITTINGS SHALL BE COVERED.
  - C) PROPERTY STORMWATER PIPES: WHERE AFFECTED, SHALL BE REPLACED WITH 90MM UPVC OR TO SUIT EXISTING AND INVERT SHALL MATCH THE GUTTER LEVEL.
  - D) STATE SURVEY MARKS (SSM'S) - SHALL NOT BE DISTURBED UNLESS APPROVED BY ETH COUNCIL ENGINEER.
6. **NATURE STRIP RESTORATION**
  - A) MATCH EXISTING TURF.
  - B) IF NEW TURF IS SPECIFIED - USE SOFT LEAF BUFFALO "SHADEMASTER", LAID ON 100MM THICK PREPARED TOPSOIL, AS SPECIFIED BY THE COUNCIL ENGINEER.
7. **EXISTING SIGNAGE**
  - A) SUCH SIGNAGE SHALL BE REINSTATED UNLESS THE COUNCIL ENGINEER ADVISES OTHERWISE.
  - B) HERITAGE STREET NAME SIGNS EMBEDDED IN FOOTPATH PAVING AND KERBS - CAUTION SHALL BE EXERCISED TO NOT DAMAGE THESE SIGNS AND THE CONTRACTOR SHALL LIAISE WITH THE COUNCIL ENGINEER TO DETERMINE WHAT ACTION TO IMPLEMENT WHERE DISTURBANCE OF THE SIGN IS ESSENTIAL.
8. **RESIDENT NOTIFICATION**
  - A) ALL RESIDENTS AFFECTED BY THE WORKS SHALL BE NOTIFIED AT LEAST 2 WORKING DAYS BEFORE THE RELEVANT WORK COMMENCES AND ANY REASONABLE REQUESTS ACCOMMODATED.
9. **SAFETY/SIGNAGE/ACCESS**
  - A) DURING CONSTRUCTION, ADEQUATE WARNING SIGNS AND BARRICADING SHALL BE PROVIDED TO ENSURE THAT THE WORK SITE MEETS THE REQUIREMENTS OF AS 1742.2 & 1743.3, AND TO PROVIDE ADEQUATE PROTECTION TO PEDESTRIANS & MOTORISTS.
  - B) ADEQUATE AND SAFE ACCESS FOR PEDESTRIANS SHALL BE PROVIDED AT ALL TIMES.
  - C) AT DRIVEWAYS - PREVENTION OF ACCESS SHALL BE KEPT TO AN ABSOLUTE MINIMUM AND ARRANGEMENTS SHALL BE MADE WITH THE RESIDENT/BUSINESS, BY THE CONTRACTOR, FOR A SUITABLE DAY/TIME FOR THIS WORK. USE OF HIGHER STRENGTH CONCRETE, WITH SHORTER CURING TIME MAY BE NECESSARY.
10. **DIMENSIONS**
  - A) ALL DIMENSIONS ARE IN MILLIMETRES UNLESS SHOWN OTHERWISE.
11. **GENERAL**
  - B) ALL WORKS SHALL BE CARRIED OUT TO COUNCIL'S SPECIFICATION, TO BEST PRACTICE STANDARDS, AND TO THE SATISFACTION OF COUNCIL'S SUPERVISING ENGINEER.
  - C) DURING AND AFTER EXCAVATION, ANY UNSOUND AREAS BELOW THE CONCRETE WORK SHALL BE DRAWN TO THE COUNCIL ENGINEER'S ATTENTION, TO ESTABLISH IF ANY ADDITIONAL EXCAVATION/ BASE COURSE IS NECESSARY.
  - D) THE WORK SITE SHALL BE KEPT IN A CLEAN, TIDY, AND SAFE CONDITION AT ALL TIMES AND TO THE SATISFACTION OF COUNCIL'S ENGINEER.
12. **DOCUMENT PRIORITY**
  - A) THIS PLAN SUPERSEDES ANY STATEMENTS ON OTHER DOCUMENTS, EG SPECIFICATIONS, OTHER PLANS, ETC. UNLESS ADVISED BY THE COUNCIL ENGINEER.
13. **INSPECTIONS**

INSPECTIONS BY THE COUNCIL SUPERVISING ENGINEER SHALL BE REQUIRED AT THE FOLLOWING STAGES AND AS OTHERWISE DIRECTED BY THE COUNCIL ENGINEER:

  - A) EXCAVATION COMPLETED.
  - B) ROAD BASE PLACED AND COMPACTED.
  - C) ASPHALTIC CONCRETE PLACE & COMPACTED.
  - D) COMPLETED.
14. **DESIGN & SETTING OUT**
  - A) SETTING OUT SHALL BE THE RESPONSIBILITY OF THE CONTRACTOR EXCEPT WHERE A SURVEYED ALIGNMENT OR DETAILED LEVELS ARE PROVIDED BY THE COUNCIL, IN WHICH CASE THE COUNCIL SHALL BE RESPONSIBLE TO PROVIDE THE REQUIRED DETAILS TO THE CONTRACTOR, IE DISTANCES IN ALL DIMENSIONS FROM FIXED POINTS.  
THE CONTRACTOR MAY NEED TO SAVE THESE 'FIXED POINTS' DURING EXCAVATION, BY TRANSFERRING THEM ELSEWHERE USING A MEASURING TAPE AND SPIRIT/LASER LEVEL.  
IT IS THE CONTRACTOR'S RESPONSIBILITY TO ACHIEVE THE DESIGN ALIGNMENT AND LEVEL AS PER THE COUNCIL PROVIDED DETAILS.
  - B) WHERE NO DESIGN LEVELS ARE ISSUED (MOST CASES), THE CONTRACTOR SHALL AIM TO HAVE THE COMPLETED WORK ATTAIN A REASONABLY SMOOTH LONGITUDINAL PROFILE, AND FOR FOOTPATH WORKS A REASONABLY UNIFORM FOOTPATH CROSSFALL OF 2% (MAXIMUM 4%), UNLESS DIRECTED OTHERWISE BY THE COUNCIL SUPERVISOR.  
DUE COGNIZANCE SHALL BE GIVEN TO THE EXISTING PROPERTY LEVELS, PARTICULARLY PATHS AND FLOORS - THIS OFTEN LEADS TO A VARYING OF THE CROSSFALL AND/OR LEVEL OF THE NEW KERB/GUTTER/FOOTPATH.  
WHEN THE SITE CREATES DIFFICULTY IN ACHIEVING THE ABOVE, THE CONTRACTOR SHALL LIAISE WITH THE SUPERINTENDENT AND WORK TOGETHER, CO-OPERATIVELY, TO ACHIEVE A REASONABLE OUTCOME.

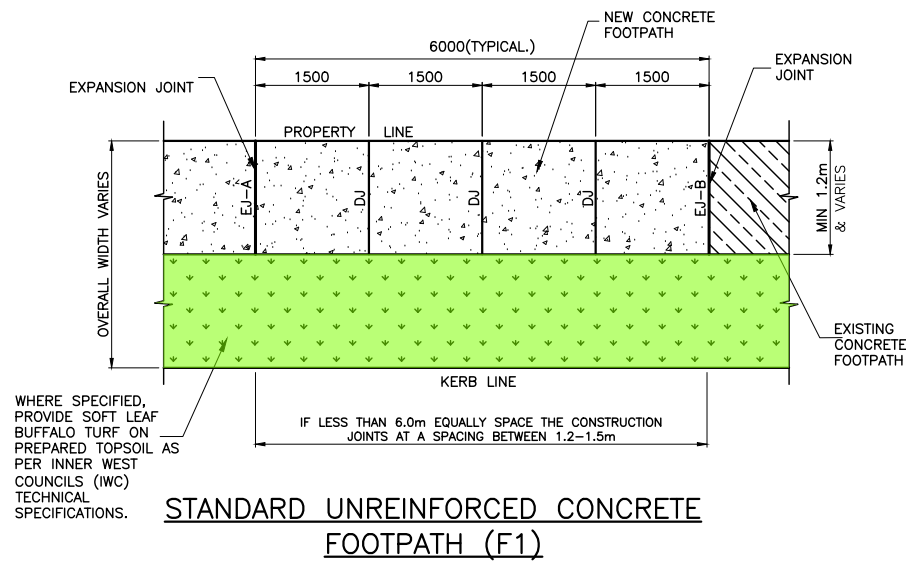

**STANDARD UNREINFORCED CONCRETE FOOTPATH (F1)**

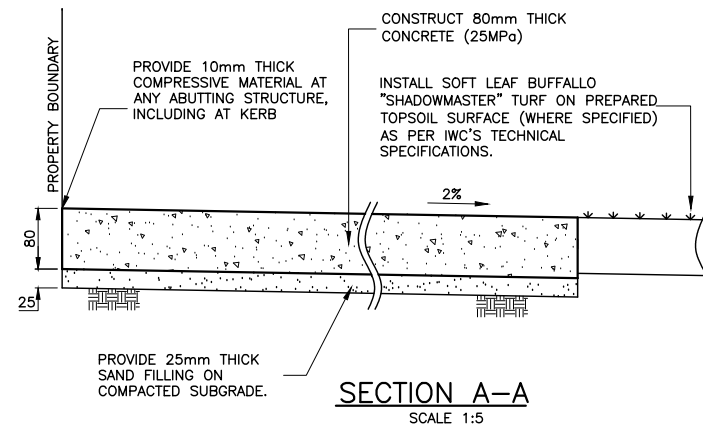

**SECTION A-A**  
SCALE 1:5

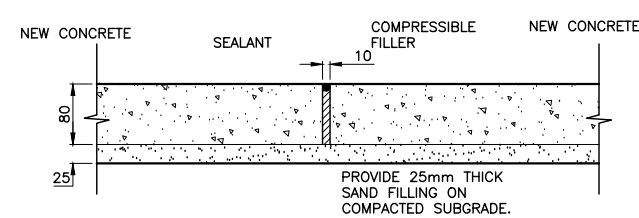

**EXPANSION JOINT A (EJ-A)**  
SCALE 1:5

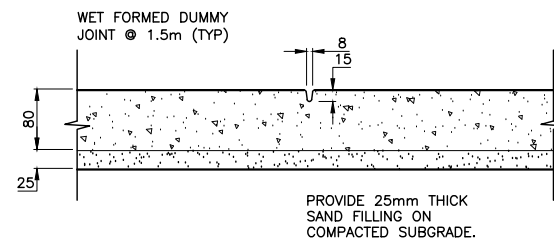

**DUMMY JOINT (DJ)**  
SCALE 1:5

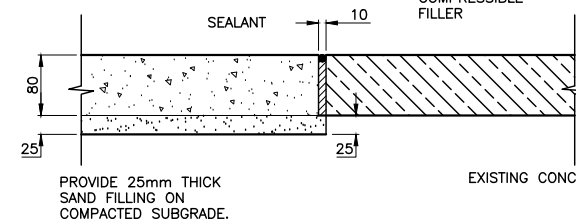

**EXPANSION JOINT B (EJ-B)**  
SCALE 1:5

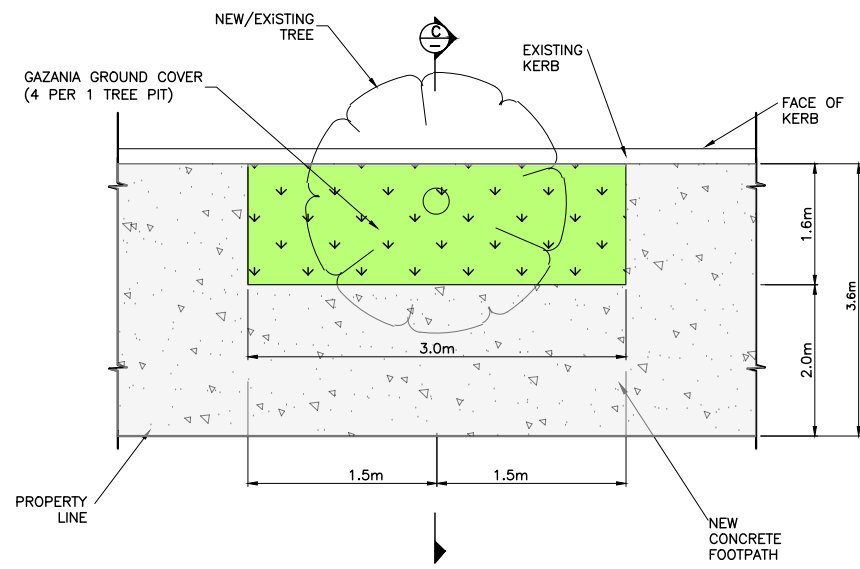

**TREE PIT DETAILS**  
NEW/EXISTING TREE IN TREE-PIT & GROUND COVER  
SCALE 1:50

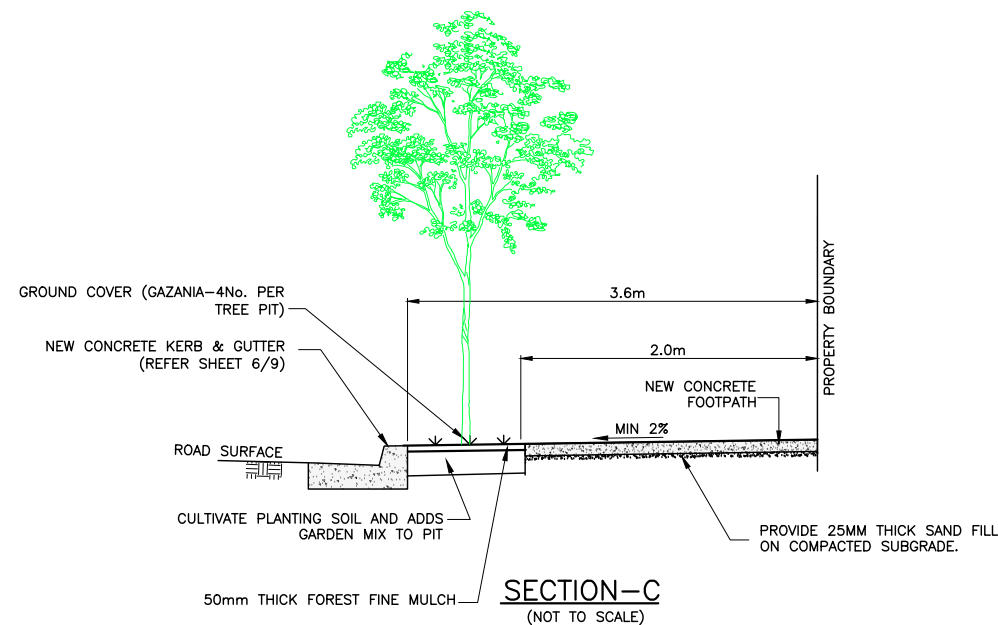

**SECTION-C**  
(NOT TO SCALE)

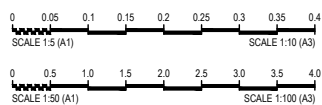

NOTE:  
WHERE NEW TREES ARE INSTALLED - PROVIDE TREE ROOT BARRIER SURE GRO TYPE RB600H OR SIMILAR APPROVED TO MANUFACTURERS SPECIFICATION.

**ISSUE FOR CONSTRUCTION**

CHECKED & APPROVED  ADAM DILLON 22-11-2022	SURVEYED BY ADAM DILLON 22-11-2022	 <b>INNER WEST</b> 2-14 FISHER STREET, PETERSHAM NSW 2049 Ph. 02 9392 5000 Post: PO Box 14 PETERSHAM council@innerwest.nsw.gov.au Web: https://www.innerwest.nsw.gov.au	 N	SURV. GEN. R.M.S.	COORDINATE SYSTEM GDA2020	PROJECT NO. <b>303025</b>	SHEET NO. <b>8 of 9</b>
				A.G.L. / SHELL PIPELINES SYDNEY WATER TELSTRA / OPTUS AUSGRID NOTICE OF ENTRY KERB & GUTTER NOTICES DATE	SCALES (ORIGINAL A1) <b>AS SHOWN</b>		
APPROVED FOR CONSTRUCTION  SANJOY	DESIGNED BY SANJOY 12-07-2023					SHEET REV #	

# UTILITIES LEGEND

EXISTING SERVICES	
DRAINAGE LINE	-----
ELECTRICITY	— E — E —
GAS	— G — G —
OIL PIPELINE	— P — P —
SEWER	— S — S —
TELECOM	— T — T —
WATER SUPPLY	— W — W —
OPTIC FIBER	— OF — OF —
SUBSOIL	— SS — SS —
NBN	— NBN — NBN —
OPTUS	— OPTUS — OPTUS —
OVERHEAD ELECT.	— E — E —
O'HD ELECT & TEL	— ET — ET —
UNKNOWN	— ? — ? —

**! WARNING !**  
**BEWARE OF UNDERGROUND SERVICES**  
 THE LOCATION OF UNDERGROUND SERVICES HAVE BEEN INTERPOLATED FROM AERIAL PHOTOGRAMMETRIC DATA OR KNOWN POSITIONS OF VALVES, MANHOLES ETC. OR INFORMATION SUPPLIED BY SERVICE AUTHORITIES. NO RESPONSIBILITY IS TAKEN FOR THE ACCURACY OF THE INTERPOLATED INFORMATION SUPPLIED. ENSURE ALL SERVICES ARE ACCURATELY LOCATED PRIOR TO COMMENCEMENT OF WORK.

**IMPORTANT**  
 IN CASE OF EMERGENCY, CONTACT THE FOLLOWING UTILITIES IF THEIR SERVICES ARE INVOLVED:

TELSTRA	: 132203
JEMENA (GAS)	: 131909
SYDNEY WATER	: 132090
AUSGRID	: 131388

**NOTE**  
 CONTRACTOR TO REINSTATE ALL KERB & GUTTER, ROAD PAVEMENT AND FOOTPATHS AFFECTED BY WORKS TO INNER WEST COUNCIL STANDARD AND TO THE SATISFACTION OF THE MANAGER, CAPITAL PROGRAM.

**NOTE**  
 CONTRACTOR TO LOCATE ALL HOUSE SERVICES (GAS, WATER) PRIOR TO CONSTRUCTION. SERVICES TO BE ADJUSTED AS REQUIRED.

**NOTE**  
 WATER, SEWER, TELSTRA, GAS & ELECTRICITY SERVICES IN VICINITY OF WORKS. CONTRACTOR TO CONTACT SYDNEY WATER, TELSTRA, JEMENA & AUSGRID PRIOR TO EXCAVATION.



UTILITIES, IF SHOWN, ARE DIAGRAMMATIC ONLY. CONTRACTORS ARE RESPONSIBLE TO LOCATE AND AVOID DAMAGE TO THEM AS SPECIFIED BY EACH UTILITIES EXCAVATION GUIDELINES.

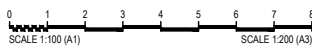
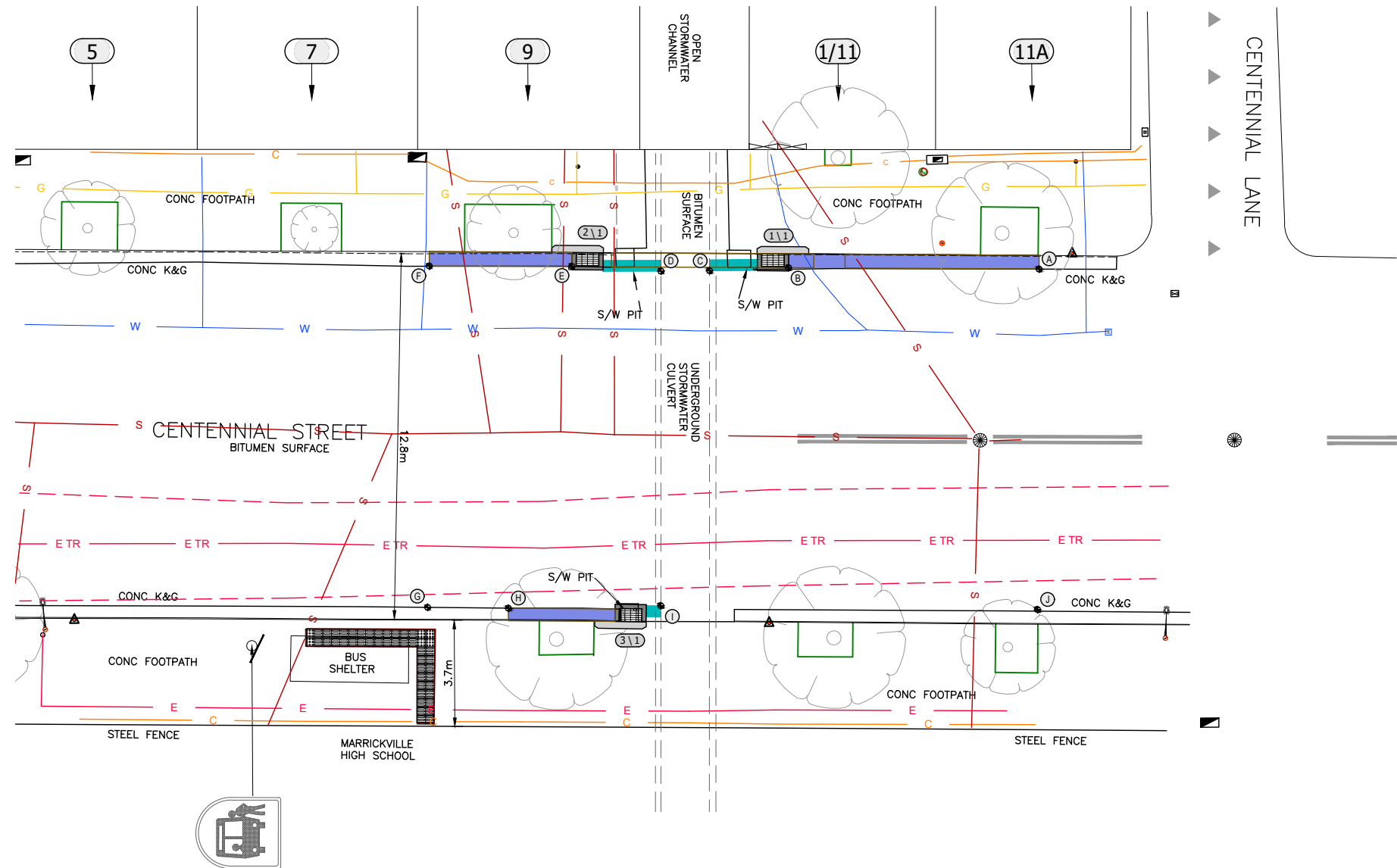

\\wcc-flo02\innerwest.nsw.gov.au\assets and Environment\BSEF\CD\24\512\SU\303025-MAR-11\CentennialSt-Pit&gullypgrade(102333).L1.DESIGN\12. FinalDesign(1002)Docx\303025-10233-Plan.dwg

CHECKED & APPROVED  APPROVED FOR CONSTRUCTION 	SURVEYED BY ADAM DILLON 22-11-2022	<b>INNER WEST</b> 2-14 FISHER STREET, PETERSHAM NSW 2049 Ph. 02 9392 5000 Post: PO Box 14 PETERSHAM council@innerwest.nsw.gov.au Web: https://www.innerwest.nsw.gov.au		SURV. GEN. R.M.S. A.G.L. / SHELL PIPELINES SYDNEY WATER TELSTRA / OPTUS AUSGRID NOTICE OF ENTRY KERB & GUTTER NOTICES DATE	COORDINATE SYSTEM GDA2020 SCALES (ORIGINAL A1) 1:100	CENTENNIAL STREET, MARRICKVILLE NEAR NO.9 & NO.11 CENTENNIAL STREET PROPOSED STORMWATER UPGRADE UTILITIES	PROJECT NO. 303025	SHEET NO. 9 of 9
	DESIGNED BY SANJOY 12-07-2023			DRAWN BY SANJOY 14-07-2023	REV. DATE DESCRIPTION APPROV.		PLAN NO. 10233	SHEET REV #