

# INNER WEST

## INNER WEST COUNCIL MEEKS ROAD, MARRICKVILLE AT VICTORIA ROAD PROPOSED INTERSECTION IMPROVEMENTS

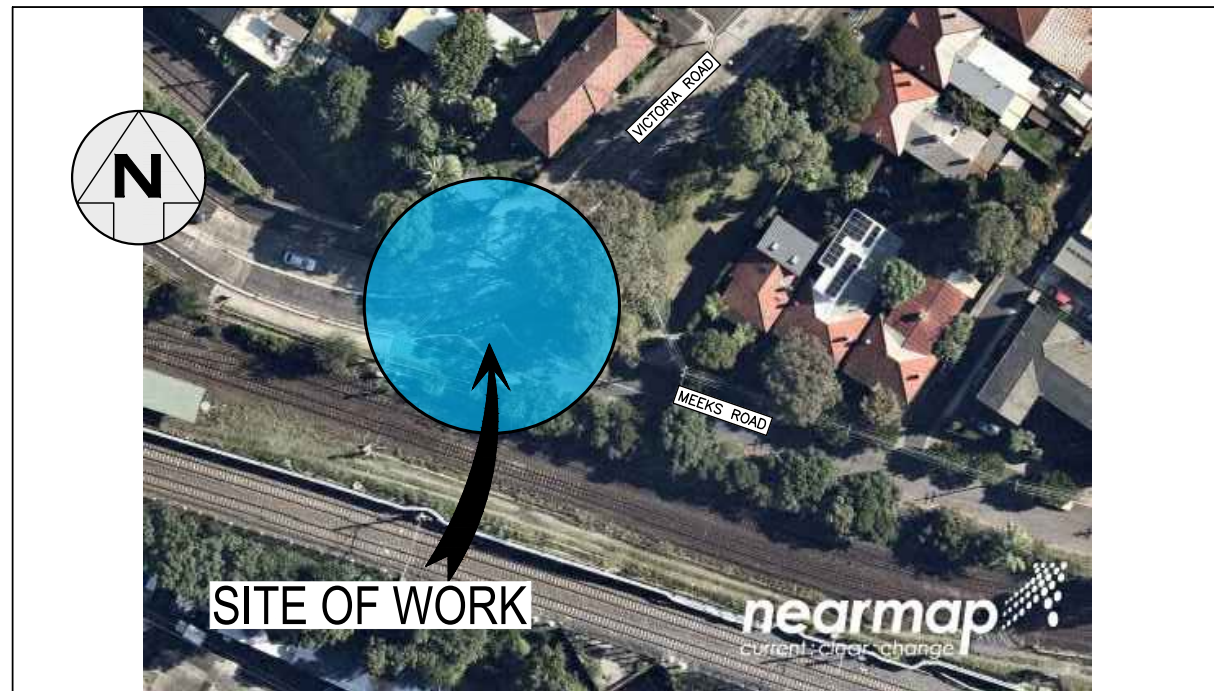

LOCALITY SKETCH  
N.T.S.

IMAGE COURTESY OF NEARMAP

**PROJECT #: 303291**  
**PLAN #: 10268**

**FOR  
CONSTRUCTION**

DRAWING INDEX	
SHEET #	SHEET TITLE
1	COVER SHEET
2	NOTES & SCHEDULES
3	DEMOLITION
4	GENERAL LAYOUT AND SIGNS & LINEMARKING
5	DETAILS
6	DETAILS 2
7	UTILITIES



UTILITIES, IF SHOWN, ARE DIAGRAMMATIC ONLY. CONTRACTORS ARE RESPONSIBLE TO LOCATE AND AVOID DAMAGE TO THEM AS SPECIFIED BY EACH UTILITIES EXCAVATION GUIDELINES.

UNLESS DETAILED ON THIS DRAWING ALL WORK SHALL CONFORM TO

CHECKED & APPROVED  9/1/24	SURVEYED BY ADAM DILLON 08-11-24	<b>INNER WEST</b> 2-14 FISHER STREET, PETERSHAM NSW 2049 Ph. 02 9392 5000 Post: PO Box 14 PETERSHAM council@innerwest.nsw.gov.au Web: https://www.innerwest.nsw.gov.au	DOCUMENT REFERENCE	SURV. GEN. R.M.S. A.G.L. / SHELL PIPELINES SYDNEY WATER TELSTRA / OPTUS AUSGRID NOTICE OF ENTRY KERB & GUTTER NOTICES DATE	COORDINATE SYSTEM GDA2020 SCALES (ORIGINAL A1) N.A.	MEEKS ROAD, MARRICKVILLE AT VICTORIA ROAD PROPOSED INTERSECTION IMPROVEMENTS COVER SHEET	PROJECT NO. 303291	SHEET NO. 1 of 7
	DESIGNED BY PIERRE AYOUB JANUARY 2024		SERVICES AFFECTED	REV. DATE DESCRIPTION APPROV.	PLAN NO. 10268	SHEET REV #		

\\vec-fil001\innerwest.nsw.gov.au\vec\asset and Environment\GIS\CD\24\5119TF\303291-148R-VictoriaRd-MeeksRd-Kerb&Gutter\10268-1\DESIGN\12\_FinalDesign\1002\Docs\303291-10268-Plans.dwg

**GENERAL NOTES**

- DURING CONSTRUCTION THE WORK IS TO BE SIGNPOSTED AND MARKED TO THE REQUIREMENTS OF AS1742.2-2009 "TRAFFIC CONTROL DEVICES FOR GENERAL USE" AND AS1742.3-2009 "TRAFFIC CONTROL FOR WORKS ON ROADS". ALL TRAFFIC CONTROL PLANS (TCP'S) MUST BE PREPARED BY A CERTIFIED RMS ACCREDITED PERSON AND COMPLY WITH RMS "TRAFFIC CONTROL AT WORKS SITES" MANUAL AND WORK COVER NSW REGULATIONS.
- ALL WORK IS TO BE CARRIED OUT IN ACCORDANCE WITH COUNCIL'S TECHNICAL SPECIFICATION (AUS-SPEC) AND TO BEST PRACTICE STANDARDS AND TO THE SATISFACTION OF COUNCIL'S MANAGER CAPITAL PROGRAMS
- ALL RESIDENTS AFFECTED BY THE PROPOSED WORKS SHOULD BE NOTIFIED AT LEAST 7 WORKING DAYS BEFORE THE COMMENCEMENT OF ROAD WORKS.
- WORK ONLY PERMITTED BETWEEN THE HOURS OF 7am AND 5pm MONDAY TO FRIDAY. NO WORK PERMITTED ON SATURDAY, SUNDAY, OR PUBLIC HOLIDAYS WITHOUT PRIOR APPROVAL FROM COUNCIL.
- SUITABLE VEHICULAR ACCESS SHALL BE MAINTAINED TO EACH LOT OR ALTERNATE ARRANGEMENTS MADE WITH THE OWNERS.
- ALL SERVICES TO BE CHECKED FOR LOCATION AND DEPTH PRIOR TO COMMENCEMENT OF WORKS.
- ALL SERVICES AFFECTED BY NEW WORK TO BE ADJUSTED AS REQUIRED TO SUIT NEW SURFACE LEVELS. (TO THE REQUIREMENTS OF THE RELEVANT AUTHORITY). NO SERVICE SURFACE FITTINGS ARE TO BE COVERED.
- THE LOCATION OF INDIVIDUAL PROPERTY SERVICE CONNECTIONS HAVE NOT BEEN SHOWN ON THIS PLAN AND MUST BE VERIFIED ON SITE BY THE CONTRACTOR WITH REPRESENTATIVES FROM EACH OF THE UTILITY AUTHORITIES. CONTACT DIAL BEFORE YOU DIG PH: 1100 (WWW.1100.COM.AU)
- CONTRACTOR TO INSPECT FOR ALL UNSOUND AREAS BEFORE PROFILING AC PAVEMENT AND AFTER PROOF ROLLING. WEAK SECTIONS ARE TO BE IDENTIFIED AND HEAVY-PATCHED TO A NOMINAL THICKNESS OF 150mm WITH AC28 BEFORE RESEALING IN ACCORDANCE WITH TYPICAL CROSS-SECTION.
- EXISTING SIGNS TO REMAIN UNLESS OTHERWISE NOTED.
- ALL LINEMARKING AND RRPM'S REMOVED OR AFFECTED DURING THE COURSE OF THE WORKS IS TO BE REINSTITATED UNLESS NOTED OTHERWISE. ALL LINEMARKING IS TO COMPLY WITH RMS QA SPECIFICATION R141 "PAVEMENT MARKING" AND TO BE THERMOPLASTIC TYPE AND INCLUDE PLASTIC BEADS IN ACCORDANCE WITH RMS QA SPECIFICATIONS 3357 AND 3353 RESPECTIVELY. ALL RRPM'S TO COMPLY WITH RMS QA SPECIFICATION R142.
- AREAS OF HEAVY PATCHING ARE TO BE MARKED OUT ON SITE PRIOR TO COMMENCEMENT OF WORK BY COUNCIL'S PROJECT MANAGER AND DESIGN ENGINEER OR THEIR REPRESENTATIVE.
- THE CONTRACTOR SHALL ENSURE THAT ALL EXISTING SURROUNDING AREAS NOT REQUIRED TO BE REPLACED OR RESET AS PART OF THE WORKS SHALL NOT BE DAMAGED DURING THE COURSE OF THE WORKS.
- ASPHALTIC CONCRETE SHALL CONFORM TO RMS QA SPECIFICATIONS R116 "HEAVY DUTY DENSE GRADED ASPHALT"
- INSPECTIONS ARE REQUIRED AT THE FOLLOWING STAGES AND AS OTHERWISE DIRECTED BY THE MANAGER CAPITAL PROGRAMS.
  - ROAD PAVEMENT**
    - SUBGRADE TRIMMED AND CONSOLIDATED PRIOR TO FIRST PAVEMENT COURSE. (NOTE: SINGLE AXLE TRUCK WITH 8t LOAD TO BE AVAILABLE FOR PAVEMENT TEST.)
    - EACH PAVEMENT LAYER SPREAD AND COMPACTED. (NOTE: SINGLE AXLE TRUCK WITH 8t LOAD TO BE AVAILABLE FOR PAVEMENT TEST.)
    - PAVEMENT COMPLETED PRIOR TO SEALING
  - CONCRETE WORKS**
    - EXCAVATION COMPLETED
    - FORMWORK AND REINFORCEMENT SET
    - CONCRETE FORMED AND CURED
- LINEMARKING AND SIGNPOSTING TO BE INSTALLED AS SOON AS PRACTICABLE.
- KERB FACES OF ALL ISLANDS TO BE PAINTED WHITE AND TO INCLUDE GLASS BEADS IN ACCORDANCE WITH RMS QA SPECIFICATION 3353 "GLASS BEADS".
- KERB RAMPS TO BE PROVIDED WHERE SHOWN TO INNER WEST COUNCIL STANDARD WITH LENGTH FROM FACE OF KERB TO BACK OF RAMP AS SPECIFIED.
- USE CAUTION TO PRESERVE HERITAGE LISTED STREET NAME PLAQUES EMBEDDED IN FOOTPATH WHEN CONSTRUCTING FOOTPATHS AND KERB RAMPS (IF SHOWN).
- SURVEY MARKS SHALL BE PRESERVED AT ALL TIMES. WHERE PRESERVATION IS NOT POSSIBLE, THE PROJECT MANAGER SHALL BE NOTIFIED & CONSENT RECEIVED PRIOR TO THEIR REMOVAL. THE CONTRACTOR SHALL BE RESPONSIBLE FOR COMPLIANCE WITH THE SURVEYOR GENERAL'S DIRECTION NO.11 'PRESERVATION OF SURVEY INFRASTRUCTURE' AVAILABLE FROM LAND REGISTRY SERVICES NSW WEBSITE.
- INSTALL "CHANGED TRAFFIC CONDITIONS AHEAD" SIGNS ON ALL APPROACHES 75-100m IN ADVANCE OF THE INTERSECTION AND MAINTAIN FOR 3 MONTHS.
- ALL TRAFFIC SIGNS TO COMPLY WITH RMS QA SPECIFICATION R143 "SIGNPOSTING" AND TO BE OF HIGH INTENSITY CLASS 1.
- ALL PATHWAYS WHERE AFFECTED BY CONSTRUCTION WORKS SHALL BE RECONSTRUCTED TO COUNCIL SPECIFICATION.
- EXISTING LINEMARKING IS TO BE REMOVED BY GRINDING WHERE NEW LINEMARKING IS REQUIRED OR PROVIDED.
- ALL SIGNPOSTING ON SPLITTER, KERB OR PEDESTRIAN REFUGE ISLANDS TO BE ERECTED USING V-NOTCH INSERTS EMBEDDED INTO CONCRETE (OR SIMILAR AS APPROVED BY COUNCIL).
- ALL CONCRETE ELEMENTS TO BE OF 25MPa UNLESS OTHERWISE STATED.

UNLESS DETAILED ON THIS DRAWING ALL WORK SHALL CONFORM TO AUS SPEC

**IMPORTANT**

IN CASE OF EMERGENCY, CONTACT THE FOLLOWING SERVICE AUTHORITIES; IF THEIR SERVICES ARE INVOLVED/AFFECTED

AUTHORITY	CONTACT NO.	SERVICE TYPE
AARNET PTY LTD	1300 275 662	FIBRE OPTIC ASSETS
AUSGRID	02 4951 0899	LOW VOLTAGE LINE
JEMENA GAS SOUTH	1300 880 906	PRIMARY & DISTRIBUTION
NBN CO.	1800 626 329	BURIED FIBRE OPTIC CABLES
NEXTGEN	1800 032 532	BURIED FIBRE OPTIC CABLES
OPTUS	1800 505 777	BURIED FIBRE OPTIC CABLES
SYDNEYWATER	13 20 92	WATER & SEWER LINES
TELSTRA	1800 653 935	BURIED CABLES
VERIZON	02 9434 5000	BURIED CABLES



UTILITIES, IF SHOWN, ARE DIAGRAMMATIC ONLY. CONTRACTORS ARE RESPONSIBLE TO LOCATE AND AVOID DAMAGE TO THEM AS SPECIFIED BY EACH UTILITIES EXCAVATION GUIDELINES.

**! WARNING !**  
**BWARE OF UNDERGROUND SERVICES**  
THE LOCATION OF UNDERGROUND SERVICES HAVE BEEN INTERPOLATED FROM AERIAL PHOTOGRAMMETRIC DATA OR KNOWN POSITIONS OF VALVES, MANHOLES ETC. OR INFORMATION SUPPLIED BY SERVICE AUTHORITIES. NO RESPONSIBILITY IS TAKEN FOR THE ACCURACY OF THE INTERPOLATED INFORMATION SUPPLIED. ENSURE ALL SERVICES ARE ACCURATELY LOCATED PRIOR TO COMMENCEMENT OF WORK.

**EROSION AND SEDIMENT CONTROL**

**1. GENERAL MEASURES**

- STOCKPILES SHALL BE CONFINED TO ONE CENTRAL AREA WHERE POSSIBLE.
- EROSION CONTROL MEASURES TO BE IN PLACE PRIOR TO COMMENCEMENT OF ANY CONSTRUCTION WORK. MEASURES ARE APPLIED TO PROTECT ADJOINING PROPERTIES FROM EROSION AND SILT DAMAGE.
- EROSION CONTROL MEASURES NOT TO BE REMOVED UNTIL CONSTRUCTION IS COMPLETED AND SITE HAS BEEN REHABILITATED.
- REHABILITATION INCLUDES COMPLETION OF ALL CONSTRUCTION WORK AND LANDSCAPING, SEEDING OR TURFING OF ALL BATTERS AND FILL AREAS.
- PIPED DRAINAGE NETWORKS SHOULD BE INSTALLED AND CONNECTED AS EARLY AS POSSIBLE.
- ALL AREAS NOT SUBJECT TO CONSTRUCTION WORKS SHALL BE RETAINED FREE FROM DISTURBANCE OR DAMAGE DURING THE CURRENCY OF THE CONTRACT. SHOULD THESE AREAS BECOME DISTURBED OR DAMAGED, THEY SHALL BE RE-INSTITATED BY THE CONTRACTOR AT NO COST TO THE PRINCIPAL.
- ALL AREAS NOT SUBJECT TO CONSTRUCTION WORKS SHALL BE RETAINED FREE FROM DISTURBANCE OR DAMAGE DURING THE CURRENCY OF THE CONTRACT. SHOULD THESE AREAS BECOME DISTURBED OR DAMAGED, THEY SHALL BE RE-INSTITATED BY THE CONTRACTOR AT NO COST TO THE PRINCIPAL.

**2. STABILISATION OF DISTURBED AREAS.**

- STABILISATION OF DISTURBED AREAS SHALL BE IN ACCORDANCE WITH COUNCIL'S SPECIFICATION FOR GRASSING AND/OR SPECIFICATION FOR LANDSCAPE WORKS. THE FOLLOWING SHALL BE APPLIED FOR THE CONTROL OF EROSION AND SEDIMENTATION:-
  - STABILISATION OF DENuded AREAS SHALL COMMENCE AS SOON AS POSSIBLE AFTER THE AREAS HAVE BEEN DISTURBED.
  - ALL STABILISATION MEASURES SHALL BE UNDERTAKEN PRIOR TO THE END OF THE MAINTENANCE PERIOD.

**3. MAINTENANCE**

- ALL SEDIMENT AND EROSION CONTROL DEVICES SHALL BE MAINTAINED IN A SATISFACTORY WORKING ORDER THROUGHOUT THE CONTRACT, MAINTENANCE AND DEFECTS LIABILITY PERIODS OR UNTIL SUCH EARLIER TIME AS THE AREA HAS BEEN STABILISED AND THE SUPERINTENDENT DIRECTS THAT THE DEVICE BE REMOVED.
- THE CONTRACTOR SHALL INSPECT ALL DEVICES AFTER EACH STORM FOR STRUCTURAL DAMAGE OR CLOGGING BY SILT AND OTHER DEBRIS AND MAKE PROMPT REPAIRS OR REPLACEMENT.

**4. SEDIMENT CONTROL DEVICES (S.C.D.)**

- THESE SHALL BE CONSTRUCTED AT INLETS TO STORMWATER SYSTEMS TO TRAP THE SEDIMENT IN RUNOFF. SECTIONS 11.3.02/03/04/06 OF THE N.S.W. DEPARTMENT OF HOUSING CONSTRUCTION SPECIFICATION, 1989 EDITION, SHALL APPLY.

**PLANTING NOTES**

- SUBGRADE TO BE CULTIVATED TO A MINIMUM DEPTH OF 100mm.
- PLANTING AREAS TO BE EXCAVATED TO A MINIMUM DEPTH OF 500mm AND FILLED WITH PREMIUM GRADE GARDEN SOIL.
- INORGANIC MULCH LAYER MINIMUM 75mm DEPTH IS TO BE SPREAD THROUGHOUT ALL PLANTING AREA.
- GARDEN AREA TO BE WATERED TWICE A WEEK FOR 3 MONTHS, OR AS REQUIRED TO MAINTAIN HEALTHY GARDEN.
- QUANTITIES OR SIZE OF PLANTS SPECIFIED ARE NOT TO BE DECREASED TO ENSURE ADEQUATE ESTABLISHMENT.

**UNDERGROUND UTILITY SERVICES**

- THE LOCATION OF UNDERGROUND UTILITY SERVICES SHOWN ON THIS PLAN ARE INDICATIVE ONLY. COUNCIL CANNOT GUARANTEE THEIR ACCURACY.
- PRIOR TO CONSTRUCTION, IT IS THE RESPONSIBILITY OF THE CONTRACTOR TO CARRY OUT THEIR OWN SERVICES SEARCH BY CONTACTING 'DIAL BEFORE YOU DIG' (PH: 1100 OR WWW.1100.COM.AU). THE CONTRACTOR MUST CHECK THE LOCATION AND DEPTH OF ALL SERVICES PRIOR TO THE COMMENCEMENT OF WORKS.
- ALL SERVICES AFFECTED BY NEW WORK TO BE ADJUSTED AS REQUIRED TO SUIT NEW SURFACE LEVELS. (TO THE REQUIREMENTS OF THE RELEVANT SERVICE AUTHORITY).
- NO SERVICE SURFACE FITTINGS ARE TO BE COVERED.
- ALL PERMITS REQUIRED MUST BE OBTAINED FROM THE RELEVANT SERVICE AUTHORITY PRIOR TO COMMENCEMENT OF WORKS.
- ANY DAMAGE TO SERVICES SHALL BE RECTIFIED BY THE CONTRACTOR OR THE RELEVANT AUTHORITY AT NO COST TO COUNCIL.

**PROTECTING SURVEY INFRASTRUCTURE**

SURVEY MARKS SHALL BE PRESERVED AT ALL TIMES. WHERE PRESERVATION IS NOT POSSIBLE, THE PROJECT MANAGER SHALL BE NOTIFIED & CONSENT RECEIVED PRIOR TO THEIR REMOVAL. THE CONTRACTOR SHALL BE RESPONSIBLE FOR COMPLIANCE WITH THE SURVEYOR GENERAL'S DIRECTION NO.11 'PRESERVATION OF SURVEY INFRASTRUCTURE' AVAILABLE FROM LAND REGISTRY SERVICES NSW WEBSITE.

**NOTE**  
ALL DIMENSIONS ARE IN MILLIMETERS UNLESS OTHERWISE SHOWN

**NOTE**  
ALL SIGNS AND LINES TO REMAIN UNLESS OTHERWISE NOTED.

**IMPORTANT**  
ALL KERB RAMPS TO REMAIN UNLESS STATED OTHERWISE

**NOTE**  
CONTRACTOR TO LOCATE ALL HOUSE SERVICES, SUCH AS STORMWATER OUTLET, GAS, WATER, TELEPHONE, ETC. PRIOR TO CONSTRUCTION AND SERVICES TO BE LOWERED AS REQUIRED

**NOTE**  
WATER, SEWER, TELSTRA & ELECTRICITY SERVICES IN THE VICINITY OF WORKS, CONTRACTOR TO CONTACT SYDNEY WATER, TELSTRA & ENERGY AUSTRALIA PRIOR TO EXCAVATION

**NOTE**  
CONTRACTOR TO REINSTATE ALL KERB & GUTTER, ROAD PAVEMENT AND FOOTPATHS AFFECTED BY WORKS TO INNER WEST COUNCIL STANDARD AND TO THE SATISFACTION OF THE PROJECT MANAGER

**NOTE**  
SURFACE FITTINGS OF UNDERGROUND SERVICES ARE TO FINISH FLUSH WITH THE NEW SURFACES

**CONCRETE**

- ALL WORKMANSHIP AND MATERIALS SHALL BE IN ACCORDANCE WITH AS 3600 CURRENT EDITION WITH AMENDMENTS EXCEPT WHERE VARIED BY THE CONTRACT DOCUMENTS.
- CONCRETE QUALITY.

ELEMENT	SLUMP	MAX AGGREGATE SIZE	CEMENT TYPE	CEMENT GRADE
ALL	80mm	20mm	GP	25MPa

NO ADMIXTURES SHALL BE USED WITHOUT THE APPROVAL OF THE ENGINEER.

- CLEAR CONCRETE COVER TO REINFORCEMENT SHALL BE AS FOLLOWS UNLESS OTHERWISE SHOWN-

ELEMENT	SURFACE OF MEMBER IN INTERIOR ENVIRONMENT	SURFACE OF MEMBER IN ABOVE GROUND EXTERIOR ENVIRONMENT	SURFACE OF MEMBER IN CONTACT WITH GROUND (1)	SURFACE OF MEMBER IN WATER
ALL	35	45	55	75

- NOTE:**
- COVER MAY BE REDUCED BY 10mm IF THE SURFACE IS PROTECTED BY A DAMP-PROOF MEMBRANE.
  - SLABS EXPOSED TO CORROSIVE VAPOURS, CORROSIVE GROUND WATER, SEA WATER, OR SPRAY ARE TO HAVE REINFORCEMENT COVER AS NOTED ON THE DRAWINGS.

- SIZES OF CONCRETE ELEMENTS DO NOT INCLUDE THICKNESS OF APPLIED FINISHES.
- CONSTRUCTION JOINTS WHERE NOT SHOWN SHALL BE LOCATED TO THE APPROVAL OF THE ENGINEER.

- BEAM DEPTHS ARE WRITTEN FIRST AND INCLUDE SLAB THICKNESS IF ANY.

**LANDSCAPING PLANTING SCHEDULE**

PLANT NAME	SPACING	QTY	POT SIZE	COMMENTS
CARPOBROTUS GLAUCESCENS "PIG FACE"	500mm	13	140mm DIA	REFER SHEET 5

**LINEMARKING SCHEDULE**

LINE TYPE	QUANTITY	RRPM	LOCATION
E1	22M	0	PAVEMENT
BICYCLE ROAD SYMBOLS	2	0	PAVEMENT
TF	5.2M	0	PAVEMENT
TB1	9.7M	0	PAVEMENT
PIANO KEY LINEMARKING	15M	0	RAISED THRESHOLD

**SIGNPOSTING SCHEDULE**

SIGN NO.	QUANTITY	STEM TYPE	STEM	LOCATION
R1-1	1	NEW	STANDARD	KERB SIDE
D4-1-2	1	NEW	STANDARD	KERB BLISTER
R2-3(L)	2	NEW	STANDARD	MEDIAN ISLAND

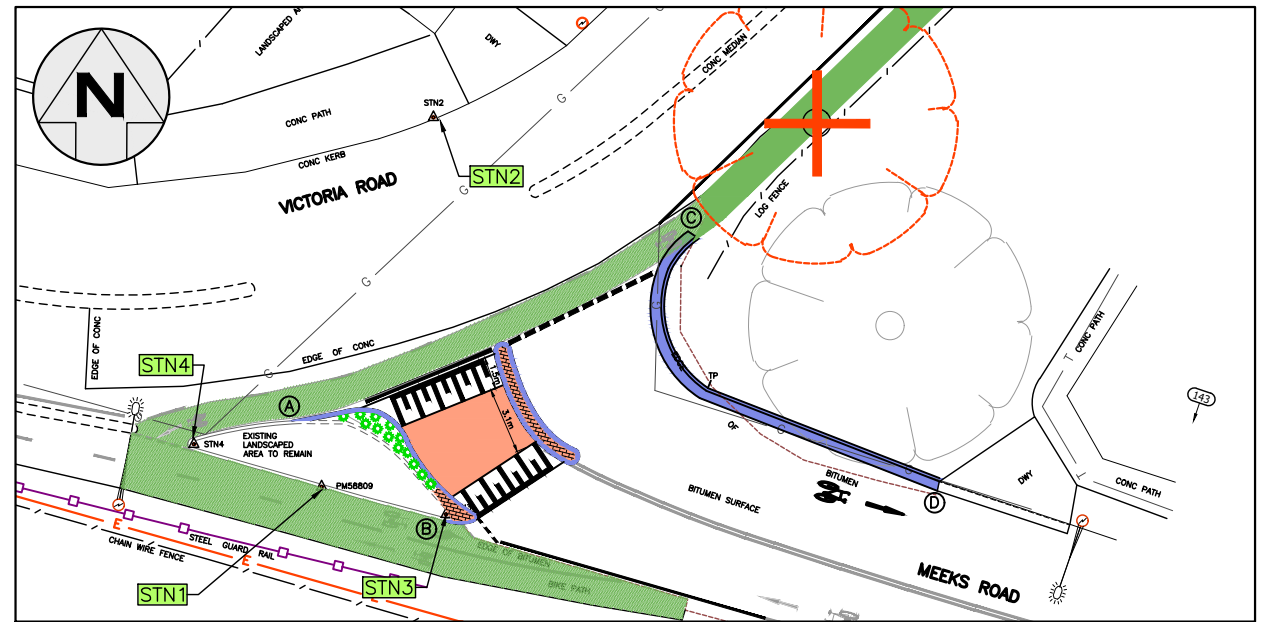

**SURVEY STATION PLAN**

NOT TO SCALE

FOR CONSTRUCTION

**SURVEY LEGEND**

**SYMBOLS**

- STATE SURVEY MARK
- PERMANENT SURVEY MARK
- SURVEY STATION
- DRILL HOLE & WING
- DRILLED HOLE
- SURVEY NAIL
- SIGN
- SLEIGHT COP
- COLUMN
- BOLLARD
- HYDRANT
- POWER POLE
- LIGHT POLE
- ELECTRICITY & LIGHT POLE
- ELECTRICITY PILLAR
- PHONE BOOTH
- MAIL BOX
- TELECOMM. SERVICE COVER
- TELECOMMUNICATION PILLAR
- RUBBISH BIN
- MANHOLE (STORMWATER/SEWER)
- MANHOLE (TRIANGULAR/SQUARE)
- WATER STOP VALVE
- WATER METER
- GAS VALVE
- OPTUS PIT / RMS PIT
- PARKING METER
- UNKNOWN SERVICE COVER
- SEWER LAMP HOLE
- TRAFFIC LIGHT BOX
- TRAFFIC LIGHTS
- TREES / SHRUB

**EXISTING SERVICES**

- DRAINAGE LINE
- ELECTRICITY
- GAS
- OIL PIPELINE
- SEWER
- TELECOM
- WATER
- OPTIC FIBER
- SUBSOIL
- NBN
- OPTUS
- OVERHEAD ELEC.
- O'HD ELEC & TEL
- UNKNOWN

<p>CHECKED &amp; APPROVED</p> <p>APPROVED FOR CONSTRUCTION</p>	<p>SURVEYED BY ADAM DILLON 08-11-24</p> <p>DESIGNED BY PIERRE AYOUB JANUARY 2024</p> <p>DRAWN BY PIERRE AYOUB JANUARY 2024</p>	<p><b>INNER WEST</b></p> <p>2-14 FISHER STREET, PETERSHAM NSW 2049 Ph. 02 9392 5000 Post: PO Box 14 PETERSHAM council@innerwest.nsw.gov.au Web: https://www.innerwest.nsw.gov.au</p>	<p>SURV. GEN. R.M.S. A.G.L. / SHELL PIPELINES SYDNEY WATER TELSTRA / OPTUS AUSGRID NOTICE OF ENTRY KERB &amp; GUTTER</p> <p>NOTICES DATE</p>	<p>COORDINATE SYSTEM GDA2020</p> <p>SCALES (ORIGINAL A1) 1:100</p>	<p>MEEKS ROAD, MARRICKVILLE AT VICTORIA ROAD PROPOSED INTERSECTION IMPROVEMENTS NOTES &amp; SCHEDULES</p>	<p>PROJECT NO. 303291 SHEET NO. 2 of 7</p> <p>PLAN NO. 10268</p> <p>SHEET REV #</p>
--	--	--	--	--	---	---

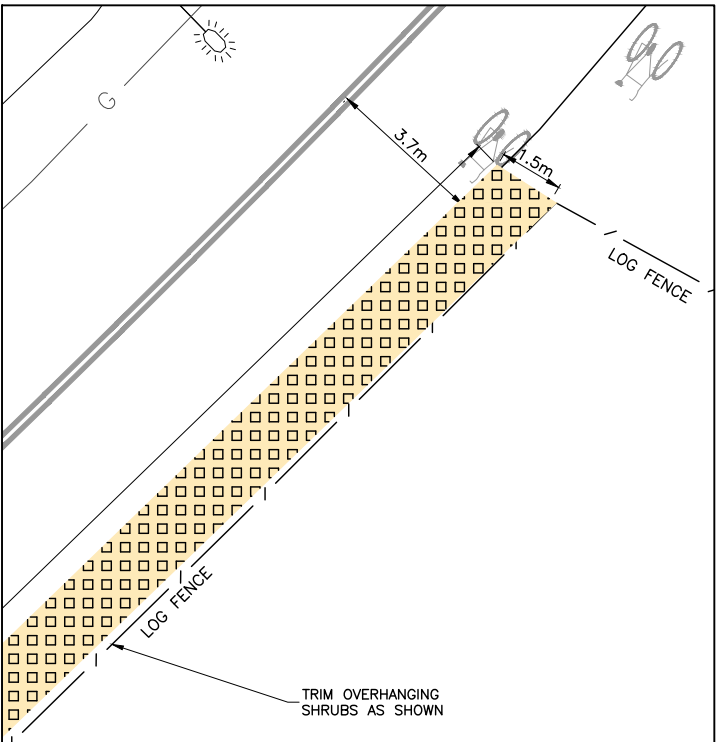
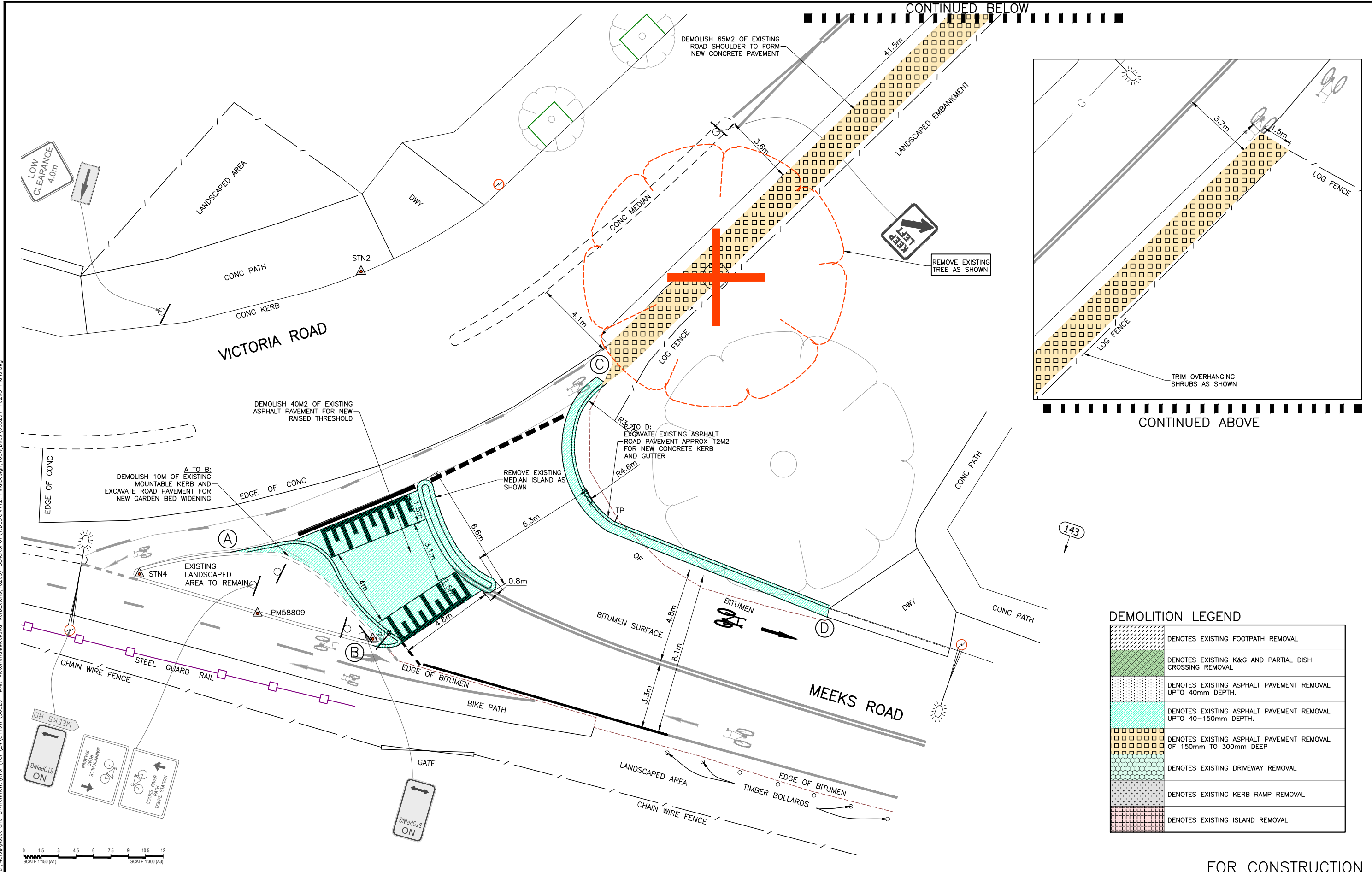

**DEMOLITION LEGEND**

	DENOTES EXISTING FOOTPATH REMOVAL
	DENOTES EXISTING K&G AND PARTIAL DISH CROSSING REMOVAL
	DENOTES EXISTING ASPHALT PAVEMENT REMOVAL UPTO 40mm DEPTH.
	DENOTES EXISTING ASPHALT PAVEMENT REMOVAL UPTO 40-150mm DEPTH.
	DENOTES EXISTING ASPHALT PAVEMENT REMOVAL OF 150mm TO 300mm DEEP
	DENOTES EXISTING DRIVEWAY REMOVAL
	DENOTES EXISTING KERB RAMP REMOVAL
	DENOTES EXISTING ISLAND REMOVAL

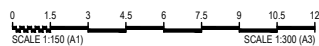

FOR CONSTRUCTION

CHECKED & APPROVED  APPROVED FOR CONSTRUCTION 	SURVEYED BY ADAM DILLON 08-11-24 DESIGNED BY PIERRE AYOUB JANUARY 2024 DRAWN BY PIERRE AYOUB JANUARY 2024	 <b>INNER WEST</b> 2-14 FISHER STREET, PETERSHAM NSW 2049 Ph: (02) 9392 5000 Post: PO Box 14 PETERSHAM council@innerwest.nsw.gov.au Web: https://www.innerwest.nsw.gov.au	 SURV. GEN. R.M.S. A.G.L. / SHELL PIPELINES SYDNEY WATER TELSTRA / OPTUS AUSGRID NOTICE OF ENTRY KERB & GUTTER NOTICES	COORDINATE SYSTEM GDA2020 SCALES (ORIGINAL A1) <b>1:100</b>	MEEKS ROAD, MARRICKVILLE AT VICTORIA ROAD PROPOSED INTERSECTION IMPROVEMENTS DEMOLITION	PROJECT NO. 303291	SHEET NO. 3 of 7
						PLAN NO. <b>10268</b>	SHEET REV # ---

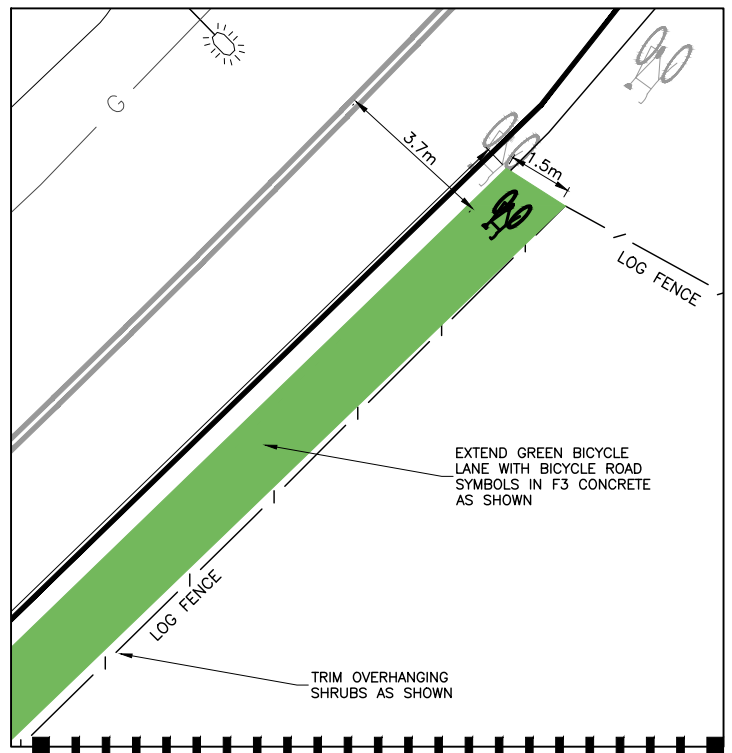
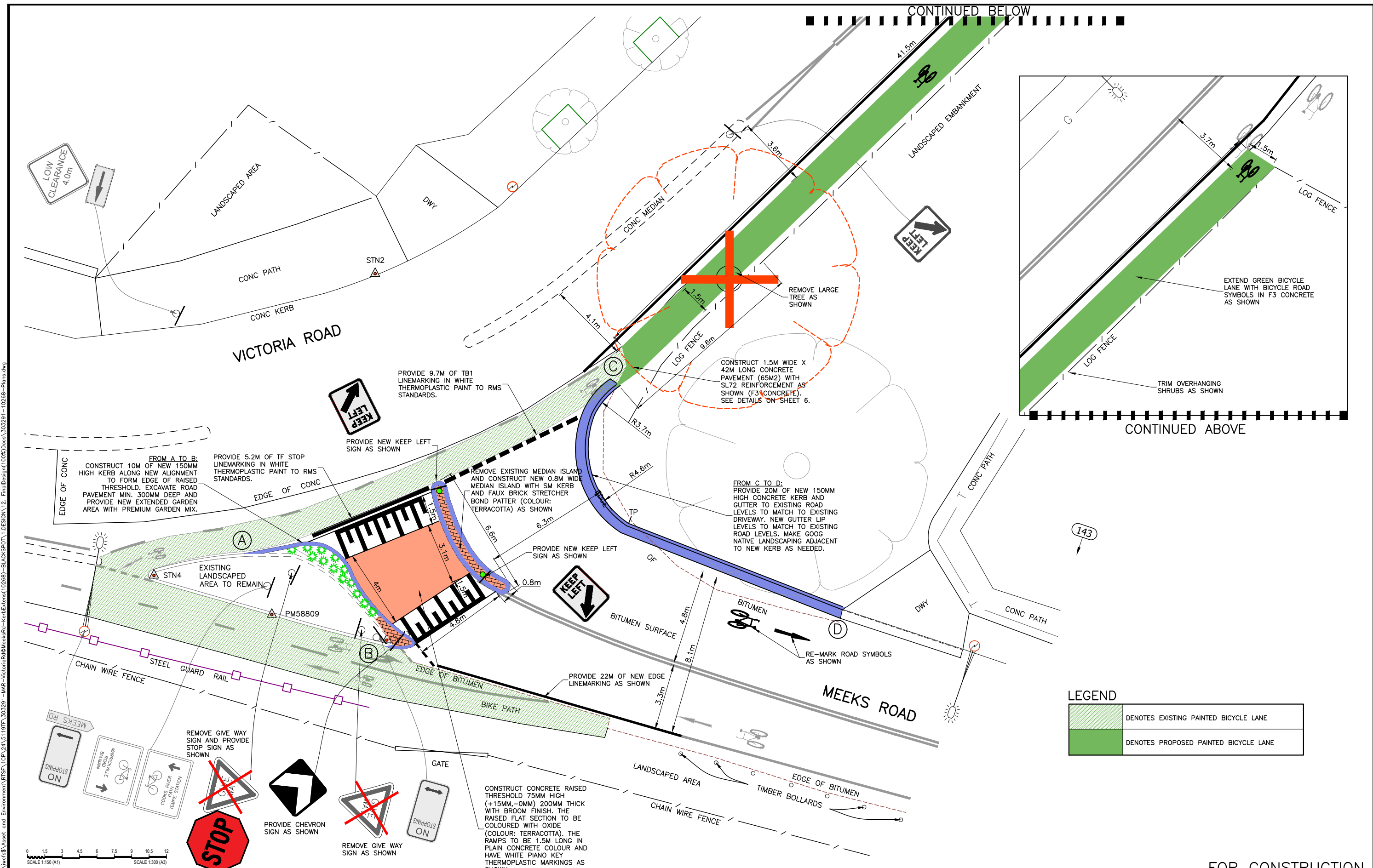

**LEGEND**

	DENOTES EXISTING PAINTED BICYCLE LANE
	DENOTES PROPOSED PAINTED BICYCLE LANE

FOR CONSTRUCTION

CHECKED & APPROVED  
  
 SURVEYED BY  
 ADAM DILLON  
 08-11-24  
 DESIGNED BY  
 PIERRE AYOUB  
 JANUARY 2024  
 DRAWN BY  
 PIERRE AYOUB  
 JANUARY 2024

**INNER WEST**  
 2-14 FISHER STREET, PETERSHAM NSW 2049  
 Ph: 02 9392 5000  
 Post: PO Box 14 PETERSHAM  
 council@innerwest.nsw.gov.au  
 Web: https://www.innerwest.nsw.gov.au

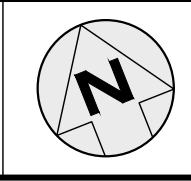

SURV. GEN.  
 R.M.S.  
 A.G.L. / SHELL PIPELINES  
 SYDNEY WATER  
 TELSTRA / OPTUS  
 AUSGRID  
 NOTICE OF ENTRY  
 KERB & GUTTER  
 NOTICES  
 DATE

COORDINATE SYSTEM  
 GDA2020 LINE  
 SCALES (ORIGINAL A1)  
 1:100

REV.	DATE	DESCRIPTION	APPROV.

**MEEKS ROAD, MARRICKVILLE**  
 AT VICTORIA ROAD  
 PROPOSED INTERSECTION IMPROVEMENTS  
 GENERAL LAYOUT AND SIGNS & LINEMARKING

PROJECT NO. 303291  
 SHEET NO. 4 of 7  
 PLAN NO. 10268  
 SHEET REV #

\\ve-file02\innerwest.nsw.gov.au\vefiles\Asset and Environment\RTSEA\CPN\24\51197F\303291-MR-VictoriaRd@MeeksRd-KerbExtV12-10268-Plans.dwg  
 12/01/2024 11:19:17 AM  
 1:100 (A1)  
 1:300 (A3)

CONSTRUCT CONCRETE RAISED THRESHOLD 75MM HIGH (+15MM, -0MM), 200MM THICK WITH BROOM FINISH. THE RAISED FLAT SECTION TO BE COLOURED WITH OXIDE (COLOUR: TERRACOTTA). THE RAMPS TO BE 1.5M LONG IN PLAIN CONCRETE COLOUR AND HAVE WHITE PIANO KEY THERMOPLASTIC MARKINGS AS SHOWN.

SUPPLY AND INSTALL NEW KEEP LEFT SIGN ON SHORT STEM FACING APPROACHING TRAFFIC.



CONSTRUCT NEW 0.8M WIDE MEDIAN ISLAND WITH SM KERB AND FAUX BRICK STRETCHER BOND PATTERN (COLOUR: TERRACOTTA) AS SHOWN.

SUPPLY AND INSTALL NEW KEEP LEFT SIGN ON SHORT STEM FACING APPROACHING TRAFFIC.



SUPPLY AND INSTALL NEW CHEVRON SIGN ON SHORT STEM IN 100MM THICK CONCRETE FAUX BRICK STRETCHER BOND PATTERN (COLOUR: TERRACOTTA) FACING APPROACHING TRAFFIC.



DETAIL 1  
SCALE 1:50

PROVIDE CARPOBROTUS GLAUDESCENS (PIG FACE) AT 500MM SPACINGS. 13 PLANTS IN THE EXTENDED AREA.

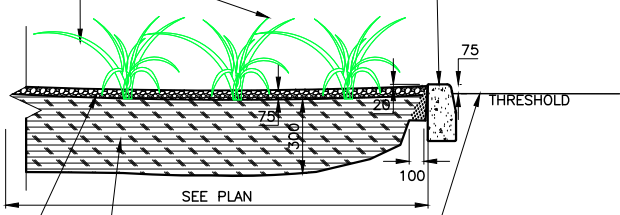

25 MPa CONCRETE KERB ONLY (ASPHALT ROADS), PAINTED WITH WHITE REFLECTIVE PAINT AS PER RMS SPECIFICATIONS.

75mm THICK FOREST FINES 15mm SOFT MUCK (RECEIVED 20mm FROM TOK)

SECTION C-C  
SCALE: 1:20

CONSTRUCT 75mm HIGH RAISED THRESHOLD (F<sub>c</sub>' 40MPa AT 28 DAYS & 200mm THICK WITH SL82 MESH PLACED CENTRALLY). RAISED FLAT TOP SECTION TO BE COLOURED WITH OXIDE (TERRACOTTA) WITH BROOM FINISH.

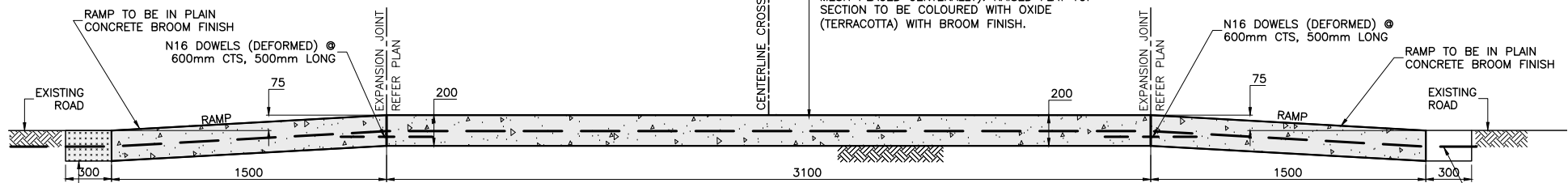

SECTION A-A  
SCALE 1:20

25 MPa CONCRETE KERB ONLY (TYPICAL) PAINTED WITH WHITE REFLECTIVE PAINT AS PER RMS SPECIFICATIONS. REFER TO KERB ONLY DETAIL (ASHPALT ROADS)

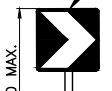

SUPPLY AND INSTALL CHEVRON SIGN (D4-1-2A) ON SHORT STEM USING V-LOCKS.

CONSTRUCT 75mm HIGH RAISED THRESHOLD (F<sub>c</sub>' 40MPa AT 28 DAYS & 200mm THICK WITH SL82 MESH PLACED CENTRALLY). RAISED FLAT TOP SECTION TO BE COLOURED WITH OXIDE (TERRACOTTA) WITH BROOM FINISH. RAMPS TO BE IN PLAIN CONCRETE.

SUPPLY AND INSTALL "KEEP LEFT" SIGN R2-3A(L)

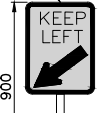

150mm THICK SLAB WITH STAMPED TERRACOTTA COLOUR FAUX BRICK FINISH IN RUNNING STRETCHER PATTERN. FAUX BRICK FINISH TO STOP AT BACK OF BARRIER KERB.

25 MPa CONCRETE SM KERB (TYPICAL) PAINTED WITH WHITE REFLECTIVE PAINT AS PER RMS SPECIFICATIONS.

V-LOCKS TO BE EMBEDDED IN ROAD PAVEMENT. MAKE TOP FLUSH WITH FINISHED ISLAND SURFACE.

150mm THICK SLAB WITH STAMPED TERRACOTTA COLOUR FAUX BRICK FINISH IN RUNNING STRETCHER PATTERN. FAUX BRICK FINISH TO STOP AT BACK OF BARRIER KERB.

EXISTING ROAD SURFACE

V-LOCKS TO BE EMBEDDED IN ROAD PAVEMENT. MAKE TOP FLUSH WITH FINISHED ISLAND SURFACE.

APPROVED 200 EXISTING ROAD BASE OR 150 2% LIME [OR 3% CEMENT] DGB20. PROVIDE GEOCOMPOSITE ON SOFT SUBGRADE

SECTION B-B  
SCALE 1:20

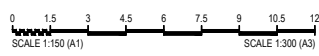

FOR CONSTRUCTION

CHECKED & APPROVED  9/1/24	SURVEYED BY ADAM DILLON 08-11-24	<b>INNER WEST</b> 2-14 FISHER STREET, PETERSHAM NSW 2049 Ph. 02 9392 5000 Post: PO Box 14 PETERSHAM council@innerwest.nsw.gov.au Web: https://www.innerwest.nsw.gov.au	SURV. GEN. R.M.S. A.G.L. / SHELL PIPELINES SYDNEY WATER TELSTRA / OPTUS AUSGRD NOTICE OF ENTRY KERB & GUTTER NOTICES DATE	COORDINATE SYSTEM GDA2020 SCALES (ORIGINAL A1) 1:100	REV. DATE DESCRIPTION APPROV.	MEEKS ROAD, MARRICKVILLE AT VICTORIA ROAD PROPOSED INTERSECTION IMPROVEMENTS DETAILS		PROJECT NO. 303291	SHEET NO. 5 of 7
						APPROVED FOR CONSTRUCTION 		PLAN NO. 10268	SHEET REV # ---

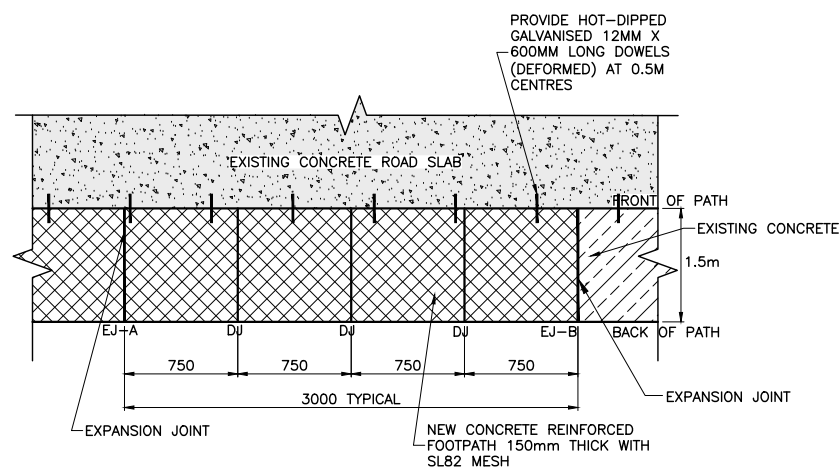

**REINFORCED CONCRETE FOOTPATH (F3)**  
SCALE 1:20

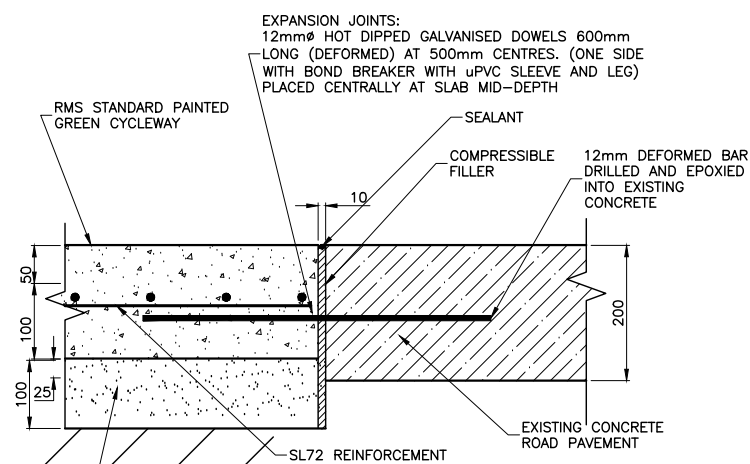

**F3 PATH AND CONCRETE ROAD INTERFACE**  
SCALE 1:5

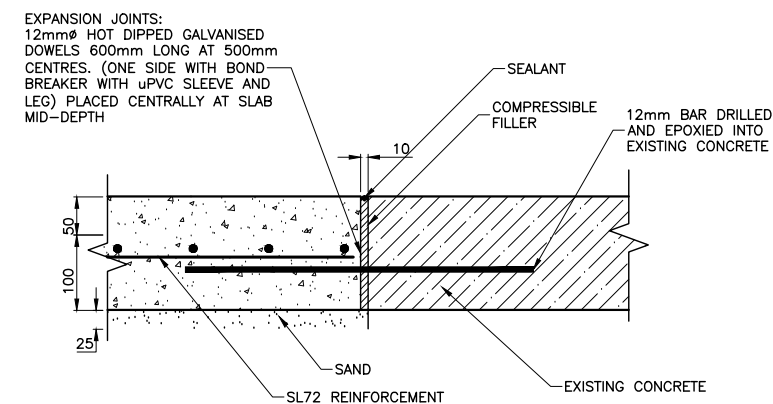

**EXPANSION JOINT B (EJ-B)**  
SCALE 1:5

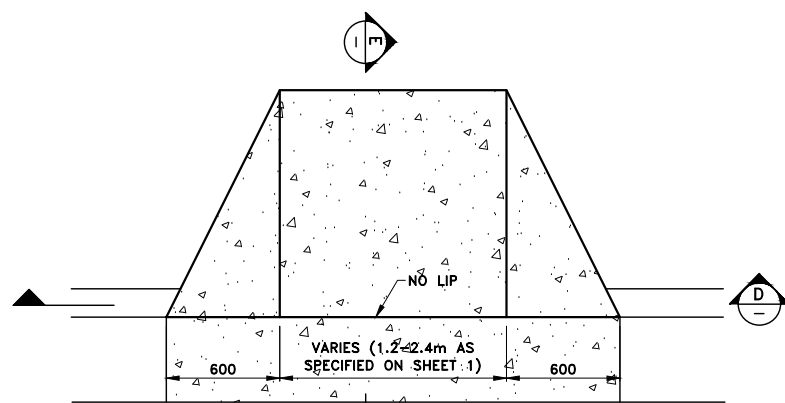

**KERB RAMP DETAIL (TYPICAL)**  
SCALE 1:20

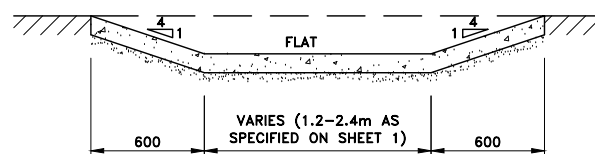

**SECTION D**  
SCALE 1:20

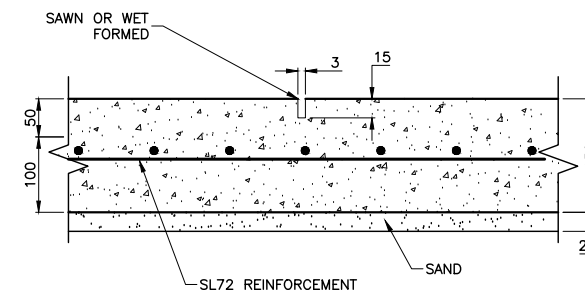

**DUMMY JOINT (DJ)**  
1.5m SPACING  
SCALE 1:10

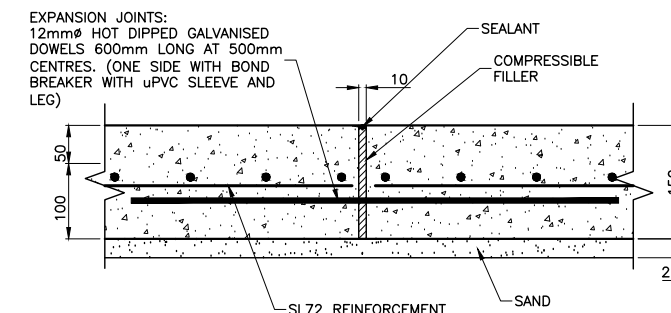

**EXPANSION JOINT A (EJ-A)**  
MAX. 10.0m SPACING  
SCALE 1:10

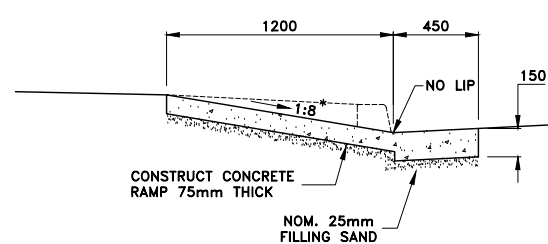

**SECTION E**  
SCALE 1:20

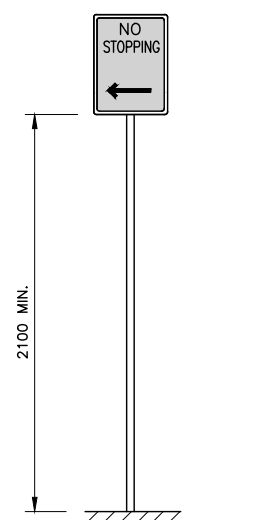

**TYPICAL SIGN HEIGHT (STANDARD STEM)**  
SCALE 1:20

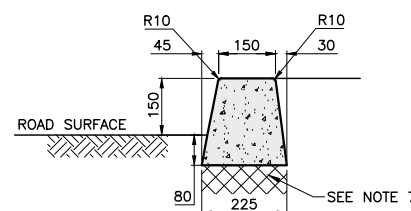

**TYPICAL SM KERB DETAIL (ASPHALT ROADS)**  
SCALE 1:20 @ A3

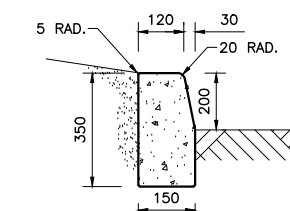

**TYPICAL KERB DETAIL**  
SCALE 1:10

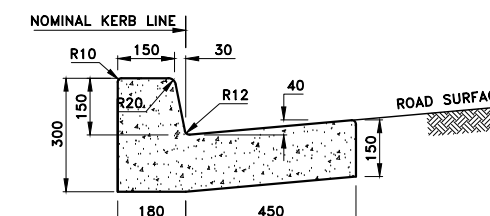

**150mm INTEGRAL KERB & GUTTER**  
SCALE 1:10

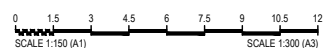

FOR CONSTRUCTION

CHECKED & APPROVED  9/1/24	SURVEYED BY ADAM DILLON 08-11-24	<b>INNER WEST</b> 2-14 FISHER STREET, PETERSHAM NSW 2049 Ph. 02 9392 5000 Post: PO Box 14 PETERSHAM council@innerwest.nsw.gov.au Web: https://www.innerwest.nsw.gov.au	SURV. GEN. R.M.S.	COORDINATE SYSTEM GDA2020	<b>MEEKS ROAD, MARRICKVILLE</b> AT VICTORIA ROAD PROPOSED INTERSECTION IMPROVEMENTS DETAILS 2	PROJECT NO. 303291	SHEET NO. 6 of 7
	DESIGNED BY PIERRE AYOUB JANUARY 2024		A.G.L. / SHELL PIPELINES SYDNEY WATER TELSTRA / OPTUS AUSGRD NOTICE OF ENTRY KERB & GUTTER NOTICES DATE	SCALES (ORIGINAL A1) <b>1:100</b>		PLAN NO. <b>10268</b>	SHEET REV # -----

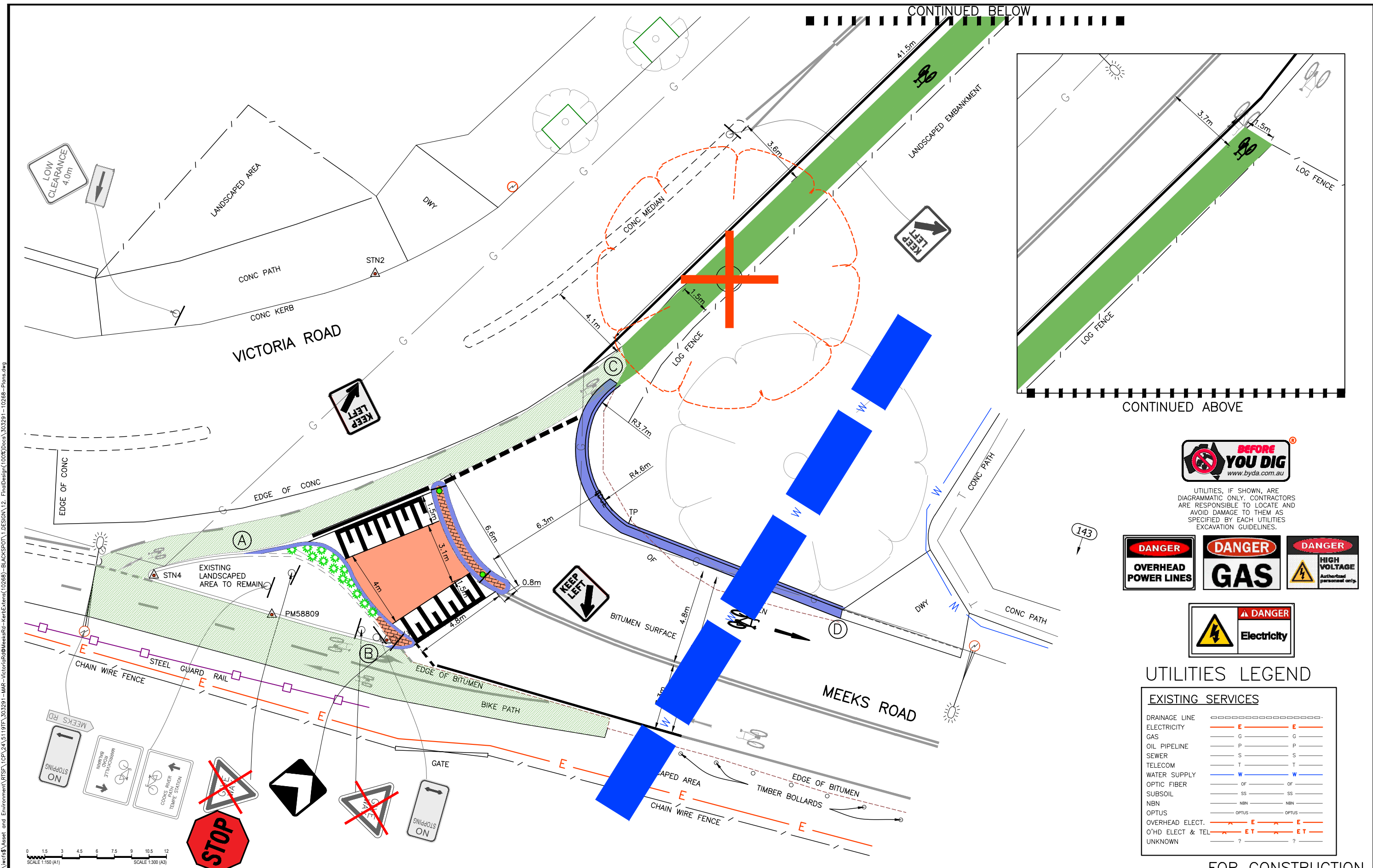

UTILITIES, IF SHOWN, ARE DIAGRAMMATIC ONLY. CONTRACTORS ARE RESPONSIBLE TO LOCATE AND AVOID DAMAGE TO THEM AS SPECIFIED BY EACH UTILITIES EXCAVATION GUIDELINES.



UTILITIES LEGEND

EXISTING SERVICES	
DRAINAGE LINE	-----
ELECTRICITY	— E — E —
GAS	— G — G —
OIL PIPELINE	— P — P —
SEWER	— S — S —
TELECOM	— T — T —
WATER SUPPLY	— W — W —
OPTIC FIBER	— OF — OF —
SUBSOIL	— SS — SS —
NBN	— NBN — NBN —
OPTUS	— OPTUS — OPTUS —
OVERHEAD ELECT.	— E — E —
O'HD ELECT & TEL	— ET — ET —
UNKNOWN	— ? — ? —

FOR CONSTRUCTION

CHECKED & APPROVED:

SURVEYED BY: ADAM DILLON, 08-11-24

DESIGNED BY: PIERRE AYOUB, JANUARY 2024

DRAWN BY: PIERRE AYOUB, JANUARY 2024

**INNER WEST**

2-14 FISHER STREET, PETERSHAM NSW 2049  
 Ph: 02 9392 5000  
 Post: PO Box 14 PETERSHAM  
 e: council@innerwest.nsw.gov.au  
 Web: https://www.innerwest.nsw.gov.au

SURV. GEN.		COORDINATE SYSTEM	
R.M.S.		GDA2020	
A.G.L. / SHELL PIPELINES		SCALES (ORIGINAL A1)	
SYDNEY WATER		1:100	
TELSTRA / OPTUS			
AUSGRID			
NOTICE OF ENTRY			
KERB & GUTTER			
NOTICES			
DATE		REV.	DATE DESCRIPTION APPROV.

**MEEKS ROAD, MARRICKVILLE**

AT VICTORIA ROAD

PROPOSED INTERSECTION IMPROVEMENTS

UTILITIES

PROJECT NO. 303291 SHEET NO. 7 of 7

PLAN NO. 10268

SHEET REV #