

STEP IRON PLACEMENT DIAGRAM
NOT TO SCALE

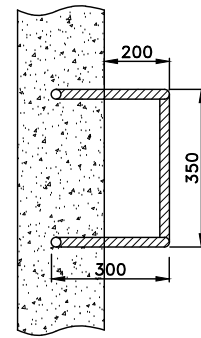

TOP VIEW
NOT TO SCALE

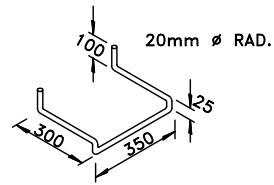

3D VIEW
NOT TO SCALE

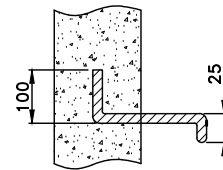

SIDE ELEVATION
NOT TO SCALE

DRAINAGE NOTES 2:

1. PITS DEEPER THAN 1.0m SHALL BE FITTED WITH STEP IRONS.
2. STEP IRONS SHOULD ONLY BE USED WHERE THE VERTICAL WALL HEIGHT DOES NOT EXCEED 6m.
3. STEP IRONS SHALL BE LOCATED:
 - DIRECTLY ON A WALL WITHOUT PIPE OPENINGS.
 - DESIRABLY ON ONE OF THE LONG SIDES OF THE PIT.
 - DIRECTLY BELOW THE OPENING OF THE COVER.
4. STEP IRONS SHALL BE OF MATERIAL GIVING EQUIVALENT PERFORMANCE TO 24mm DIAMETER SOLID LOW-CARBON STEEL AND SHALL HAVE A TREAD DEPTH OF NOT LESS THAN 24mm.
5. ALL BENDS TO BE FORMED AROUND 12mm ϕ PIN.
6. STEP IRONS SHALL HAVE SHARP EDGES ROUNDED AND HOT DIP GALVANISED AFTER FABRICATION.
7. MATERIAL FOR STEP IRONS SHALL BE STRUCTURAL GRADE 250 TO AS3679
8. ALL DIMENSIONS ARE IN MILLIMETRES UNLESS OTHERWISE SHOWN.

(ORIGINAL = A3 SHEET)

CHECKED & APPROVED	SURVEYED & DRAFTED	QUANTITIES	SERVICES AFFECTED	S.R.A. / SURV. GEN.	SERVICES TELECOM/OPTUS —T—T—T—T— GAS —G—G—G—G— SEWER —S—S—S—S— WATER —W—W—W—W— RAILWAY —R—R—R—R— ELEC. CABLES —E—E—E—E— OIL PIPELINES —P—P—P—P— STORM WATER —SW—SW—SW—	DATUM	INNER WEST COUNCIL STANDARD DRAINAGE DRAWING – D6 STEP IRON DETAILS	FILE NO.	SHEET NO.
	DESIGNED PG/DJT MAY 2019			A.G.L. / SHELL PIPELINES		A. H. D.		PLAN NO.	
APPROVED FOR CONSTRUCTION	DRAWN PG/DJT MAY 2019		NOTICES	DATE	NTS	D6			
				AMEND DATE	DESCRIPTION	APPROV.	VERSION	V1	